

THIS DRAWING CONTAINS INFORMATION PROPRIETARY TO RF INDUSTRIES.  
 ANY UNAUTHORIZED USE OF THIS DRAWING IS EXPRESSLY PROHIBITED  
 WITHOUT WRITTEN PERMISSION FROM RF INDUSTRIES.  
 ANY VIOLATION IS PUNISHABLE UNDER U.S. COPYRIGHT LAWS.

ALL DIMENSIONS ARE REFERENCE ONLY

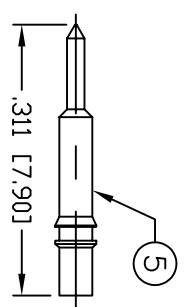

PIN TO BE SOLDER  
 IF CRIMPING, USE RFA-4089

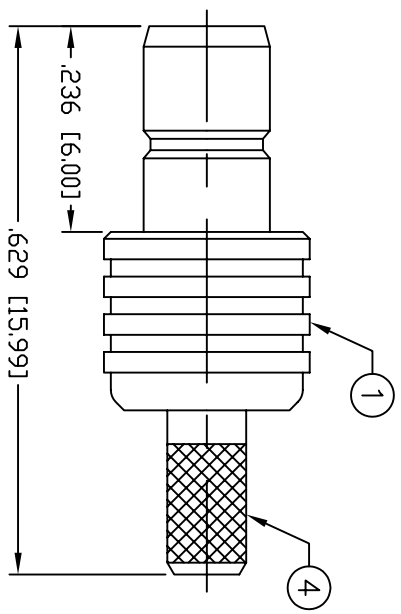
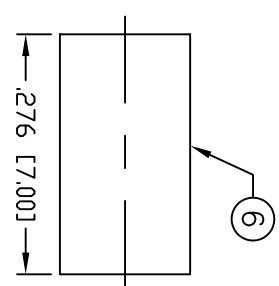

RECOMMENDED CRIMP DIE: 130'

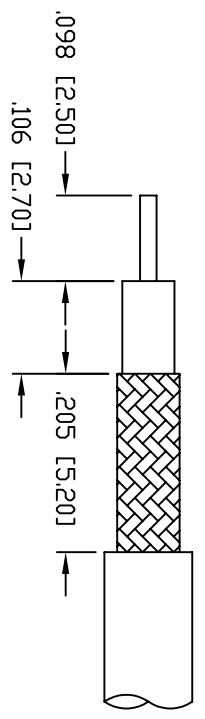
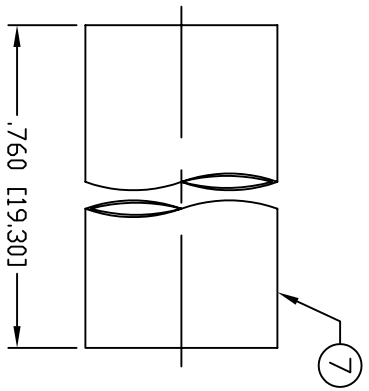

RECOMMENDED STRIPPING DIMENSIONS

**SPECIFICATIONS:**

IMPEDANCE: 50 Ohms  
 FREQUENCY RANGE: 0-4 GHz  
 WORKING VOLTAGE: 335 V rms Max. @ Sea Level  
 VSWR MAX: 1.15  
 INSERTION LOSS(DB):  $0.03 \times \sqrt{f(\text{GHz})}$   
 CONTACT RESISTANCE:  $\leq 6 \text{ m Ohm}$   
 INSULATION RESISTANCE: 1k M Ohms min.  
 TEMPERATURE RANGE: -65°C TO 165°C  
 FOR RG-174, 188, 188A, 316/U, ALPHA 9174, 9316,  
 BELDEN 8216, 83269, 83284, 84316 & TIMES LMR-100A CABLE

#	DESCRIPTION	QTY	MATERIAL	FINISH	APPROVALS	DATE
1	BODY	1	BRASS	GOLD, 5μ"	000713	
2	INSULATOR	1	PTFE	---		
3	INSULATOR	1	PTFE	---		
4	FERRULE STUD	1	BRASS	GOLD, 5μ"		
5	PIN	1	BRASS	GOLD, 30μ"		
6	FERRULE	1	COPPER	GOLD, 5μ"		
7	TUBING	1	HEAT SHRINK	---		
8						
9						
10						
11						
12						
13						
14						

**ROHS COMPLIANT**

DIMENSIONS ARE IN INCHES  
 AND [MILLIMETERS]  
 UNLESS OTHERWISE NOTED  
 TOLERANCES ARE:  
 DECIMALS DIAMETER

**RF Connectors**  
 DIVISION OF RF INDUSTRIES, LTD.

**SMB JACK, CRIMP**

7610 MIRAMAR RD  
 SAN DIEGO, CA 92126  
 (858) 549-6340  
 (858) 549-6345 FAX

SIZE	CABLE GROUP	DWG NO.	REV
A	B	RSB-4050-1B	-

SCALE: NTS    CAD FILE OUTLINE    SHEET 1 OF 1

PART NO.		DESCRIPTION		DWN	DATE	APPROVED
RSB-4050-1B				CZS	08/28/07	JDMc
REV	ENGINEERING RELEASE					