

DTSK06-1-08SA ✓ ACTIVE

DEUTSCH | DEUTSCH DT, DEUTSCH DTHD

TE Internal #: DTSK06-1-08SA

Housing for Female Terminals, Wire-to-Wire, 1 Position, Sealable, Gray, Wire & Cable, Power, Cable Mount (Free-Hanging), Hybrid

[View on TE.com >](#)



Connectors > Automotive Connectors > Automotive Housings

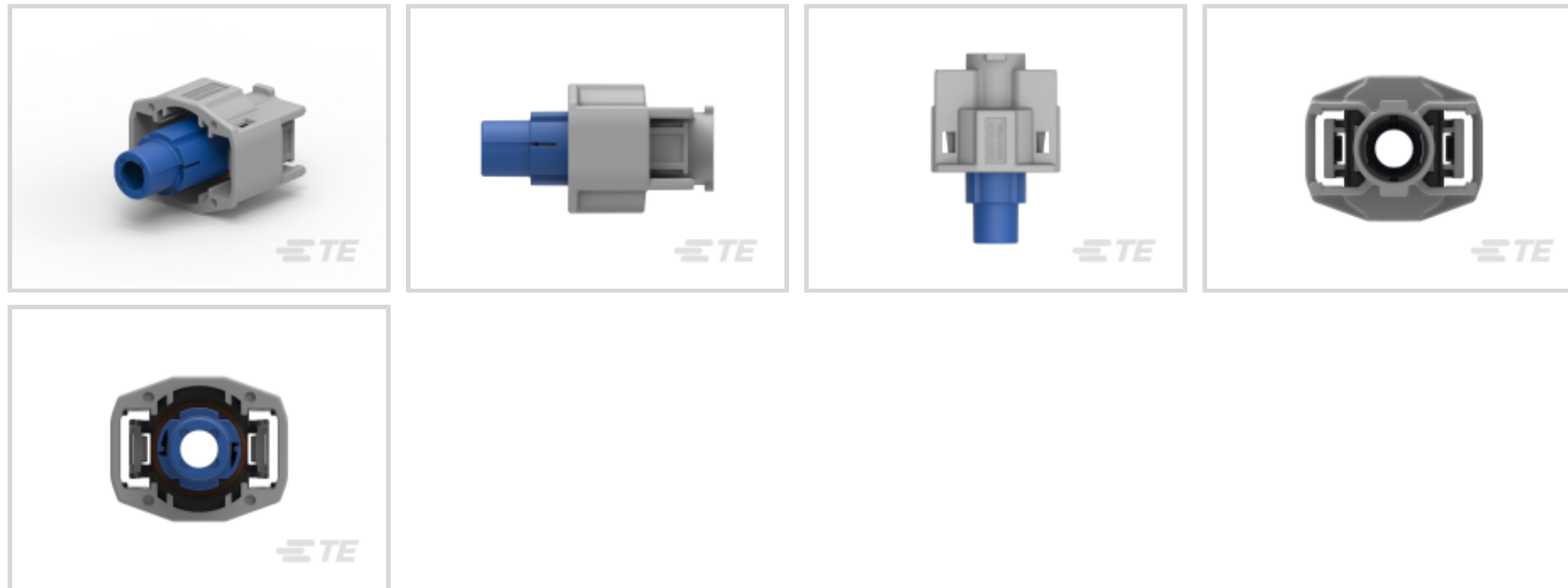

Connector System: **Wire-to-Wire**

Number of Positions: **1**

Connector & Housing Type: **Housing for Female Terminals**

Sealable: **Yes**

Mating Pin Diameter: **8 mm [.315 in]**

Features

Product Type Features

Mixed & Hybrid Connector	No
Connector Shape	Rectangular
Connector System	Wire-to-Wire
Connector & Housing Type	Housing for Female Terminals
Sealable	Yes
Connector & Contact Terminates To	Wire & Cable
Primary Locking Feature	Integrated in Housing

Configuration Features

Number of Positions	1
Number of Rows	0

Electrical Characteristics

Operating Voltage	250 VAC
Nominal Voltage Architecture	12 V, 24 V

Body Features



Cable Exit Angle	180°
Primary Product Color	Gray
Connector & Keying Code	A

Contact Features

Contact Size	Size 8
Contact Type	Socket
Mating Pin Diameter	8 mm[.315 in]
Contact Current Rating (Max)	150 A

Mechanical Attachment

Terminal Position Assurance	Yes
Strain Relief	Add By Accessory
Mating Alignment Type	Keyed
Mating Alignment	With
Connector Mounting Type	Cable Mount (Free-Hanging)

Housing Features

Housing Material	PA GF
------------------	-------

Dimensions

Connector Height	32.5 mm[1.28 in]
Product Width	39.6 mm[1.559 in]
Product Length	36.49 mm[1.437 in]
Compatible Insulation Diameter Range	8.17 – 9.66 mm, 9.49 – 10.52 mm, 10.59 – 11.59 mm[.322 – .38 in][.374 – .414 in][.417 – .456 in]

Usage Conditions

Operating Temperature (Max)	125 °C[257 °F]
Operating Temperature Range	-55 – 125 °C[-67 – 257 °F]

Operation/Application

Circuit Application	Power
---------------------	-------

Industry Standards

Degree of Protection	IP68, IP6K9K
UL Flammability Rating	Not tested

Packaging Features

--	--



Packaging Quantity	150
Packaging Method	Box

Other

Serviceable	Yes
Connector Position Assurance Capable	No

Product Compliance

[For compliance documentation, visit the product page on TE.com>](#)

EU RoHS Directive 2011/65/EU	Compliant
EU ELV Directive 2000/53/EC	Compliant
China RoHS 2 Directive MIIT Order No 32, 2016	No Restricted Materials Above Threshold
EU REACH Regulation (EC) No. 1907/2006	Current ECHA Candidate List: JUNE 2023 (235) Candidate List Declared Against: JUNE 2023 (235) SVHC > Threshold: Octamethylcyclotetrasiloxane (D4) (.5% in Component Part) Dodecamethylcyclohexasiloxane (D6) (.5% in Component Part) Decamethylcyclopentasiloxane (D5) (.5% in Component Part) Article Safe Usage Statements: Wash thoroughly after handling. Recycle if possible and dispose of the article by following all applicable governmental regulations relevant to your geographic location.
Halogen Content	Not Low Halogen - contains Br or Cl > 900 ppm.
Solder Process Capability	Not reviewed for solder process capability

Product Compliance Disclaimer

This information is provided based on reasonable inquiry of our suppliers and represents our current actual knowledge based on the information they provided. This information is subject to change. The part numbers that TE has identified as EU RoHS compliant have a maximum concentration of 0.1% by weight in homogenous materials for lead, hexavalent chromium, mercury, PBB, PBDE, DBP, BBP, DEHP, DIBP, and 0.01% for cadmium, or qualify for an exemption to these limits as defined in the Annexes of Directive 2011/65/EU (RoHS2). Finished electrical and electronic equipment products will be CE marked as required by Directive 2011/65/EU. Components may not be CE marked. Additionally, the part numbers that TE has identified as EU ELV compliant have a maximum concentration of 0.1% by weight in homogenous materials for lead, hexavalent chromium, and mercury, and 0.01% for cadmium, or qualify for an exemption to these limits as defined in the Annexes of Directive 2000/53/EC (ELV). Regarding the REACH Regulation, the information TE provides on SVHC in articles for this part number is based on the latest European Chemicals Agency (ECHA) 'Guidance on requirements for substances in articles' posted at this URL: <https://echa.europa.eu/guidance-documents/guidance-on-reach>

Compatible Parts



TE Part # SRK-SC-080-32-601
SOC, SOLID, SIZE M8, 32mm², AG



TE Part # 2289243-1
WS-35-001, SEAL, GRN, 10.59-11.59, DTSK



TE Part # DT-RT1
EXT TOOL, FRONT RELEASE



TE Part # DTSK04-1-08PA
RECEPTACLE, INLINE, KEY A



TE Part # SRK-SC-080-25-601
SOC, SOLID, SIZE M8, 25mm², AG



TE Part # SRK-SC-080-35-601
SOC, SOLID, SIZE M8, 35mm², AG



TE Part # 2289241-1
WS-25-001, SEAL, BLU, 8.17-9.66, DTSK



TE Part # 2289242-1
WS-32-001, SEAL, RED, 9.49-10.52, DTSK

Also in the Series | DEUTSCH DT



Automotive Connector Caps & Covers (19)

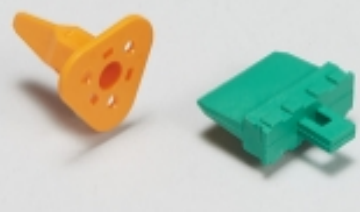

Automotive Connector Locks & Position Assurance (74)



Automotive Housings (620)



Connector Backshells (58)



Connector Seals & Cavity Plugs (6)



Connector Strain Relief (28)



Insertion & Extraction Tools (3)



Other Automotive Connector Accessories (27)



PCB Headers & Receptacles (103)

Also in the Series | DEUTSCH DTHD



Automotive Housings(22)



Other Automotive Connector Accessories(1)

Customers Also Bought



TE Part #W2SC-P012
WedgeLocks: DEUTSCH DT



TE Part #1062-16-0622
SOC, SF, SIZE 16, 16-20, NI/SN



TE Part #2232342-1
187 PL EX FLAG REC. 22-16AWG PTBR



TE Part #1011-229-0205
BKSHL, 2P, BLK, REC, ST, NW6/7.5/8.5 /10



TE Part #W2S-P070-Y
SEAL RETN WEDGE. ORANGE DT 2 W



TE Part #YHVA630-2PHM-4MM-A
HVA630-2pnm,4sqmm,Key A



TE Part #YHVA630-2PHM-6MM-A
HVA630-2pnm,6sqmm,Key A

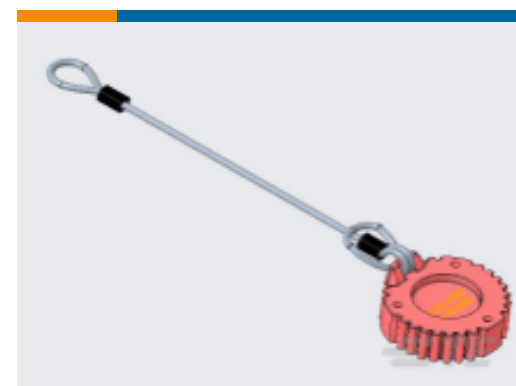

TE Part #HDC16-9-E004-L47N
DUST CAP, 9P, REC, BLK, LANYARD, HD10

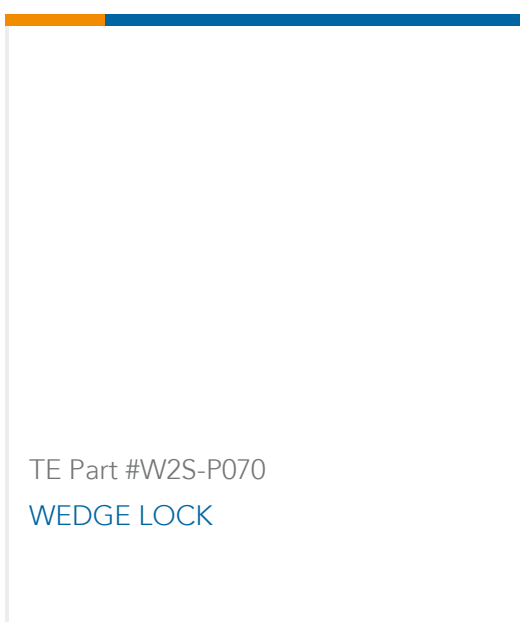

TE Part #W2S-P070
WEDGE LOCK

Documents

[Product Drawings](#)
[PLUG, INLINE, KEY A](#)

English

CAD Files

[3D PDF](#)

[3D](#)

[Customer View Model](#)

[ENG_CVM_CVM_DTSK06-1-08SA_C.2d_dxf.zip](#)



English

Customer View Model

[ENG_CVM_CVM_DTSK06-1-08SA_C.3d_igs.zip](#)

English

Customer View Model

[ENG_CVM_CVM_DTSK06-1-08SA_C.3d_stp.zip](#)

English

By downloading the CAD file I accept and agree to the [Terms and Conditions](#) of use.

Datasheets & Catalog Pages

[DEUTSCH DTSK Connectors Series Brief](#)

English

[ICT Terminals and Connectors Catalogue](#)

English

[DEUTSCH DTSK Components Infographic](#)

English

Product Specifications

[Application Specification](#)

English