

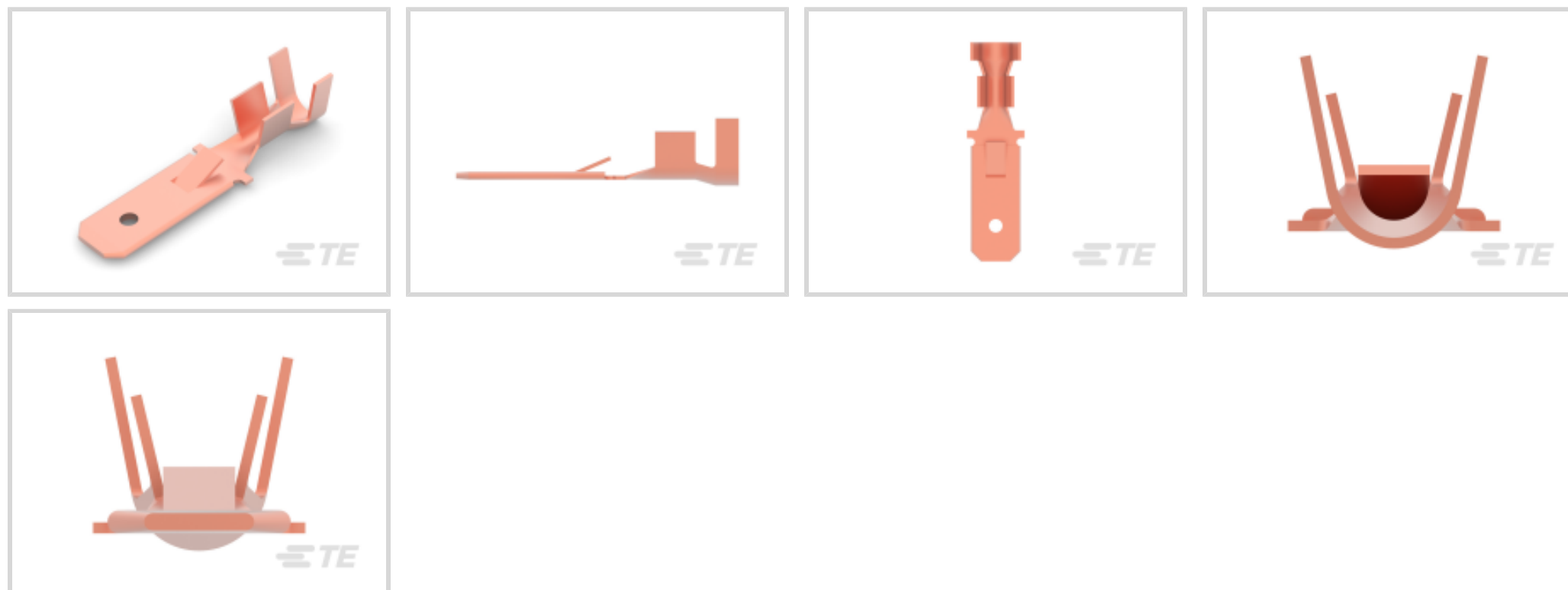

Terminals & Splices > Quick Disconnects



Quick Disconnect Terminal Type: **Tab**

Wire Size: **2.62 – 4.17 mm²**

Mating Tab Width: **6.35 mm [.25 in]**

Mating Tab Thickness: **.81 mm [.032 in]**

Features

Product Type Features

Insertion Force	Normal
-----------------	--------

Configuration Features

Compatible With Wire & Cable Type	Discrete Wire
-----------------------------------	---------------

Contact Features

Quick Disconnect Terminal Type	Tab
Mating Tab Width	6.35 mm [.25 in]
Mating Tab Thickness	.81 mm [.032 in]
Terminal Orientation	Straight
Contact Base Material	Phosphor Bronze
Terminal Plating Material	Unplated
Crimp Type	F-Crimp
Barrel Type	Open

Termination Features

Product Terminates To	Wire & Cable
-----------------------	--------------



Mechanical Attachment

Locking Lance Height	1.5 mm[.06 in]
Wire Insulation Support	With
Mating Retention Type	Locking Lance

Dimensions

Terminal Material Thickness	.41 mm[.016 in]
Product Length	28 mm[1.102 in]
Compatible Insulation Diameter Range	3.3 – 4.5 mm[.13 – .177 in]
Wire Size	2.62 – 4.17 mm ²

Usage Conditions

Insulation Option	Uninsulated
-------------------	-------------

Packaging Features

Packaging Quantity	3000
Packaging Method	Reel

Other

Terminals & Splices Comment	According to DIN 46343, Part 3, With locking hole.
-----------------------------	----------------------------------------------------

Product Compliance

[For compliance documentation, visit the product page on TE.com>](#)

EU RoHS Directive 2011/65/EU	Compliant
EU ELV Directive 2000/53/EC	Compliant
China RoHS 2 Directive MIIT Order No 32, 2016	No Restricted Materials Above Threshold
EU REACH Regulation (EC) No. 1907/2006	Current ECHA Candidate List: JUNE 2023 (235) Candidate List Declared Against: JUNE 2023 (235) Does not contain REACH SVHC
Halogen Content	Low Halogen - Br, Cl, F, I < 900 ppm per homogenous material. Also BFR/CFR/PVC Free
Solder Process Capability	Not applicable for solder process capability

Product Compliance Disclaimer

This information is provided based on reasonable inquiry of our suppliers and represents our current actual knowledge based on the information they provided. This information is subject to change. The part numbers that TE has identified as



EU RoHS compliant have a maximum concentration of 0.1% by weight in homogenous materials for lead, hexavalent chromium, mercury, PBB, PBDE, DBP, BBP, DEHP, DIBP, and 0.01% for cadmium, or qualify for an exemption to these limits as defined in the Annexes of Directive 2011/65/EU (RoHS2). Finished electrical and electronic equipment products will be CE marked as required by Directive 2011/65/EU. Components may not be CE marked. Additionally, the part numbers that TE has identified as EU ELV compliant have a maximum concentration of 0.1% by weight in homogenous materials for lead, hexavalent chromium, and mercury, and 0.01% for cadmium, or qualify for an exemption to these limits as defined in the Annexes of Directive 2000/53/EC (ELV). Regarding the REACH Regulation, the information TE provides on SVHC in articles for this part number is based on the latest European Chemicals Agency (ECHA) 'Guidance on requirements for substances in articles' posted at this URL: <https://echa.europa.eu/guidance-documents/guidance-on-reach>

Compatible Parts



TE Part # 1-1579007-4
EXTRACTION TOOL



TE Part # 4-1579007-3
EXTRACTION TOOL KIT



TE Part # 2-2150766-2
OC-PA-E-FA-140F210F-001-0056



TE Part # 2150766-2
OC-AT-E-FA-140F210F-001-0056



TE Part # 2837487-2
APPLICATOR TO MAKE LOOSE
PIECE TERMINALS



TE Part # 444153-4
.250 FASTIN-ON TAB



KIT
REPRESENTATION ONLY

TE Part # 7-2150766-7
OC-140F210F-CRIMP TOOLINGKIT

Also in the Series | FASTIN-FASTON 250

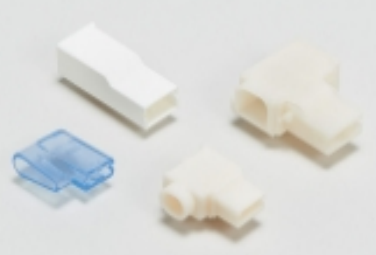

Crimp Terminal Housings(211)



Insertion & Extraction Tools(2)



PCB Terminals(2)



Quick Disconnects(254)

Customers Also Bought

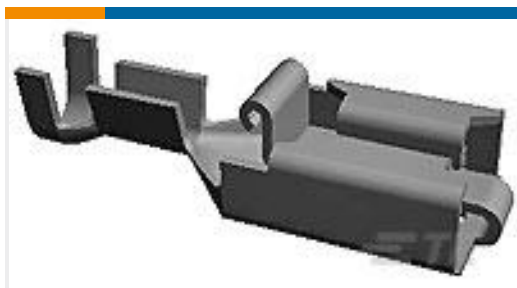

TE Part #170233-2
POSITIVE LOCK 250 REC 0.5-2.27
MM2 TPBR



TE Part #2141970-2
MCON 1.2 LL REC SWS AU



TE Part #1-1801178-4
3W RECEPTACLE HP CONNECTOR
YELLOW



TE Part #1-2109570-2
MCON 5P PLUG COVER TYPE-B BLK
YELLOW

TE Part #2330574-4
LEONI-X760 LWB 20MY AKII 90D
PIGTAIL

TE Part #2354915-1
X260 MY21 FAKRA CABLE ASSY

TE Part #2354916-1
X260 MY21 FAKRA CABLE ASSY

TE Part #2354919-1
X260 MY21 FAKRA CABLE ASSY

TE Part #2362474-1
HSL CABLE ASSY. A/A

TE Part #2384067-3
E2UB FAKRA AUTOMATED CABLE

Documents

Product Drawings

[FF 250 TAB 2.5-4.0 MM2 0.38 X 16.3](#)

English

CAD Files

Customer View Model

[ENG_CVM_CVM_928949-3_E.2d_dxf.zip](#)

English

3D PDF

3D

Customer View Model

[ENG_CVM_CVM_928949-3_E.3d_igs.zip](#)

English

Customer View Model

[ENG_CVM_CVM_928949-3_E.3d_stp.zip](#)

English

By downloading the CAD file I accept and agree to the [Terms and Conditions](#) of use.

Product Specifications



[Application Specification](#)

English

[FASTIN-FASTON 110, 187, 205 And 312 Series Receptacle Contacts](#)

English

[Product Environmental Compliance](#)

[TE Material Declaration](#)

English