

583617-1 ✓ ACTIVE

## AMP-LEAF

TE Internal #: 583617-1

Housing, Receptacle, Wire-to-Board, 22 Position, .156 in [3.96 mm]

Centerline, Crimp, 2 Row, Black, Printed Circuit Board, Power &

Signal, Board Mount

[View on TE.com >](#)



Connectors > PCB Connectors > Wire-to-Board Connectors > Wire-to-Board Connector Assemblies & Housings

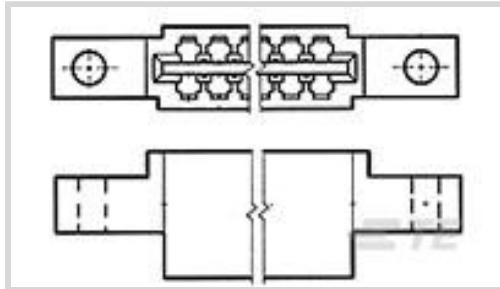

Connector Product Type: **Housing**

Connector & Housing Type: **Receptacle**

Connector System: **Wire-to-Board**

Number of Positions: **22**

Centerline (Pitch): **3.96 mm [ .156 in ]**

### Features

#### Product Type Features

Connector Product Type	Housing
Connector & Housing Type	Receptacle
Connector System	Wire-to-Board
Connector & Contact Terminates To	Printed Circuit Board

#### Configuration Features

Number of Dual Positions	22
Number of Positions	22
Number of Rows	2

#### Electrical Characteristics

Dielectric Withstanding Voltage (Max)	1800 VAC
Insulation Resistance	1000 MΩ
Operating Voltage	250 VAC

#### Body Features

Primary Product Color	Black
-----------------------	-------

#### Contact Features

Contact Base Material	Phosphor Bronze
Contact Current Rating (Max)	5 A

#### Termination Features



Termination Method to Wire & Cable	Crimp
------------------------------------	-------

### Mechanical Attachment

Panel Mount Feature	Without
---------------------	---------

PCB Mount Retention	Without
---------------------	---------

Panel Mount Feature Type	Mounting Ears
--------------------------	---------------

Mating Retention	Without
------------------	---------

Connector Mounting Type	Board Mount
-------------------------	-------------

### Housing Features

Housing Material	Polyester GF
------------------	--------------

Centerline (Pitch)	3.96 mm [.156 in]
--------------------	-------------------

### Dimensions

	.7 in
--	-------

PCB Thickness (Recommended)	1.4 – 1.78 mm [.055 – .07 in]
-----------------------------	-------------------------------

Row-to-Row Spacing	4.14 mm [.163 in]
--------------------	-------------------

### Usage Conditions

Operating Temperature Range	-55 – 105 °C [-67 – 221 °F]
-----------------------------	-----------------------------

### Operation/Application

Circuit Application	Power & Signal
---------------------	----------------

### Industry Standards

UL Flammability Rating	UL 94V-0
------------------------	----------

### Packaging Features

Packaging Quantity	40
--------------------	----

Packaging Method	Box
------------------	-----

### Other

Discrete Wire Connector Comment	3.18 [.125] hole diameter.
---------------------------------	----------------------------

### Product Compliance

For compliance documentation, visit the product page on [TE.com](https://www.te.com)>

EU RoHS Directive 2011/65/EU	Compliant
------------------------------	-----------

EU ELV Directive 2000/53/EC	Compliant
-----------------------------	-----------

China RoHS 2 Directive MIIT Order No 32, 2016	No Restricted Materials Above Threshold
---	---



EU REACH Regulation (EC) No. 1907/2006

Current ECHA Candidate List: JUNE 2023 (235)

Candidate List Declared Against: JUNE 2023 (235)

Does not contain REACH SVHC

Halogen Content

Not Low Halogen - contains Br or Cl > 900 ppm.

Solder Process Capability

Not applicable for solder process capability

Product Compliance Disclaimer

This information is provided based on reasonable inquiry of our suppliers and represents our current actual knowledge based on the information they provided. This information is subject to change. The part numbers that TE has identified as EU RoHS compliant have a maximum concentration of 0.1% by weight in homogenous materials for lead, hexavalent chromium, mercury, PBB, PBDE, DBP, BBP, DEHP, DIBP, and 0.01% for cadmium, or qualify for an exemption to these limits as defined in the Annexes of Directive 2011/65/EU (RoHS2). Finished electrical and electronic equipment products will be CE marked as required by Directive 2011/65/EU. Components may not be CE marked. Additionally, the part numbers that TE has identified as EU ELV compliant have a maximum concentration of 0.1% by weight in homogenous materials for lead, hexavalent chromium, and mercury, and 0.01% for cadmium, or qualify for an exemption to these limits as defined in the Annexes of Directive 2000/53/EC (ELV). Regarding the REACH Regulation, the information TE provides on SVHC in articles for this part number is based on the latest European Chemicals Agency (ECHA) 'Guidance on requirements for substances in articles' posted at this URL: <https://echa.europa.eu/guidance-documents/guidance-on-reach>

### Compatible Parts



### Customers Also Bought





TE Part #204505-1  
AMPLIMITE,ASY,PLUG,STD,90,3



TE Part #1742087-2  
187 FASTON,FLAG,REC.,18-22 AWG, TPBR

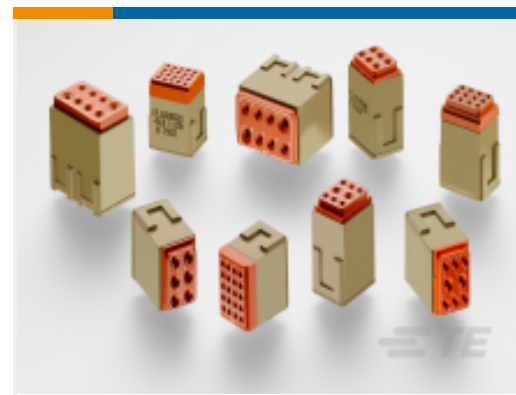

TE Part #YCTJ120E02CC015000  
MODULE ASSY



TE Part #2311770-1  
AMPL REC, HD22, R/A, 44P, THREADED



TE Part #1461352-5  
PCH-112L2M,000

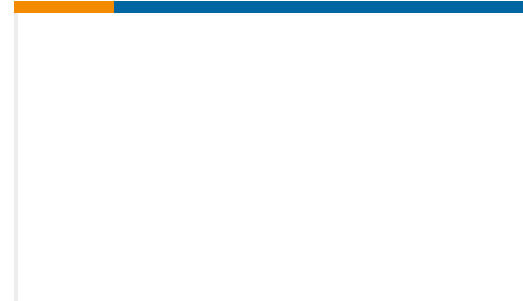

TE Part #YCTJ122E01CC015000  
ELEC MODULE

## Documents

### Product Drawings

#### HSG AMP LEAF 22 POS

English

### CAD Files

#### 3D PDF

3D

#### Customer View Model

[ENG\\_CVM\\_CVM\\_583617-1\\_W.2d\\_dxf.zip](#)

English

#### Customer View Model

[ENG\\_CVM\\_CVM\\_583617-1\\_W.3d\\_igs.zip](#)

English

#### Customer View Model

[ENG\\_CVM\\_CVM\\_583617-1\\_W.3d\\_stp.zip](#)

English

By downloading the CAD file I accept and agree to the [Terms and Conditions](#) of use.

### Product Specifications

#### Product Specification

English

#### Connector, AMP-LEAF, .000030 Gold Plated Contacts, DPH Housing

English

#### Product Specification

English

#### Connector, AMP-LEAF, Phenolic or Thermoplastic Housing

English



### Product Specification

English

### Connector, AMP-LEAF, Tin Plated Contact

English

---

### Product Environmental Compliance

#### Product Compliance

English

#### Product Compliance

English

---

### Agency Approvals

#### Agency Approval Document

English

#### Agency Approval Document

English