

342102-1  ACTIVE

PLASTI-GRIP

TE Internal #: 342102-1

Closed Ring Tongue Terminal, 22 – 16 AWG, M3.5 / #6 Stud Size,  
3.68 mm [.146 in] Stud Diameter, Closed Barrel, Straight, Tin,  
PLASTI-GRIP

[View on TE.com >](#)



Terminals & Splices > Ring Terminals

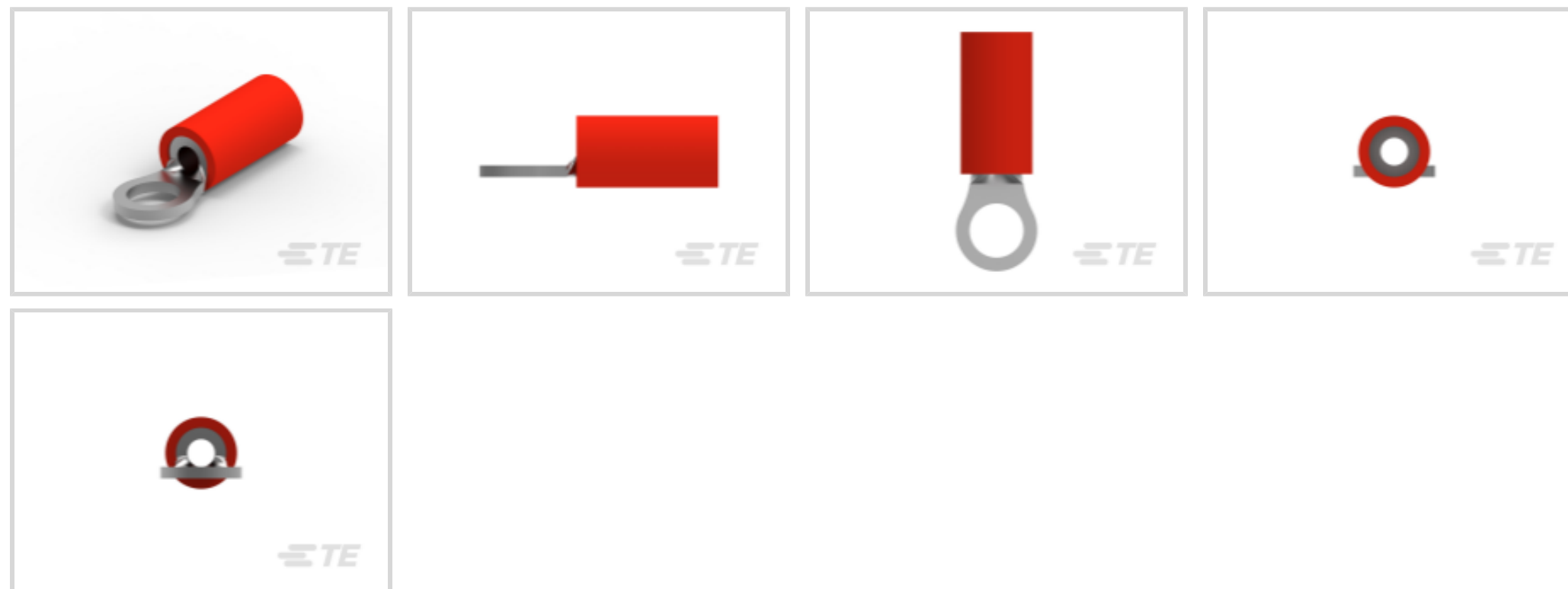

Ring Terminal Product Type: Closed Ring Tongue Terminal

Wire Size: 509 – 3260 CMA

Stud Size: #6, M3.5

### Features

#### Product Type Features

Terminal Features	Sheared
Ring Terminal Product Type	Closed Ring Tongue Terminal
Stud Size	#6, M3.5
Sealable	No
Wire Insulation Support Retention Type	Insulation Support

#### Configuration Features

Number of Holes	1
-----------------	---

#### Electrical Characteristics

Voltage Rating	600 V
----------------	-------

#### Body Features

Product Weight	1.772 g
Insulation Sleeve Color	Red
Stripe Color	Red

#### Contact Features

Barrel Type	Closed
-------------	--------



Terminal Orientation	Straight
----------------------	----------

Terminal Plating Material	Tin
---------------------------	-----

### Mechanical Attachment

Wire Insulation Support	Without
-------------------------	---------

### Dimensions

Wire Size	509 – 3260 CMA
-----------	----------------

Stud Diameter	3.68 mm [.146 in]
---------------	-------------------

Tongue Thickness	.79 mm [.031 in]
------------------	------------------

Product Length	17.5 mm [.689 in]
----------------	-------------------

Compatible Insulation Diameter (Max)	3.56 mm [.14 in]
--------------------------------------	------------------

Compatible Insulation Diameter Range	2.67 – 3.56 mm [.105 – .14 in]
--------------------------------------	--------------------------------

### Usage Conditions

Insulation Option	Partially Insulated
-------------------	---------------------

Operating Temperature Range	90 °C [194 °F]
-----------------------------	----------------

### Operation/Application

Compatible With Wire Base Material	Copper
------------------------------------	--------

Compatible With Wire Plating Material	Tin
---------------------------------------	-----

### Industry Standards

Government Qualified Terminal	No
-------------------------------	----

### Packaging Features

Packaging Quantity	100
--------------------	-----

Packaging Method	Loose Piece
------------------	-------------

### Product Compliance

[For compliance documentation, visit the product page on TE.com>](#)

EU RoHS Directive 2011/65/EU	Compliant
------------------------------	-----------

EU ELV Directive 2000/53/EC	Compliant
-----------------------------	-----------

China RoHS 2 Directive MIIT Order No 32, 2016	No Restricted Materials Above Threshold
---	---

EU REACH Regulation (EC) No. 1907/2006	Current ECHA Candidate List: JUNE 2023 (235) Candidate List Declared Against: JUNE 2023 (235) Does not contain REACH SVHC
--	---



Halogen Content	Not Low Halogen - contains Br or Cl > 900 ppm.
-----------------	--

Solder Process Capability	Not applicable for solder process capability
---------------------------	--

**Product Compliance Disclaimer**

This information is provided based on reasonable inquiry of our suppliers and represents our current actual knowledge based on the information they provided. This information is subject to change. The part numbers that TE has identified as EU RoHS compliant have a maximum concentration of 0.1% by weight in homogenous materials for lead, hexavalent chromium, mercury, PBB, PBDE, DBP, BBP, DEHP, DIBP, and 0.01% for cadmium, or qualify for an exemption to these limits as defined in the Annexes of Directive 2011/65/EU (RoHS2). Finished electrical and electronic equipment products will be CE marked as required by Directive 2011/65/EU. Components may not be CE marked. Additionally, the part numbers that TE has identified as EU ELV compliant have a maximum concentration of 0.1% by weight in homogenous materials for lead, hexavalent chromium, and mercury, and 0.01% for cadmium, or qualify for an exemption to these limits as defined in the Annexes of Directive 2000/53/EC (ELV). Regarding the REACH Regulation, the information TE provides on SVHC in articles for this part number is based on the latest European Chemicals Agency (ECHA) 'Guidance on requirements for substances in articles' posted at this URL: <https://echa.europa.eu/guidance-documents/guidance-on-reach>

## Compatible Parts

<p>TE Part # 59170 T-HEAD PIDG SH 26-14 ASSY</p>	<p>TE Part # 59824-1 TETRA-CRIMP PIDG PG FASTON 22-10 ASSY</p>	<p>TE Part # 47386 DAHT PG PIDG 26-16 ASSY</p>	<p>TE Part # 59250 T-HEAD PIDG 26-14 ASSY</p>
<p>TE Part # 58423-1 DIE, RBY IS9252</p>	<p>TE Part # 58433-3 PRO CR ASSY, RBY IS9252</p>	<p>TE Part # 539691-2 ERGO DIE R.B.Y</p>	<p>TE Part # 2063030-1 SDE DIESET, RBY, UL</p>
<p>TE Part # 47806-2 DIES PIDG 22-16 DIE SET</p>	<p>TE Part # 59300 T-HEAD PIDG PG 26-16 ASSY</p>	<p>TE Part # 1SET191002R0000 TET CRIMP-HT</p>	<p>TE Part # 169404 CERTI-LOK DIE</p>

Also in the Series | **PLASTI-GRIP**



Compression Connectors(3)



Crimp Wire Pins, Tabs & Ferrules(25)



Ring Terminals(333)

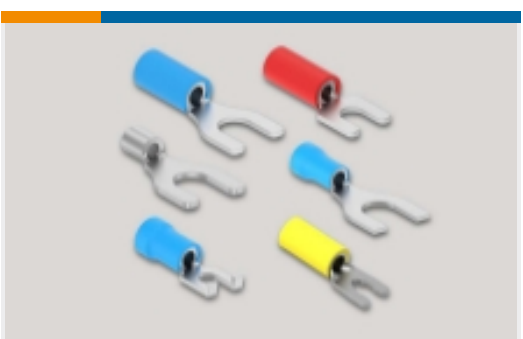

Spade Terminals(198)



Splices(50)

### Customers Also Bought

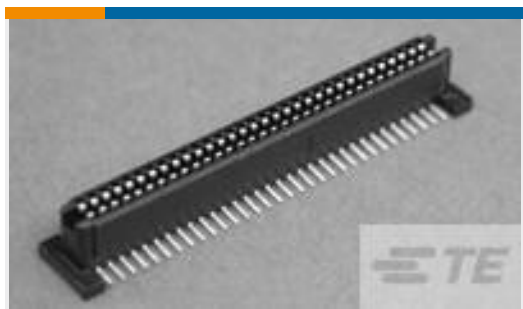

TE Part #146893-1  
1FHR,64,30AVP,S,C,S08,09,10



TE Part #2169806-1  
IMP,Power,3PR,Vert,Recp,Tin



TE Part #1-794221-0  
MINI UMNL2 SOK 22-18AWG AU LF



TE Part #2-530745-2  
MINI BX RECPT ASSY 128P SEALED

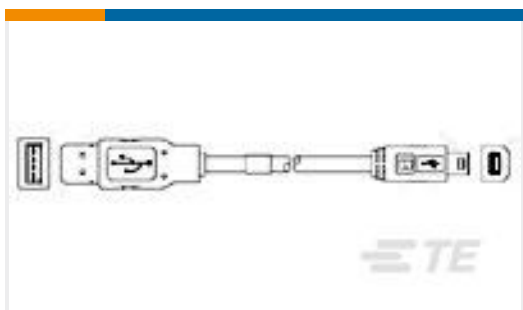

TE Part #1487589-1  
USB, A-B, 25/22, WHITE, 3.0M

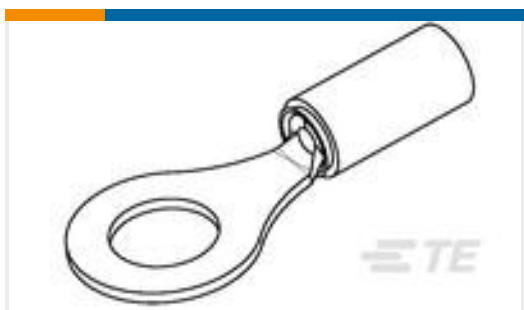

TE Part #1577634-1  
TERMINAL RT PIDG PEEK STRATO 18-16 AWG



TE Part #1410187-3  
MULTIGIG RT T2 7RW DC DF CT

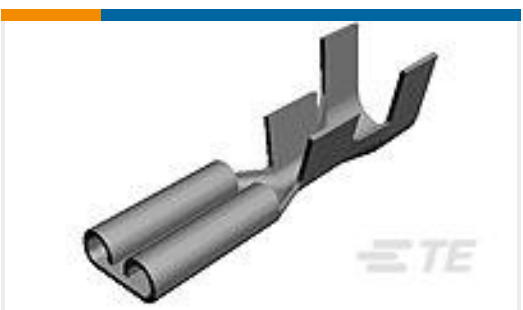

TE Part #63705-1  
125 FASTON REC 22-18 AWG BR

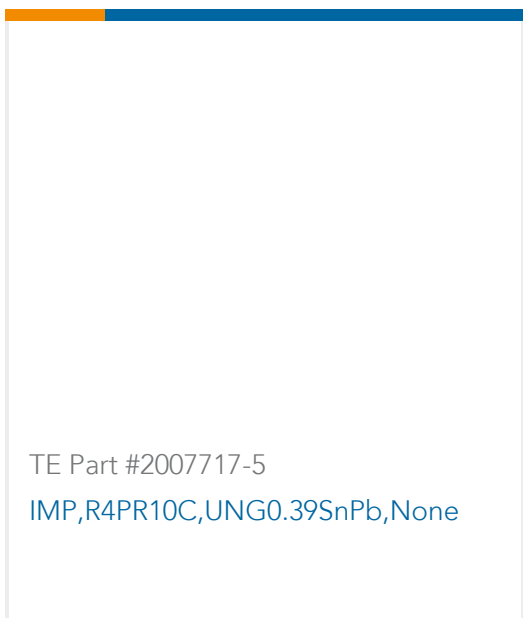

TE Part #2007717-5  
IMP,R4PR10C,UNG0.39SnPb,None

### Documents



### Product Drawings

#### 22-16 F.E.P.G. RING TONGUE NO.

English

---

### CAD Files

#### 3D PDF

3D

#### Customer View Model

[ENG\\_CVM\\_CVM\\_342102-1\\_L.2d\\_dxf.zip](#)

English

#### Customer View Model

[ENG\\_CVM\\_CVM\\_342102-1\\_L.3d\\_igs.zip](#)

English

#### Customer View Model

[ENG\\_CVM\\_CVM\\_342102-1\\_L.3d\\_stp.zip](#)

English

#### 3D PDF

English

#### Customer View Model

[ENG\\_CVM\\_342102-1\\_R1.3d\\_igs.zip](#)

English

#### Customer View Model

[ENG\\_CVM\\_342102-1\\_R1.3d\\_stp.zip](#)

English

#### Customer View Model

[ENG\\_CVM\\_342102-1\\_R1.2d\\_dxf.zip](#)

English

By downloading the CAD file I accept and agree to the [Terms and Conditions](#) of use.

---

### Product Specifications

#### Application Specification

English

---

### Product Environmental Compliance

#### TE Material Declaration

English