



Sensors > Position Sensors > LVDT/LVIT Sensors > HEAVY DUTY DC GAGE HEAD



Housing Diameter: 19.05 mm [ .75 in ]

Full Stroke Ranges:  $\pm 6.35$  mm [  $\pm .25$  in ]

Linearity:  $\pm .25$  % of Span

Linear Position Sensor - LVDT/LVIT Housing Material: **Stainless Steel**

Linear Position Sensor - LVDT/LVIT Form Factor: **Cylindrical**

[All HEAVY DUTY DC GAGE HEAD \(6\)](#)

## Features

### Electrical Characteristics

Linear Position Sensor - LVDT/LVIT Supply Voltage	$\pm 15$ V
Analog Output	$\pm 10$ V
Electrical Connections	6-Pin Connector

### Body Features

Linear Position Sensor - LVDT/LVIT Form Factor	Cylindrical
Spring Loaded	Spring Loaded

### Housing Features

Housing Diameter	19.05 mm [.75 in]
Linear Position Sensor - LVDT/LVIT Housing Material	Stainless Steel

### Usage Conditions

Operating Temperature Range	0 – 70 °C [32 – 158 °F]
Environmental Specifications	1,000 PSI Pressure

### Industry Standards

IP Rating	IP68
Industry Standards	RoHS

### Other

Full Stroke Ranges	±6.35 mm[±.25 in]
--------------------	-------------------

Linearity	±.25 % of Span
-----------	----------------

## Product Compliance

[For compliance documentation, visit the product page on TE.com>](#)

EU RoHS Directive 2011/65/EU	Compliant
------------------------------	-----------

EU ELV Directive 2000/53/EC	Compliant
-----------------------------	-----------

China RoHS 2 Directive MIIT Order No 32, 2016	No Restricted Materials Above Threshold
---	---

EU REACH Regulation (EC) No. 1907/2006	Current ECHA Candidate List: JUNE 2023 (235) Candidate List Declared Against: JUN 2020 (209) Does not contain REACH SVHC
--	--

Halogen Content	Not Yet Reviewed for halogen content
-----------------	--------------------------------------

Solder Process Capability	Not reviewed for solder process capability
---------------------------	--

### Product Compliance Disclaimer

This information is provided based on reasonable inquiry of our suppliers and represents our current actual knowledge based on the information they provided. This information is subject to change. The part numbers that TE has identified as EU RoHS compliant have a maximum concentration of 0.1% by weight in homogenous materials for lead, hexavalent chromium, mercury, PBB, PBDE, DBP, BBP, DEHP, DIBP, and 0.01% for cadmium, or qualify for an exemption to these limits as defined in the Annexes of Directive 2011/65/EU (RoHS2). Finished electrical and electronic equipment products will be CE marked as required by Directive 2011/65/EU. Components may not be CE marked. Additionally, the part numbers that TE has identified as EU ELV compliant have a maximum concentration of 0.1% by weight in homogenous materials for lead, hexavalent chromium, and mercury, and 0.01% for cadmium, or qualify for an exemption to these limits as defined in the Annexes of Directive 2000/53/EC (ELV). Regarding the REACH Regulation, the information TE provides on SVHC in articles for this part number is based on the latest European Chemicals Agency (ECHA) 'Guidance on requirements for substances in articles' posted at this URL: <https://echa.europa.eu/guidance-documents/guidance-on-reach>

## Compatible Parts



Also in the Series | **MEAS GCD**



LVDT/LVIT Sensors(11)

### Customers Also Bought



TE Part #HDP24-24-29PE  
REC, 29P, BLK, E, 12/16/20, P



TE Part #DT06-6S-CE06  
PLG, 6P, BLK, E, SEAL RET



TE Part #DTMH04-2PA  
REC, 2P, BLK, N, HI TEMP, A



TE Part #1670720-2  
SLIDE,TAB HSG GROUP C

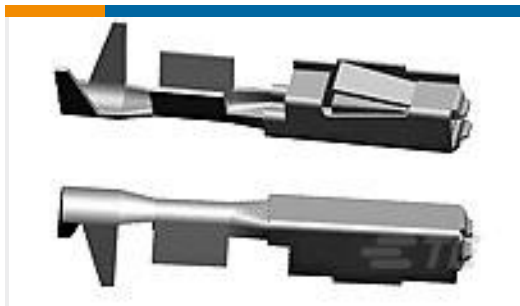

TE Part #5-962885-6  
MQS0,63 Ag rec LL EDS 0,2-0,35

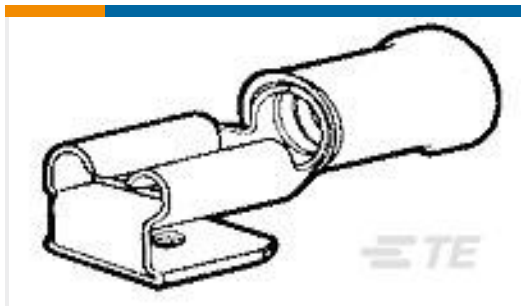

TE Part #9-160463-5  
FASTON, PGYBCK, PIDG, PH BR, .250, 16-14



TE Part #1-1618065-4  
1810DBX=WILMAR PARALLELING RE



TE Part #4-1393104-2  
KRPA-11DG-110=KRPA

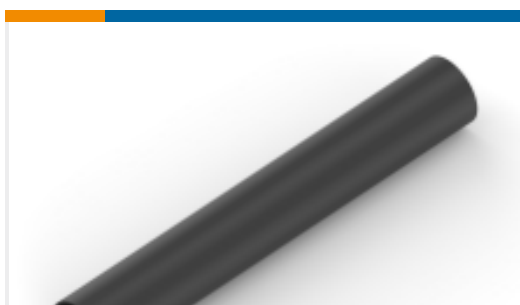

TE Part #NB11802001  
ATUM-8/2-0-STK

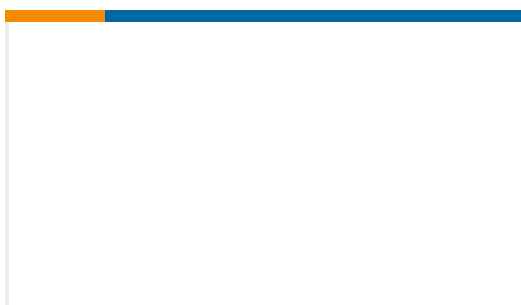

TE Part #R-10609-16  
RTD,DI,ASSY,P100,385,.5%,.25D

### Documents

[Datasheets & Catalog Pages](#)

[DC Operated Gage Heads](#)

English