

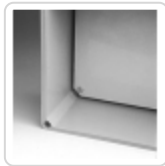

Quality Products. Service Excellence.

## PB Series Inner Panel *PBP Series*

**⊗ Note:** This product line has been discontinued as a stocked series. Information is for reference only. For alternative solution assistance, please **contact Hammond here** or call: USA (716) 630-7030, Canada and International (519) 822-2960.



- Available in steel or unfinished aluminum.
- 14 gauge steel panels are finished in white powder coating.
- Aluminum panels are 0.080" (2.03 mm) unfinished.
- Hardware to mount inner panel is included with PB series enclosures.

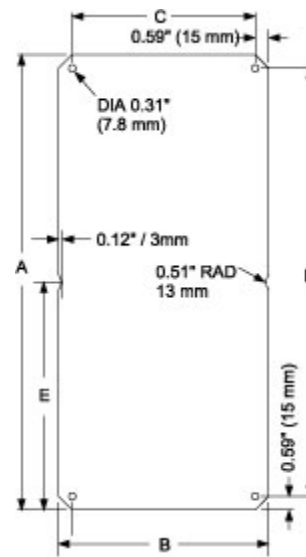

| Steel Panel Part No. | Aluminum Panel | Fits PB Enclosure | A     | B     | C     | D     | E    |
|----------------------|----------------|-------------------|-------|-------|-------|-------|------|
| PBP2718              | PBPA2718       | PB271818          | 9.06  | 5.51  | 4.33  | 7.88  | -    |
| PBP2727              | PBPA2727       | PB272718          | 9.06  | 9.06  | 7.88  | 7.88  | -    |
| PBP3627              | PBPA3627       | PB362718          | 12.60 | 9.06  | 7.88  | 11.42 | -    |
| PBP5427              | PBPA5427       | PB542718          | 19.69 | 9.06  | 7.88  | 18.51 | 9.84 |
| PBP5436              | PBPA5436       | PB543618          | 19.69 | 12.60 | 11.42 | 18.51 | 9.84 |

Data subject to change without notice