

B SERIES, PAG MALE ANGLED

- Connector series: PAG Gender: Male
- Coding: G
- Locking type: Self-locking
- Orientation type: Angled
- Part No.: PAG.XB.XXX.XXXXXX
- Mated with: FSG/FAG/SFG/SRG/SEG/
FBG/PRG/ASG series
"X" refers to part number definition

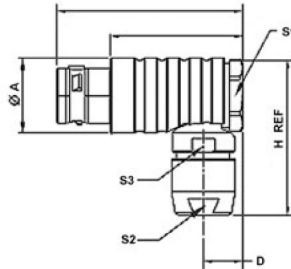

General Information

Size	Dimensions (mm)							
	A	D	H	L	M	S1	S2	S3
00	7.7	5.2	18.0	24.5	16.5	7	5	5.5
0B	11.0	6.5	26.0	31.6	21.6	10	7	8.0
1B		13.5	8.0	30.5	36.0	25.0	11	9
2B	16.5	9.0	34.0	41.5	29.5	14	12	13.0
3B	19.0	10.0	37.0	50.0	35.0	17	14	15.0

Ambient temperature:	- 55 C to + 200 C
Connector insert:	PEEK
Connector contacts:	Bronze, Gold Plated
Coupling nut/screw:	Brass, Nickel Plated
Connector body:	Brass, Cr Plated
Insulation resistance:	≥ 100 M Ω
IP rating	IP50

B SERIES, PAG MALE ANGLED - SR

- Connector series: PAG
- Gender: Male
- Coding: G
- Locking type: Self-locking
- Orientation type: Angled
- Part No.: PAG.XB.XXX.XXXXXXZ
- Mated with: FSG/FAG/SFG/SRG/SEG/
FBG/PRG/ASG series
"X" refers to part number definition

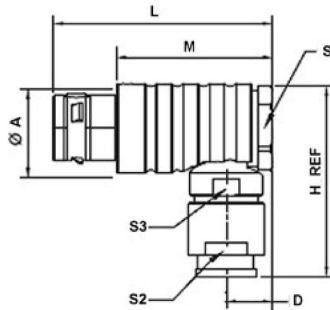

General Information

Size	Dimensions (mm)							
	A	D	H	L	M	S1	S2	S3
00	7.7	5.2	19.5	24.5	16.5	7	5	5.5
0B	11.0	6.5	28.0	31.6	21.6	10	7	8.0
1B		13.5	8.0	33.5	36.0	25.0	11	9
2B	16.5	9.0	38.5	41.5	29.5	14	12	13.0
3B	19.0	10.0	37.0	50.0	35.0	17	14	15.0

Ambient temperature:	- 55 C to + 200 C
Connector insert:	PEEK
Connector contacts:	Bronze, Gold Plated
Coupling nut/screw:	Brass, Nickel Plated
Connector body:	Brass, Cr Plated
Insulation resistance:	≥ 100 M Ω
IP rating	IP50