

APPROVED: \_\_\_\_\_  
 DATE: \_\_\_\_\_ TITLE: \_\_\_\_\_

Rev	AWO #	Description	Date	Appr
-		RELEASED	4/14/16	
A		UPDATED DRAWING	7/14/17	HR/TY

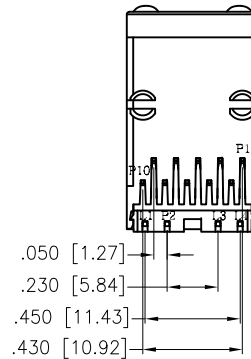
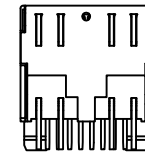
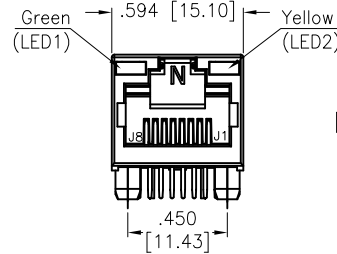
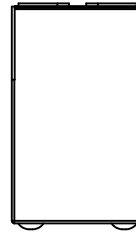
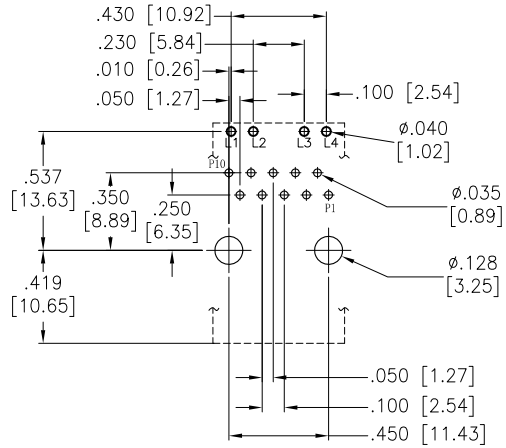

**SPECIFICATIONS:**  
 Material:  
 Insulator: Thermoplastic, rated UL 94V-0  
 Insulator color: Black  
 Module Case: Thermoplastic, rated UL 94V-0, Color: Black  
 Contacts: Phosphor Bronze  
 Contacts Plating:  
 Round contact  
 Gold over Nickel underplate overall  
 Flat contact  
 Gold over Nickel underplate on contact area,  
 Tin over Copper underplate on solder tails  
 (See chart for thickness)

**Electrical:**  
 Insulation resistance: 500 Mohms min  
 Dielectric withstanding voltage: 1500 VAC or 2250 VDC for 1 minute  
**Mechanical:**  
 Temperature Rating:  
 Operating temperature: 0°C to +70°C  
**Environmental:**  
 Lead free, RoHS compliant.



X	PLATING
0	15 µin Gold
1	30 µin Gold
2	50 µin Gold
6	6 µin Gold

UNLESS OTHERWISE SPECIFIED ALL DIMENSIONS ARE INCHES [MM] TOLERANCES: EXCEPT AS NOTED		<h1>ADAM TECH</h1> 909 Rahway Avenue, Union, NJ 07083 Phone: 908-687-5000 Fax: 908-687-5710			
INCHES					
.X ± .10	∅X ± .10	TITLE: MODULAR JACK GANGED, 1 PORT, 8P8C RJ45, W/ LED1 GREEN, LED2 YELLOW			
.XX ± .020	∅XX ± .015				
.XXX ± .015	∅XXX ± .010				
APPROVALS		DATE	SIZE	PART NO.	REV.
DRAWN	AY	4/14/16	X	MTJ-88SX1-LH-M302	A
CHECKED	SL	4/14/16	REF: S00101C	SCALE: NTS	SHEET 1 OF 2
APPROVED					

6

5

4

3

2

1

D

D

C

C

B

B

A

A

6

5

4

3

2

1

APPROVED: \_\_\_\_\_

DATE: \_\_\_\_\_ TITLE: \_\_\_\_\_

Rev	AWO #	Description	Date	Appr
-----	-------	-------------	------	------

SEE SHT 1 OF 2 FOR REVISION

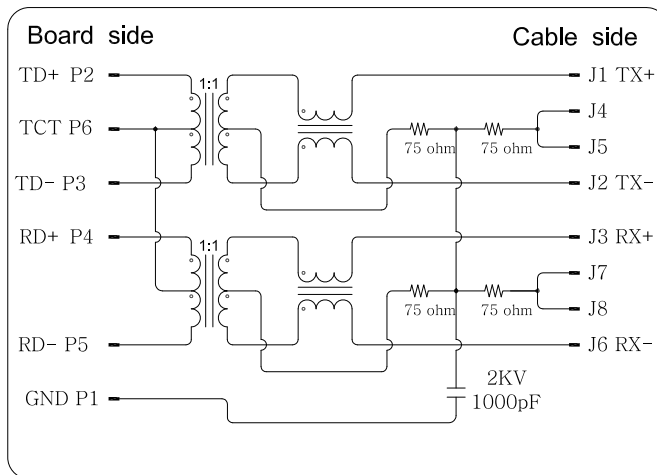

ELECTRICAL CHARACTERISTICS :

1. INSERTION LOSS :  
- 1~100 MHz -1.0dB MAX.
2. RETURN LOSS(LOAD 100Ω) :  
- 1~30 MHz -18dB MIN  
- 30~60 MHz -16dB MIN  
- 60~80 MHz -12dB MIN
3. COMMON MODE REJECTION  
- 1~100 MHz -30dB MIN
4. CROSS TALK  
- 1~100 MHz -30dB MIN
5. INDUCTANCE @ 100KHz, 0.1V, 8mA DC BIAS  
- (P2-P3),(P4-P5) : 350 uH MIN
6. DCR  
- (J1-J2),(J3-J6) : 1.2 Ohm MAX
7. HI-POT TEST  
- BOARD SIDE TO CABLE SIDE : 1500VAC 60S OR 2250VDC 60S
8. TURNS RATION 100KHz  
- (P2-P3) : (J1-J2) = 1:1 ±%3  
- (P4-P5) : (J3-J6) = 1:1 ±%3

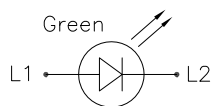

LEFT LED

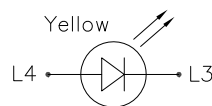

RIGHT LED

UNLESS OTHERWISE SPECIFIED  
ALL DIMENSIONS ARE INCHES [MM]  
TOLERANCES: EXCEPT AS NOTED

INCHES		HOLES	
.X	± .10	Ø.X	±.10
.XX	± .020	Ø.XX	±.015
.XXX	± .015	Ø.XXX	±.010

APPROVALS		DATE
DRAWN	AY	4/14/16
CHECKED	SL	4/14/16
APPROVED		

# ADAM TECH

909 Rahway Avenue, Union, NJ 07083  
Phone: 908-687-5000 Fax: 908-687-5710

TITLE  
MODULAR JACK GANGED, 1 PORT, 8P8C  
RJ45, W/ LED1 GREEN, LED2 YELLOW

SIZE X	PART NO. MTJ-88SX1-LH-M302	REV. A
REF: S00101C	SCALE: NTS	SHEET 2 OF 2