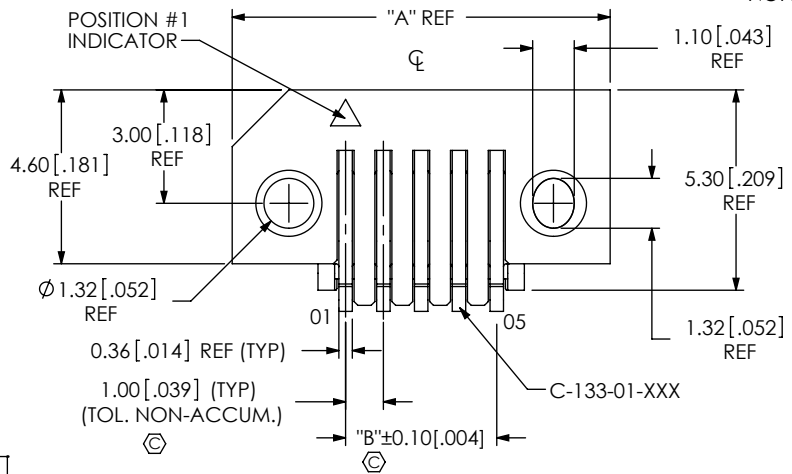
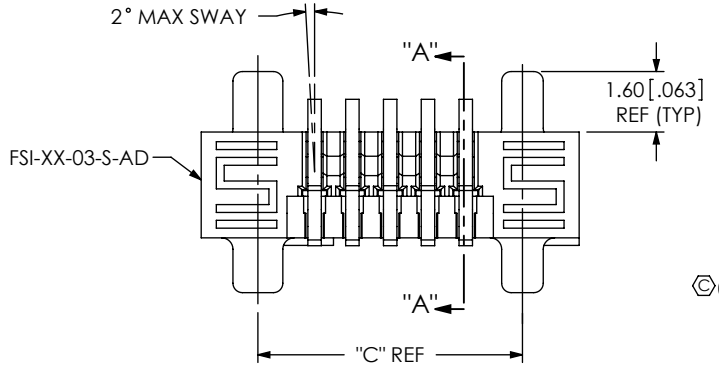


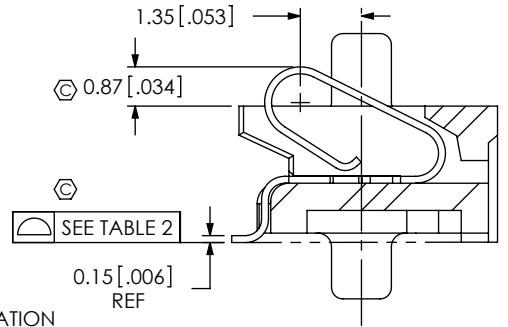
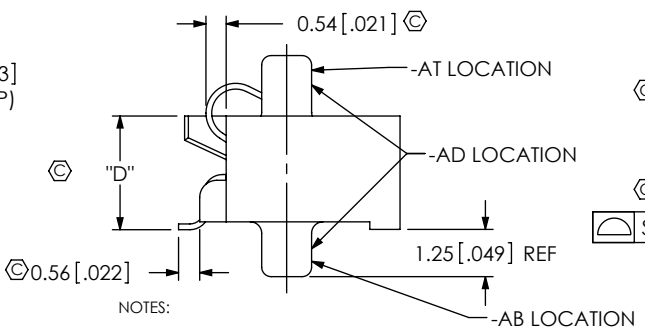
DESIGNED & DIMENSIONED  
IN MILLIMETERS [INCHES]



DO NOT SCALE FROM THIS PRINT



- FSI-1XX-XX-X-S-X-XX-XX-X-XX**
- No OF POSITIONS  
THREADED: -10, -20, -30, -40, -50  
NON-THREADED: -05 THRU -50  
[IN MULTIPLES OF 5]
  - BODY HEIGHT  
-03: 3mm (USE C-133-01-XXX)  
-06: 6mm (USE C-133-02-XXX)  
-10: 10mm (USE C-133-03-XXX)
  - PLATING SPECIFICATION  
-L: 10µ" MIN Au/50µ" Ni IN CONTACT, TIN ON TAIL (-06 & -10 BODY HEIGHT ONLY)  
-S: 30µ" MIN Au/50µ" Ni IN CONTACT, TIN ON TAIL (-06 & -10 BODY HEIGHT ONLY)  
-G: 10µ" MIN Au/50µ" Ni IN CONTACT, 3µ" MIN Au/50µ" Ni ON TAIL (-03 BODY HEIGHT ONLY)  
-H: 30µ" MIN Au/50µ" Ni IN CONTACT, 3µ" MIN Au/50µ" Ni ON TAIL (-03 BODY HEIGHT ONLY)
  - ROW SPECIFICATION  
-S: SINGLE ROW
  - PACKAGING (SEE NOTES 11 & 12)  
BLANK: TUBES (SEE NOTE 10)  
-TR: TAPE & REEL PACKAGING.  
-FR: FULL REEL QTY TAPE & REEL
  - PAD  
-K: POLYIMIDE FILM PAD (USE K-DOT-.256-.375-.005) (AVAILABLE ONLY ON POSITIONS 40 & 50 WITH ANY THREADED INSERT OPTIONS)
  - OPTION  
-WT: WELD TAB (SEE FIG 2) (USE WT-54-01-X) (FOR -06 & -10 HEIGHT OPTIONS) (NOT AVAILABLE WITH THREADED INSERT OPTION)
  - ALIGNMENT PIN LOCATION  
-AT: TOP SIDE (USE FSI-XX-XX-S-AT-X)  
-AB: BOTTOM SIDE (USE FSI-XX-XX-S-AB-X)  
-AD: DUAL (TOP & BOTTOM) (USE FSI-XX-XX-S-AD-X) (BLANK FOR NO ALIGNMENT PIN)
  - THREADED INSERT OPTION  
-XX: BLANK FOR NON-THREADED INSERT  
-E: THREADED INSERT (SEE TABLE 6, SHT 3)  
-M: THREADED INSERT (SEE TABLE 6, SHT 3)



SECTION "A"-A"  
SCALE 6:1

- NOTES:
- Ⓢ REPRESENTS A CRITICAL DIMENSION.
  - MINIMUM PUSHOUT FORCE: 8 oz.
  - LOAD INSERTS IN THE DIRECTION OF THE ARROW USING THERMAL INSERTION.  
THREADED INSERT BODY HEIGHT: -03 TO BE FLUSH TO 0.13[.005] BELOW HOUSING SURFACE.  
BODY HEIGHT: -06 AND -10 TO BE FLUSH TO 0.90[.035] BELOW HOUSING SURFACE.
  - THREADED INSERT OPTION WITH -03 BODY HEIGHT MUST BE ABLE TO HANDLE 20 in-oz's OF TORQUE MIN WITHOUT ROTATING OR "LOOSENING", WITH -06 & -10 BODY HEIGHT MUST BE ABLE TO HANDLE 54 in-oz's OF TORQUE MIN WITHOUT ROTATING OR "LOOSENING".
  - MINIMUM THREADED INSERT RETENTION: -03 BODY HEIGHT: 7 lbs, -06 & -10 BODY HEIGHT: 50 lbs.
  - NOTE DELETED.
  - HEAT STAKE FORM WILL PRODUCE RETENTION FLANGE AS SHOWN, GAP TO BE 0.25[0.010] MAX AFTER ASSEMBLY. ONLY FOR -06 & -10 BODY HEIGHT.
  - NOT RECOMMENDED FOR INVERTED REFLOW SOLDER.
  - NOTE DELETED.
  - TUBES ARE STANDARD PACKAGING
  - ORDERS WILL BE PACKAGED ACCORDING TO THE SAMTEC PACKAGING EFFICIENCY STANDARDS (SPES) FOUND ON WWW.SAMTEC.COM
  - ATTACH LABEL TO EACH REEL

**TABLE 3**

BODY HEIGHT	"D"
-03	3.00 [0.118]
-06	6.00 [0.236]
-10	10.00 [0.394]

**TABLE 2**

No. OF POS.	COPLANARITY
-05 THRU -35	0.10 [.004]
-40 THRU -50	0.15 [.006]

FIG 1  
(FSI-105-03-X-S-AD-TR SHOWN)

**TABLE 1**

No. OF POS	"A"	"B"	"C"
-05	10.00 [0.394]	4.000 [0.1575]	7.000 [0.2756]
-10	15.00 [0.591]	9.000 [0.3543]	12.000 [0.4724]
-15	20.00 [0.787]	14.000 [0.5512]	17.000 [0.6693]
-20	25.00 [0.984]	19.000 [0.7480]	22.000 [0.8661]
-25	30.00 [1.181]	24.000 [0.9449]	27.000 [1.0630]
-30	35.00 [1.378]	29.000 [1.1417]	32.000 [1.2598]
-35	40.00 [1.575]	34.000 [1.3386]	37.000 [1.4567]
-40	45.00 [1.772]	39.000 [1.5354]	42.000 [1.6535]
-45	50.00 [1.969]	44.000 [1.7323]	47.000 [1.8504]
-50	55.00 [2.165]	49.000 [1.9291]	52.000 [2.0472]

UNLESS OTHERWISE SPECIFIED, DIMENSIONS ARE IN MILLIMETERS. TOLERANCES ARE:  
DECIMALS ANGLES  
X.X: ±0.3 [0.1] 2°  
X.XX: ±0.13 [0.05]  
X.XXX: ±0.051 [0.020]

**PROPRIETARY NOTE**  
THIS DOCUMENT CONTAINS INFORMATION CONFIDENTIAL AND PROPRIETARY TO SAMTEC, INC. AND SHALL NOT BE REPRODUCED OR TRANSFERRED TO OTHER DOCUMENTS OR DISCLOSED TO OTHERS OR USED FOR ANY PURPOSE OTHER THAN THAT WHICH IT WAS OBTAINED WITHOUT THE EXPRESSED WRITTEN CONSENT OF SAMTEC, INC.

**samtec**  
520 PARK EAST BLVD., NEW ALBANY, IN 47150  
PHONE: 812-944-6733 FAX: 812-948-5047  
e-Mail: info@SAMTEC.com code 53322

**MATERIAL:** DO NOT SCALE DRAWING SHEET SCALE: 1:0.2  
INSULATOR: LCP COLOR: BLACK.  
CONTACT: BeCu  
INSERT: BRASS

**DESCRIPTION:**  
1mm SINGLE ELEMENT INTERFACE

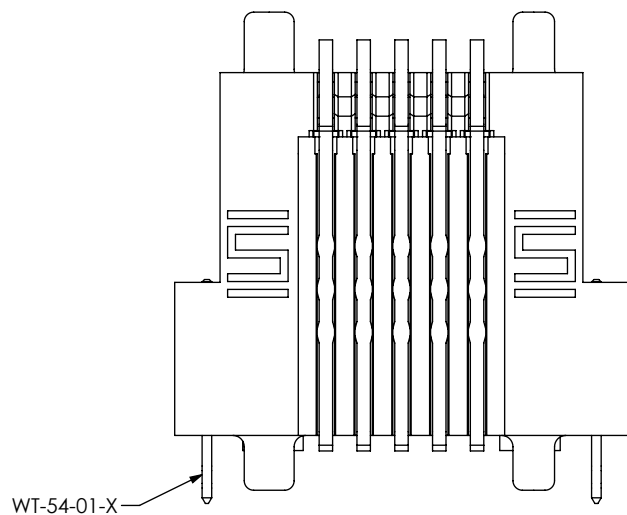
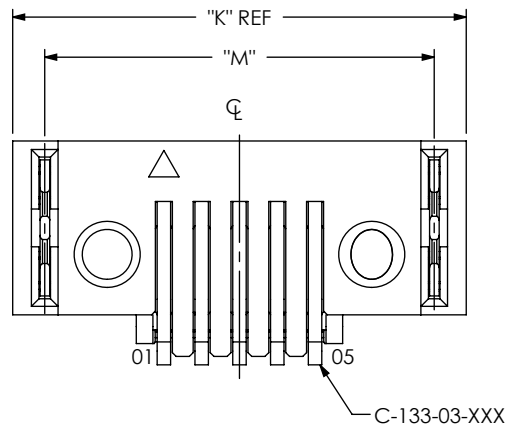
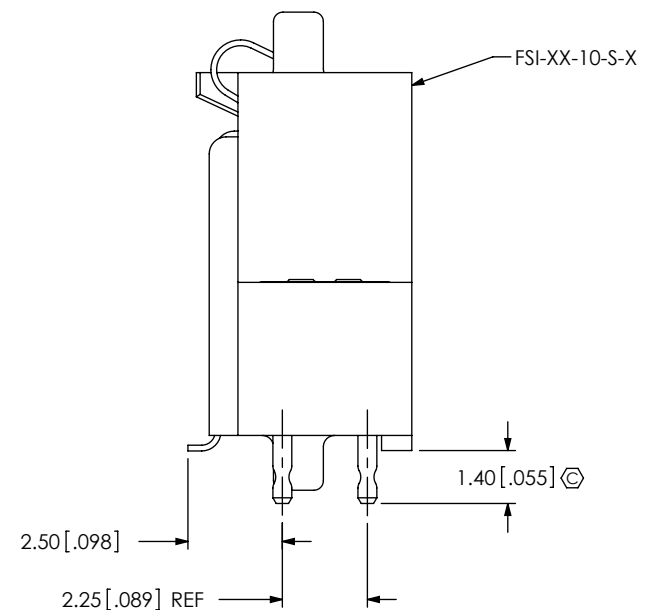


FIG 2  
 -WT OPTIONS  
 (FSI-105-10-X-S-AD-WT SHOWN)  
 (SAME AS FIG 1, EXCEPT AS SHOWN)  
 (FOR -06 & -10 HEIGHT ONLY)  
 (NOT AVAILABLE WITH THREADED INSERT OPTION)

TABLE 4		
No. OF POS	"K"	"M"
-05	12.00 [0.472]	10.305 [0.4057]
-10	17.00 [0.669]	15.305 [0.6026]
-15	22.00 [0.866]	20.305 [0.7994]
-20	27.00 [1.063]	25.305 [0.9963]
-25	32.00 [1.260]	30.305 [1.1931]
-30	37.00 [1.457]	35.305 [1.3900]
-35	42.00 [1.654]	40.305 [1.5868]
-40	47.00 [1.850]	45.305 [1.7837]
-45	52.00 [2.047]	50.305 [1.9805]
-50	57.00 [2.244]	55.305 [2.1774]



**PROPRIETARY NOTE**  
 THIS DOCUMENT CONTAINS INFORMATION  
 CONFIDENTIAL AND PROPRIETARY TO  
 SAMTEC, INC. AND SHALL NOT BE REPRODUCED  
 OR TRANSFERRED TO OTHER DOCUMENTS OR  
 DISCLOSED TO OTHERS OR USED FOR ANY  
 PURPOSE OTHER THAN THAT WHICH IT WAS  
 OBTAINED WITHOUT THE EXPRESSED WRITTEN  
 CONSENT OF SAMTEC, INC.

DO NOT SCALE DRAWING

SHEET SCALE: 5:1

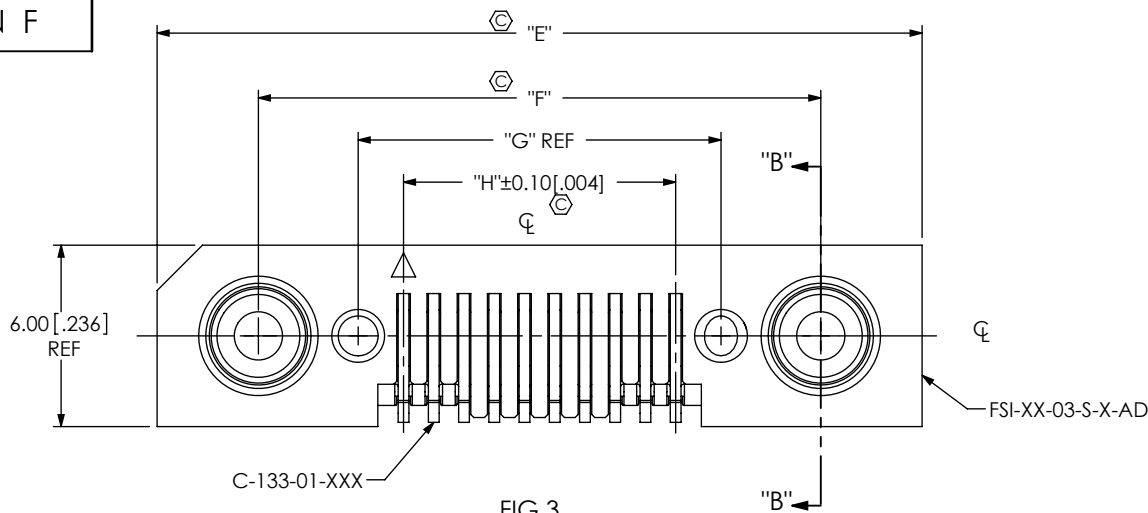
**samtec**

520 PARK EAST BLVD, NEW ALBANY, IN 47150  
 PHONE: 812-944-6733 FAX: 812-948-5047  
 e-Mail info@SAMTEC.com code 55322

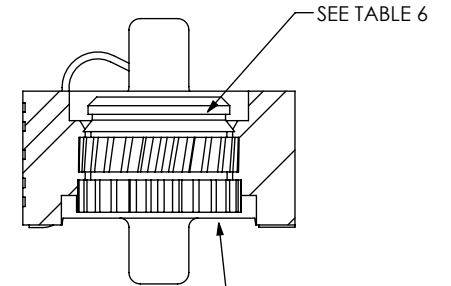
DESCRIPTION:  
 1mm SINGLE ELEMENT INTERFACE

DWG. NO.  
 FSI-1XX-XX-X-S-X-XX-XX-X-XX

BY: ROY LUO 06/14/2010 SHEET 2 OF 6

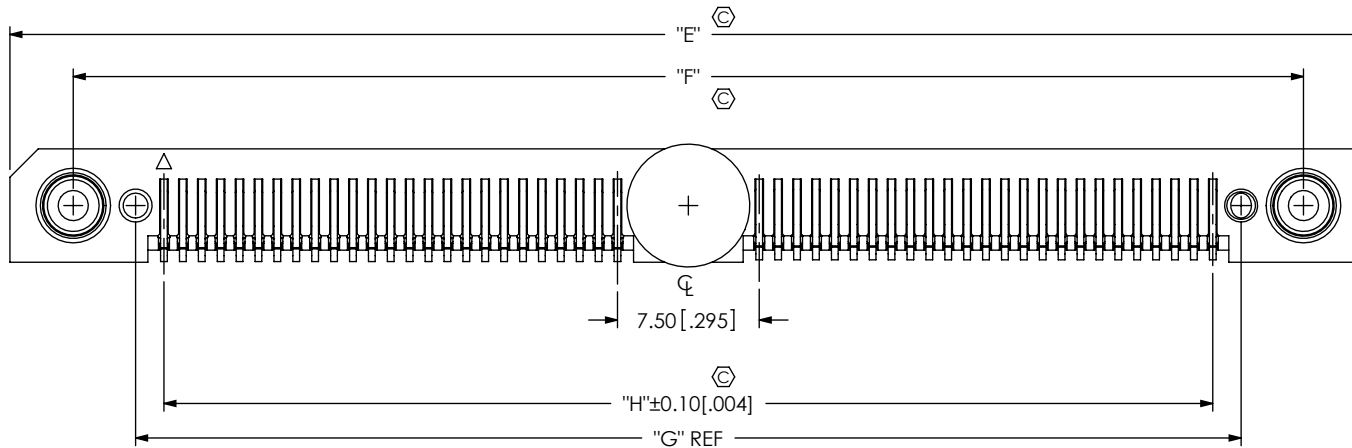


**FIG 3**  
-M & -E THREADED OPTIONS  
(FSI-110-03-X-S-X-AD-TR SHOWN)  
(SAME AS FIG 1, EXCEPT AS SHOWN)  
(FOR -10, -20 & -30 POS ONLY)



LOAD INSERT  
FROM BOTTOM  
(SEE NOTE 3)

**SECTION "B"- "B"**  
**SCALE 6 : 1**



**FIG 4**  
-M & -E THREADED OPTIONS  
(FSI-150-03-X-S-X-AD-K SHOWN)  
(SAME AS FIG 3, EXCEPT AS SHOWN)  
(FOR -40 & -50 POS ONLY)

**TABLE 5**

No. OF POS	"E"	"F"	"G"	"H"
-10	25.30 [0.996]	18.60 [0.732]	12.000 [0.4724]	9.000 [0.3543]
-20	35.30 [1.390]	28.60 [1.126]	22.000 [0.8661]	19.000 [0.7480]
-30	45.30 [1.783]	38.60 [1.520]	32.000 [1.2598]	29.000 [1.1417]
-40	61.80 [2.433]	55.10 [2.169]	48.500 [1.9094]	45.500 [1.7913]
-50	71.80 [2.827]	65.10 [2.563]	58.500 [2.3031]	55.500 [2.1850]

**TABLE 6**

OPTION	BODY HEIGHT	INSERT	THREADED
-E	-03	INS-C-2-56-100	2 x 56
	-06 & -10	INS-19-2-56-157	2 x 56
-M	-03	INS-C-M2-100-N	M2.0 x 4
	-06 & -10	INS-19-M2-157-N	M2.0 x 4

**PROPRIETARY NOTE**

THIS DOCUMENT CONTAINS INFORMATION CONFIDENTIAL AND PROPRIETARY TO SAMTEC, INC. AND SHALL NOT BE REPRODUCED OR TRANSFERRED TO OTHER DOCUMENTS OR DISCLOSED TO OTHERS OR USED FOR ANY PURPOSE OTHER THAN THAT WHICH IT WAS OBTAINED WITHOUT THE EXPRESSED WRITTEN CONSENT OF SAMTEC, INC.

DO NOT SCALE DRAWING

SHEET SCALE: 5:1



520 PARK EAST BLVD, NEW ALBANY, IN 47150  
PHONE: 812-944-6733 FAX: 812-948-5047  
e-Mail: info@SAMTEC.com code 55322

DESCRIPTION: 1mm SINGLE ELEMENT INTERFACE

DWG. NO. FSI-1XX-XX-X-S-X-XX-XX-X-XX

BY: ROY LUO 06/14/2010 SHEET 3 OF 6

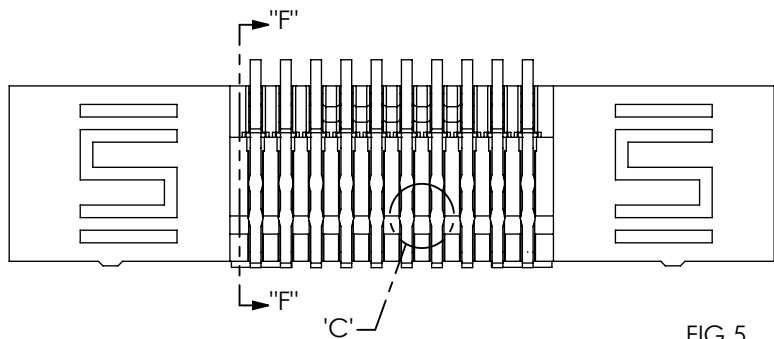
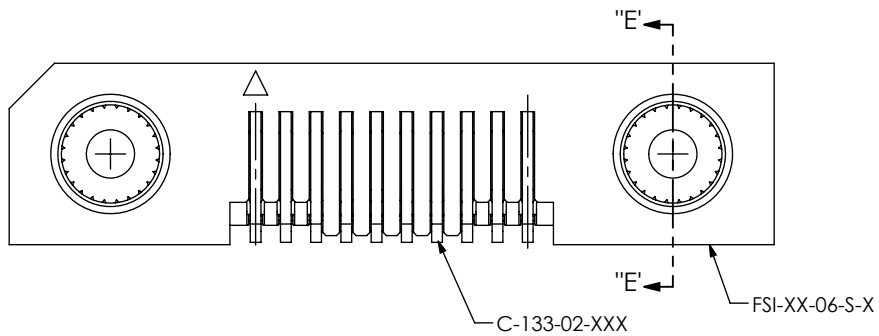
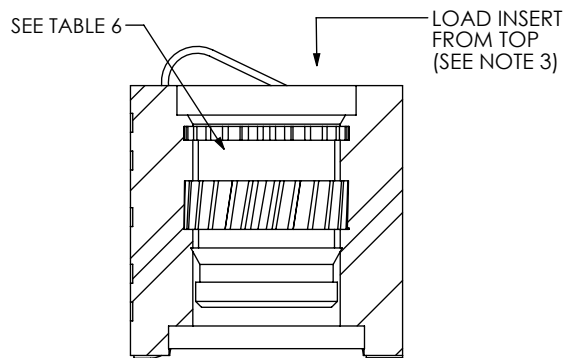
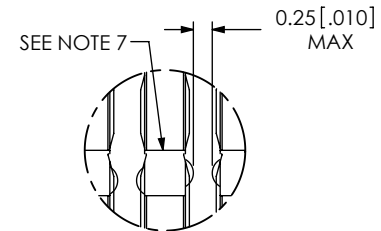


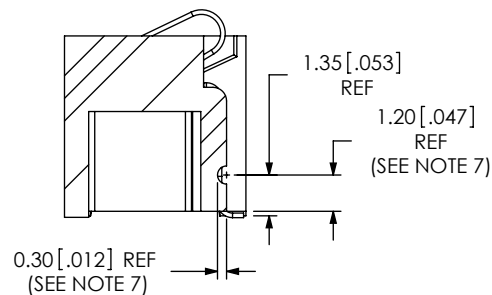
FIG 5  
(FSI-110-06-X-S-X-TR SHOWN)  
(SAME AS FIG 3, EXCEPT AS SHOWN)  
(FOR -10, -20 & -30 POS ONLY)



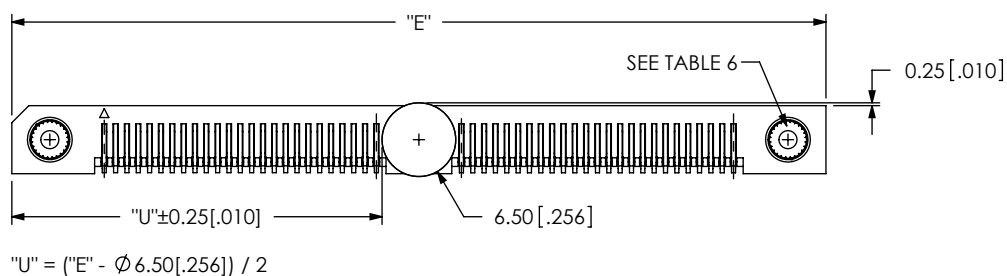
SECTION "E"-"E"  
SCALE 6 : 1



DETAIL "C"  
SCALE 10 : 1



SECTION "F"-"F"  
SCALE 4 : 1



"U" = ("E" -  $\phi$  6.50 [0.256]) / 2

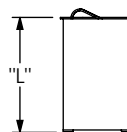
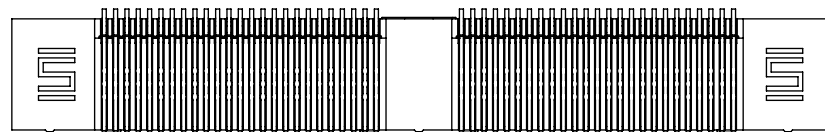


FIG 6  
(FSI-150-10-X-S-X-K SHOWN)  
(SAME AS FIG 5, EXCEPT AS SHOWN)  
(FOR -40 & -50 POS ONLY)

TABLE 9	
BODY HEIGHT	"L"
-3	3.13 [0.123]
-06	6.13 [0.241]
-10	10.13 [0.399]

PROPRIETARY NOTE

THIS DOCUMENT CONTAINS INFORMATION CONFIDENTIAL AND PROPRIETARY TO SAMTEC, INC. AND SHALL NOT BE REPRODUCED OR TRANSFERRED TO OTHER DOCUMENTS OR DISCLOSED TO OTHERS OR USED FOR ANY PURPOSE OTHER THAN THAT WHICH IT WAS OBTAINED WITHOUT THE EXPRESSED WRITTEN CONSENT OF SAMTEC, INC.

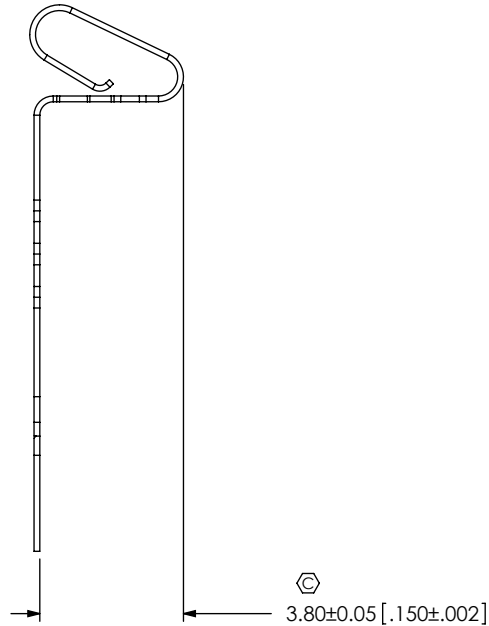
DO NOT SCALE DRAWING

SHEET SCALE: 1:0.2

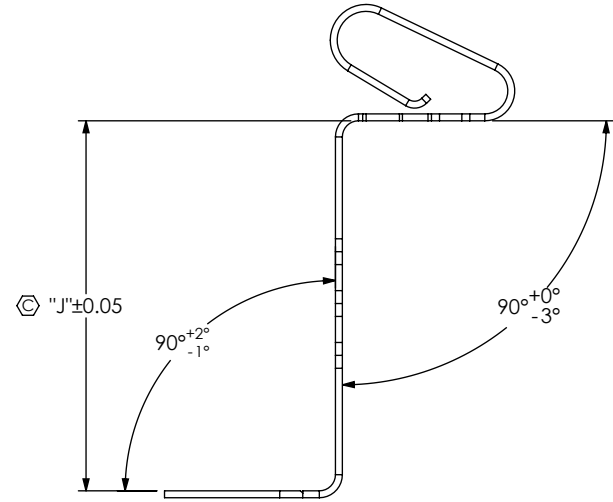


520 PARK EAST BLVD, NEW ALBANY, IN 47150  
PHONE: 812-944-6733 FAX: 812-948-5047  
e-Mail info@SAMTEC.com code 55322

DESCRIPTION:	1mm SINGLE ELEMENT INTERFACE
DWG. NO.	FSI-1XX-XX-X-S-X-XX-XX-X-XX
BY: ROY LUO	06/14/2010 SHEET 4 OF 6

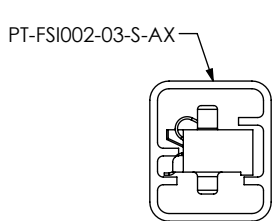


IN-PROCESS 1  
(FROM (1) CONTACT C-133-XX-X)  
(FOR -06, -10 BODY HEIGHT)

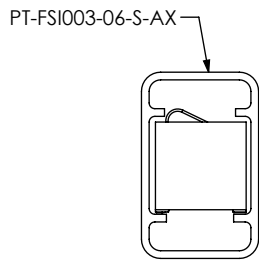


IN-PROCESS 2  
(FROM (2) CONTACT C-133-XX-X)  
(FOR -06, -10 BODY HEIGHT)

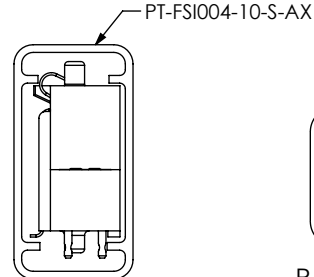
TABLE 8	
BODY HEIGHT	"J"
-06	4.15 [0.163]
-10	8.15 [0.321]



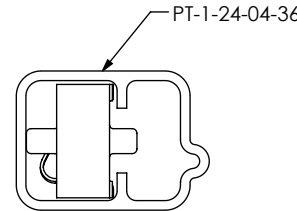
PACKAGING VIEW  
FSI-1XX-03-X-S-XX



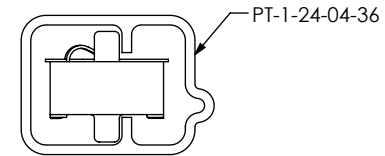
PACKAGING VIEW  
FSI-1XX-06-X-S-XX



PACKAGING VIEW  
FSI-1XX-10-X-S-XX



PACKAGING VIEW  
FSI-1XX-03-X-S-E-XX  
FSI-1XX-03-X-S-M-XX



PACKAGING VIEW  
FSI-1XX-03-X-S-E-XX-K  
FSI-1XX-03-X-S-M-XX-K

PACKAGING TABLE		
BODY HEIGHT	TUBE	PLUG
-03	PT-FSI002-03-S-AX	TP-09
-03 (-M & -E OPTIONS)	PT-1-24-04-36	TP-09
-06	PT-FSI003-06-S-AX	TP-09
-10	PT-FSI004-10-S-AX	TP-09

**PROPRIETARY NOTE**  
THIS DOCUMENT CONTAINS INFORMATION CONFIDENTIAL AND PROPRIETARY TO SAMTEC, INC. AND SHALL NOT BE REPRODUCED OR TRANSFERRED TO OTHER DOCUMENTS OR DISCLOSED TO OTHERS OR USED FOR ANY PURPOSE OTHER THAN THAT WHICH IT WAS OBTAINED WITHOUT THE EXPRESSED WRITTEN CONSENT OF SAMTEC, INC.

DO NOT SCALE DRAWING

SHEET SCALE: 6:1




520 PARK EAST BLVD, NEW ALBANY, IN 47150  
PHONE: 812-944-6733 FAX: 812-948-5047  
e-Mail info@SAMTEC.com code 55322

DESCRIPTION:  
1mm SINGLE ELEMENT INTERFACE

DWG. NO.  
FSI-1XX-XX-X-S-X-XX-XX-X-XX

BY: ROY LUO 06/14/2010 SHEET 5 OF 6

<p><b>PROPRIETARY NOTE</b> THIS DOCUMENT CONTAINS INFORMATION CONFIDENTIAL AND PROPRIETARY TO SAMTEC, INC. AND SHALL NOT BE REPRODUCED OR TRANSFERRED TO OTHER DOCUMENTS OR DISCLOSED TO OTHERS OR USED FOR ANY PURPOSE OTHER THAN THAT WHICH IT WAS OBTAINED WITHOUT THE EXPRESSED WRITTEN CONSENT OF SAMTEC, INC.</p> <p>DO NOT SCALE DRAWING</p> <p>SHEET SCALE: 1:0.2</p>	 <p>520 PARK EAST BLVD, NEW ALBANY, IN 47150 PHONE: 812-944-6733 FAX: 812-948-5047 e-Mail info@SAMTEC.com code 55322</p>	
	DESCRIPTION: 1mm SINGLE ELEMENT INTERFACE	
	DWG. NO. FSI-1XX-XX-X-S-X-XX-XX-X-	
	BY: ROY LUO 06/14/2010	SHEET 6 OF 6