

DO NOT SCALE FROM THIS PRINT

FHP-XX-XX-XX-S-XX-XX-X-XX

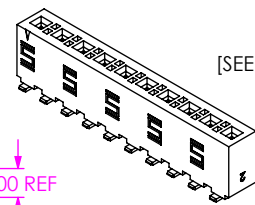
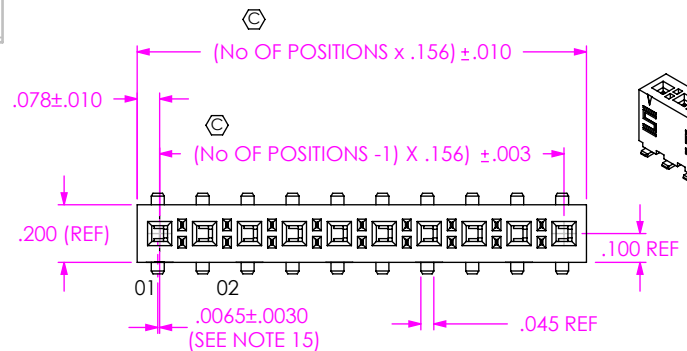

No OF POSITIONS
-02 THRU -24
(PER ROW)
(SEE POSITIONAL FILL VIEW)

LEAD STYLE
-01: THROUGH HOLE
(USE C-130-03-X)
-02: SURFACE MOUNT
(USE C-130-04-X)

PLATING SPECIFICATION
-T: MATTE TIN CONTACT AND TAIL
(USE C-130-XX-T)
-TM: MATTE TIN CONTACT AND TAIL
(USE C-130-XX-T)
-H: 30µ" GOLD IN CONTACT AREA,
3µ" GOLD ON TAIL (USE C-130-XX-H)

PACKAGING
BLANK: TUBES (SEE NOTE 6, 10 & 13)
-TR: TAPE & REEL (SEE NOTES 13 & 14)
-FR: FULL REEL QTY TAPE & REEL
(SEE NOTES 13 & 14)
(-TR & -FR AVAILABLE FOR 2 THRU 18 POS)

PICK & PLACE OPTION
-K: POLYIMIDE FILM PAD (-02 LEAD STYLE ONLY)
(SEE FIG 3, SHT. 2)(USE K-DOT-.256-.375-.005)
(AVAILABLE ON POSITIONS 2-24,
2-4 POSITIONS MUST BE IN -TR & -FR)

*POLARIZATION
(SEE SHT 2, IN-PROCESS 1 POLARIZED FILL)
(SEE NOTE 12)

OPTION
-LC: LOCKING CLIP (USE LC-05-TM)
(-02 LEAD STYLE ONLY, SEE NOTE 11)
-A: ALIGNMENT PIN (USE FHPR-XX-S-A)
(SEE FIG 2, SHT 2)(-02 LEAD STYLE ONLY)

ROW SPECIFICATION
-S: SINGLE (USE FHPR-XX-S)

* = INTERNAL USE ONLY
NOT FOR SALE

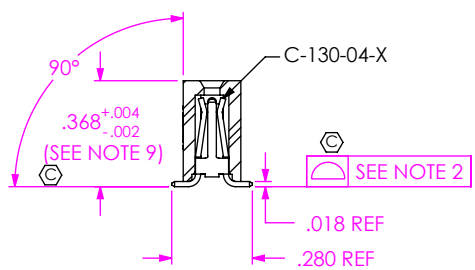
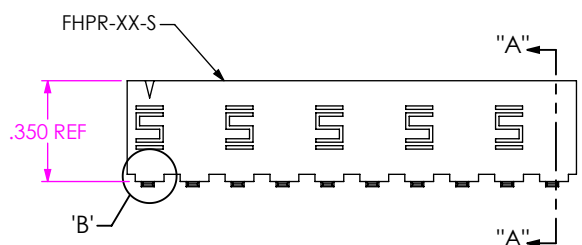

SECTION "A"-A"
STYLE -02

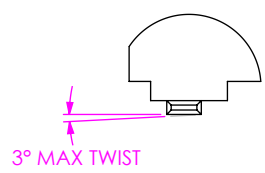

DETAIL 'B'
SCALE 4:1

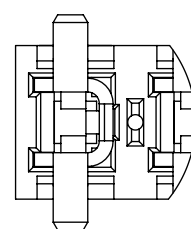

DETAIL 'A'
SCALE 4:1
(SHOWN FOR CONTACT ORIENTATION)

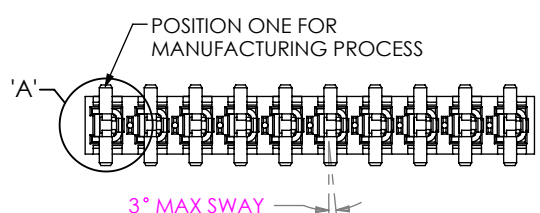
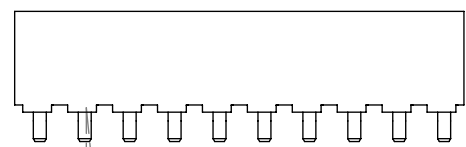
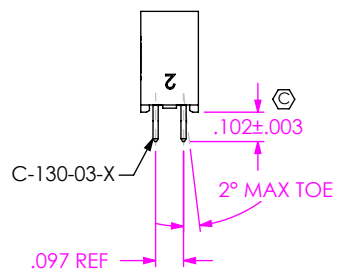

FIG 1
(FHP-10-02-X-S SHOWN)



STYLE -01



NOTES:

1. REPRESENTS A CRITICAL DIMENSION.
2. COPLANARITY TO BE WITHIN .006".
3. BURR ALLOWANCE: .0015 MAX.
4. MAXIMUM CUT FLASH: .020.
5. MINIMUM PUSHOUT FORCE: 1.0 LB.
6. LAYER PACKAGE STYLE -01 & -02, POSITIONS 02 - 04 WITH NO OPTIONS ONLY.
7. OPEN PART OF CONTACT FILLED TOWARDS #1 PIN INDICATOR
8. MINIMUM WALL THICKNESS TO BE .010".
9. MEASURED @ BEND.
10. TUBE PACKAGING AVAILABLE FOR 5 THRU 24 POSITIONS.
11. DUE TO THE HIGH AMOUNT OF INSERTION FORCE NEEDED, THE -LC OPTION IS NOT COMPATIBLE WITH AUTO PLACEMENT. SAMTEC RECOMMENDS MANUAL PLACEMENT FOR ALL ASSEMBLIES WITH THE -LC OPTION.
12. POLARIZATION NUMBER INDICATES THE AMOUNT OF LIVE CONTACTS IN THE CONNECTOR.
13. ORDERS WILL BE PACKAGED ACCORDING TO THE SAMTEC PACKAGING EFFICIENCY STANDARDS (SPES) FOUND ON WWW.SAMTEC.COM.
14. ATTACH LABEL-4X2 TO EACH REEL.
15. IN THE TOP VIEW, THE PROPER LOCATION OF THE OFFSET SOLDER TAIL WILL BE WITH THE SOLDER TAIL OFFSET TO THE LEFT OF THE MATING OR PLUGGING HOLE. THE OFFSET IS DESCRIBED BY THE .0065 +/- .0030.

UNLESS OTHERWISE SPECIFIED, DIMENSIONS ARE IN INCHES.		* PROPRIETARY NOTE	
TOLERANCES ARE:		THIS DOCUMENT CONTAINS CONFIDENTIAL AND PROPRIETARY INFORMATION AND ALL DESIGN, MANUFACTURING, REPRODUCTION, USE, PATENT RIGHTS AND SALES RIGHTS ARE EXPRESSLY RESERVED BY SAMTEC, INC. THIS DOCUMENT SHALL NOT BE DISCLOSED, IN WHOLE OR PART, TO ANY UNAUTHORIZED PERSON OR ENTITY NOR REPRODUCED, TRANSFERRED OR INCORPORATED IN ANY OTHER PROJECT IN ANY MANNER WITHOUT THE EXPRESS WRITTEN CONSENT OF SAMTEC, INC.	
DECIMALS	ANGLES		
.XX: ±.01	2°		
.XXX: ±.005			
.XXXX: ±.0020			
MATERIAL:	DO NOT SCALE DRAWING	SHEET SCALE: 1.5:1	
MATERIAL: PRIMARY: VECTRA E130I BLACK, ALTERNATE: SUMIKA E6007LHF BLACK CONTACT: BeCu, 174HT			
F:\DVG\MISC\MKTG\FHP-XX-XX-XX-S-XX-XX-X-XX-MKT.SLDRW			

samtec		
520 PARK EAST BLVD, NEW ALBANY, IN 47150 PHONE: 812-944-6733 FAX: 812-948-5047 e-Mail: info@SAMTEC.com code: 55322		
DESCRIPTION: .156 HI POWER SOCKET ASSEMBLY		
DWG. NO. FHP-XX-XX-XX-S-XX-XX-X-XX		
BY: BRATCHER	03/01/99	SHEET 1 OF 2

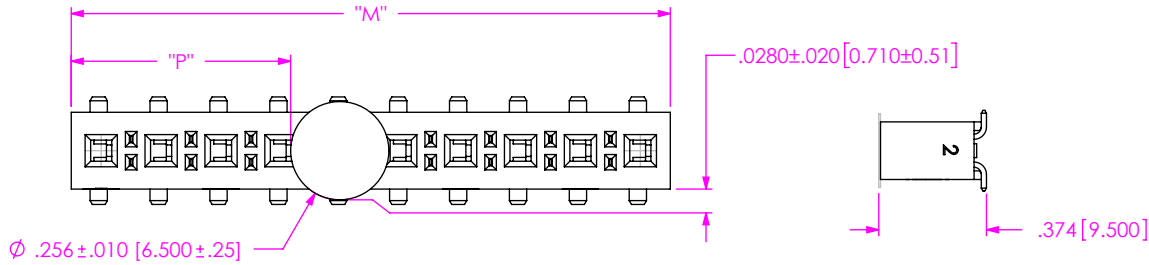
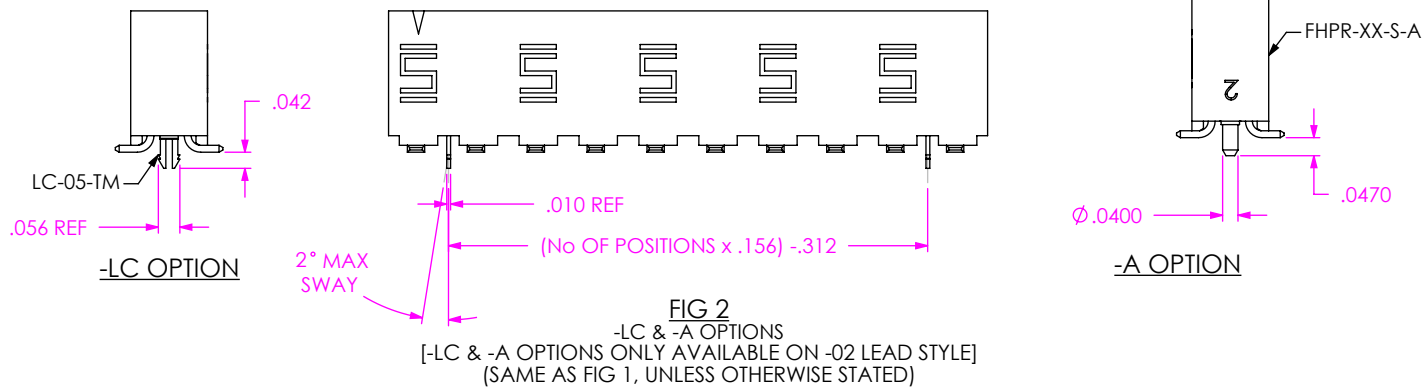

NOTE: "M" = USED MEASURED DIMENSION (REF)
 "P" = {("M" - .256 [6.50]) / 2} ± .020 [.51]

FIG 3
 -K: POLYIMIDE FILM PAD OPTION
 (SHOWN: FHP-10-02-X-S-K)

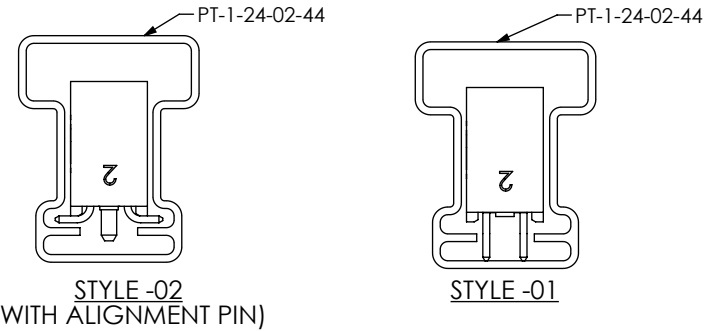

(TUBE PACKAGING AVAILABLE FOR 5 THRU 24 POS)
 (TUBE PACKAGE THE PARTS WITH #1 PIN TOWARDS ARROW)

IN-PROCESS 1
 FILL C-130-XX-X

POLARIZED OPTION
 ■ = DENOTES EMPTY POSITION
-02 POLARIZATION
 (8 FINISHED GOODS)
 FHP-24-02-XX-S-02 SHOWN

-05 POLARIZATION
 (4 FINISHED GOODS)
 FHP-24-02-XX-S-05 SHOWN

-12 POLARIZATION
 (1 FINISHED GOODS)
 FHP-24-02-XX-S-12 SHOWN

STANDARD FILL

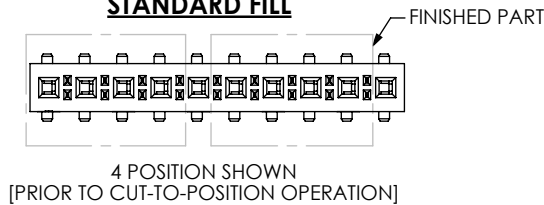

PACKAGING TABLE

LEAD STYLE	OPTIONS	PACKAGING TUBE	PLUG
-01	ALL OPTIONS	PT-1-24-02-44	TP-03
-02	ALL OPTIONS	PT-1-24-02-44	TP-03

PROPRIETARY NOTE

THIS DOCUMENT CONTAINS CONFIDENTIAL AND PROPRIETARY INFORMATION AND ALL DESIGN, MANUFACTURING, REPRODUCTION, USE, PATENT RIGHTS AND SALES RIGHTS ARE EXPRESSLY RESERVED BY SAMTEC, INC. THIS DOCUMENT SHALL NOT BE DISCLOSED, IN WHOLE OR PART, TO ANY UNAUTHORIZED PERSON OR ENTITY NOR REPRODUCED, TRANSFERRED OR INCORPORATED IN ANY OTHER PROJECT IN ANY MANNER WITHOUT THE EXPRESS WRITTEN CONSENT OF SAMTEC, INC.



520 PARK EAST BLVD, NEW ALBANY, IN 47150
 PHONE: 812-944-6733 FAX: 812-948-5047
 e-Mail: info@SAMTEC.com code: 55322

DO NOT SCALE DRAWING

SHEET SCALE: 1:0.666667

DESCRIPTION:
 .156 HI POWER SOCKET ASSEMBLY

DWG. NO.
FHP-XX-XX-XX-S-XX-XX-X-XX

BY: BRATCHER 03/01/99 SHEET 2 OF 2