

## 1. Features of PFC212236A Series :

- Alloy core is used to realize lower core loss.
- No thermal aging concerns.
- Low leakage magnetic flux.
- Elimination for impulse (EMI) noise.
- Superior roll off performance for Power Factor Correction Application.
- Also can be used as boost inductor in power supplies.
- Inductance Range: 105.0uH to 1000.0uH, custom values are welcomed.
- Foot Print: 53.9x31.0mm max. , 60.0 max. Height. Available without header.
- Operating Temperature Range: -55°C to + 130°C.
- RoHs & HF compliant.

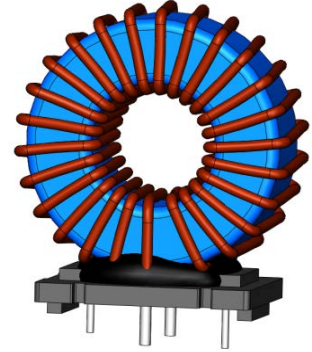

## 2. Electrical Characteristics of PFC212236A Series:

ITG Part Number	OCL <sup>1</sup>	DCR	Isat1 <sup>2</sup>	L@Isat1 <sup>2</sup>	Isat2 <sup>2</sup>	L@Isat2 <sup>2</sup>	Isat3 <sup>2</sup>	L@Isat3 <sup>2</sup>	Irms <sup>3</sup>	Dim. A	Dim. C	F2	H
	(uH) ± 10%	(mΩ) Max.	(A) @25°C	(uH) Min.	(A) @25°C	(uH) Min.	(A) @25°C	(uH) Min.	(A) @25°C	(mm) Max.	(mm) Max.	(mm) ± 0.1	(mm) Ref.
PFC212236A-101K	105.0	14.5	28.3	77.8	37.2	66.7	55.5	46.2	24.3	53.9	60.0	Φ2.0	Φ2.6
PFC212236A-201K	205.0	20.5	20.3	151.1	26.7	129.5	39.9	89.7	21.0	53.9	60.0	Φ2.0	Φ2.6
PFC212236A-251K	250.0	26.5	18.4	183.7	24.2	157.5	36.1	109.0	17.6	53.9	60.0	Φ1.8	Φ2.4
PFC212236A-351K	350.0	40.0	15.5	258.4	20.4	221.6	30.5	153.4	13.7	52.5	59.0	Φ1.5	Φ2.1
PFC212236A-471K	470.0	54.5	13.4	345.8	17.6	296.5	26.3	205.3	11.7	52.5	59.0	Φ1.4	Φ2.0
PFC212236A-501K	500.0	57.0	13.0	369.7	17.1	317.0	25.5	219.5	11.5	52.5	59.0	Φ1.4	Φ2.0
PFC212236A-681K	680.0	74.0	11.2	500.8	14.6	429.4	21.9	297.3	10.0	52.0	58.5	Φ1.3	Φ1.9
PFC212236A-821K	820.0	81.0	10.1	604.5	13.3	518.3	19.9	358.9	9.5	52.0	58.5	Φ1.3	Φ1.9
PFC212236A-102K	1000.0	106.5	9.2	734.8	12.1	630.1	18.0	436.3	8.3	52.0	58.5	Φ1.2	Φ1.8

### Notes:

1. Open Circuit Inductance (OCL) and L@Isat are measured at 10KHz,0.25V @ 25°C.
2. Isat1: DC current that causes inductance to drop 20%(Typ.) from OCL (Ta=25°C).  
Isat2: DC current that causes inductance to drop 30%(Typ.) from OCL (Ta=25°C).  
Isat3: DC current that causes inductance to drop 50%(Typ.) from OCL (Ta=25°C).
3. Irms: DC current that causes an approximate temperature rise (ΔT) of 40°C (Ta=25°C).
4. PIN 2 & 4 provided for mounting stability only.



Halogen Free

# PFC212236A Series



### 3. Mechanical Dimension of PFC212236A Series (Unit:mm):

A	B	C	D	E1	E2	E3	F1	F2	H
Max.	Max.	Max.	±1.0	±0.5	±0.5	±0.5	±0.1	±0.1	Ref.
See table above	31.00	See table above	5.00	15.00	15.00	22.00	Φ1.20	See table above	See table above

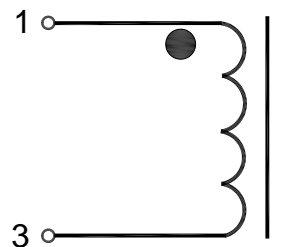
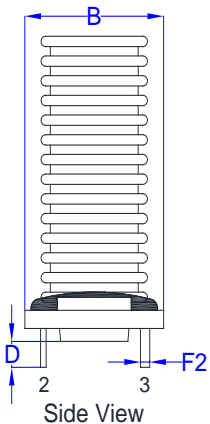
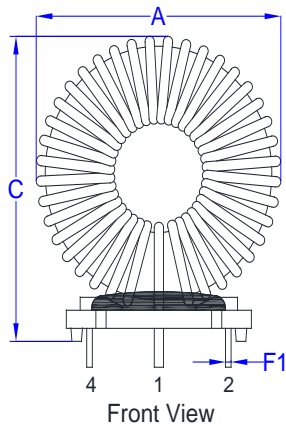

SCHEMATIC DIAGRAM

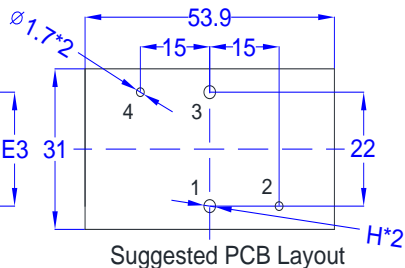
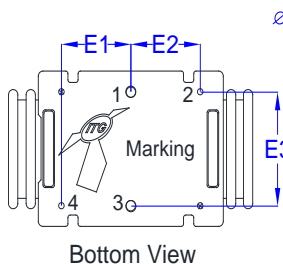

## 4. Inductance vs. Current Characteristics of PFC212236A Series :

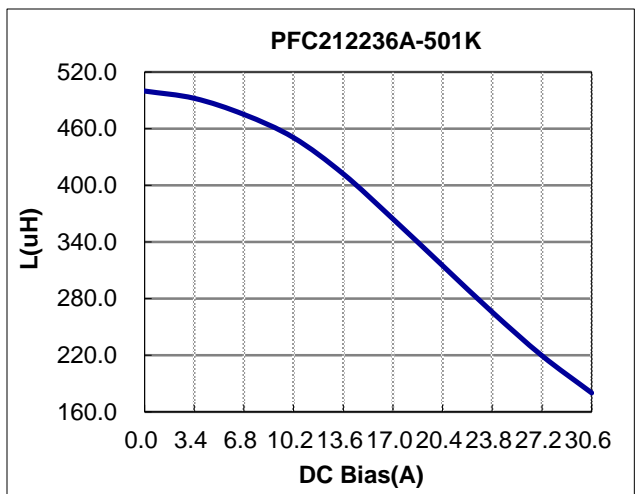
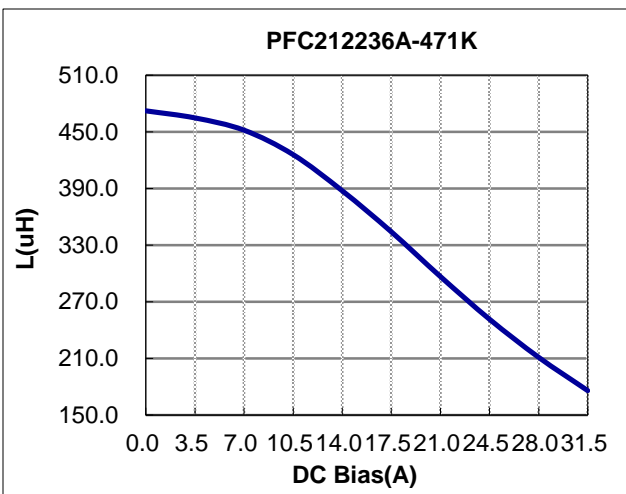
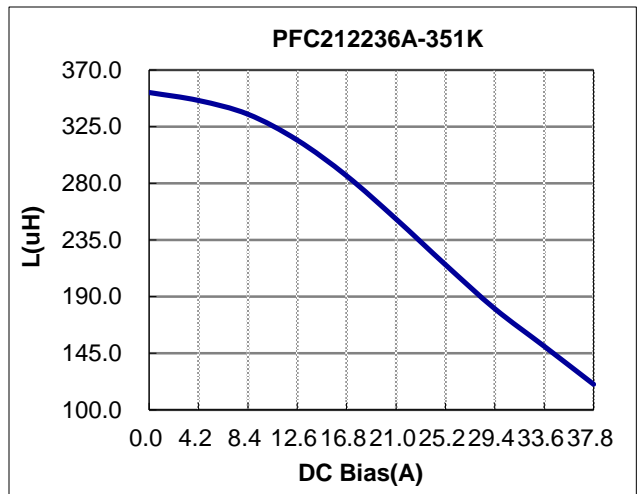
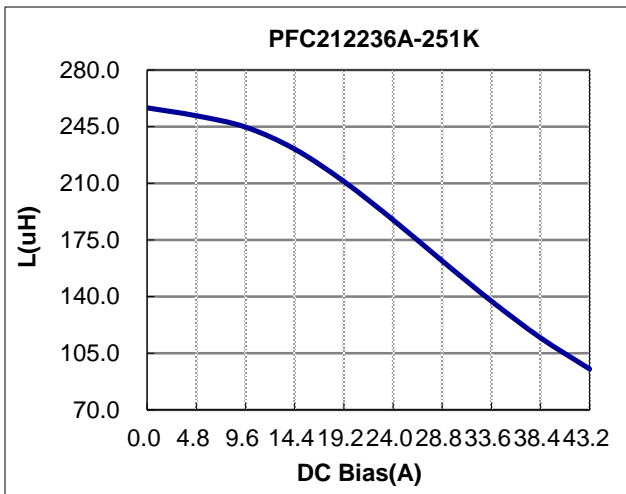
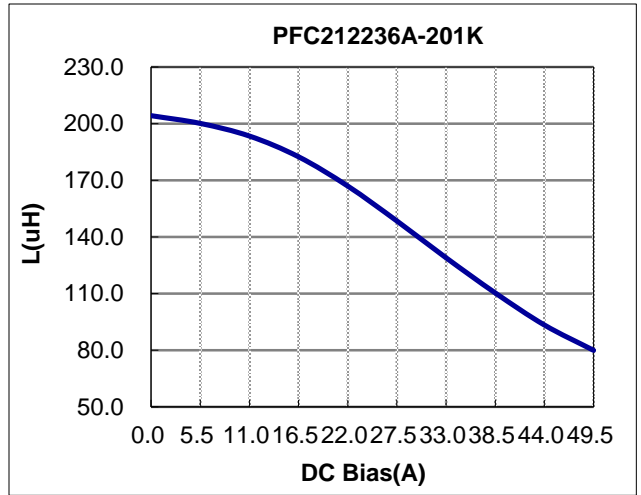
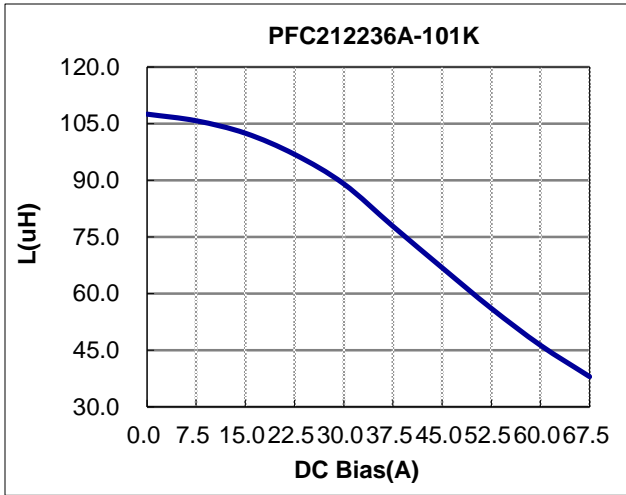



#### 4. Inductance vs. Current Characteristics of PFC212236A Series :

