

| Rev | AWO # | Description | Date    | Appr |
|-----|-------|-------------|---------|------|
| -   |       | RELEASED    | 4/11/08 |      |

APPROVED: \_\_\_\_\_  
 DATE: \_\_\_\_\_ TITLE: \_\_\_\_\_

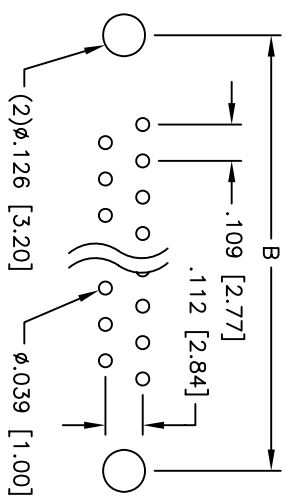

PCB LAYOUT

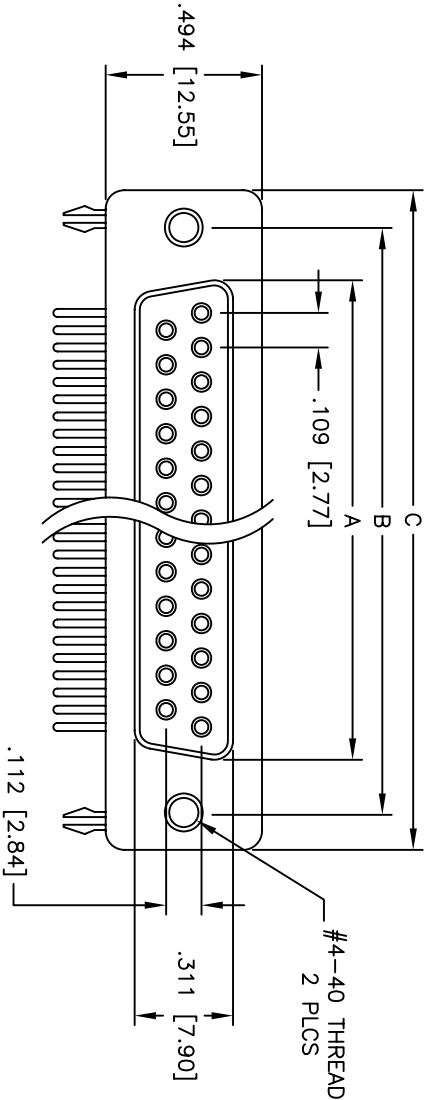
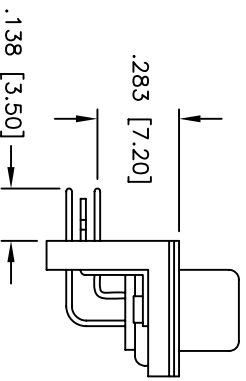
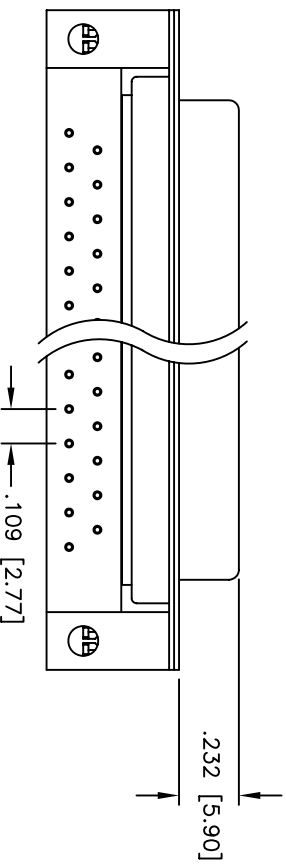

| DXXX | NO. OF CONTACTS | DIMENSIONS    |               |               |
|------|-----------------|---------------|---------------|---------------|
|      |                 | A             | B             | C             |
| DE09 | 9               | .643 [16.33]  | .984 [24.99]  | 1.213 [30.81] |
| DA15 | 15              | .971 [24.66]  | 1.312 [33.32] | 1.541 [39.14] |
| DB25 | 25              | 1.511 [38.38] | 1.852 [47.04] | 2.088 [53.04] |
| DC37 | 37              | 2.159 [54.84] | 2.500 [63.50] | 2.729 [69.32] |

# ADAM TECH

909 Rahway Avenue, Union, NJ 07083  
 Phone: 908-687-5000 Fax: 908-687-5710

TITLE: 283 [7.20] FOOTPRINT R/A D-SUB SOCKET  
 FORKED BOARDLOCKS, #4-40 INSERTS

**SPECIFICATIONS:**  
 Material: Insulator: PBT, glass reinforced, rated UL 94V-0  
 Insulator color: White  
 Contacts: Phosphor Bronze  
 Shell: Steel, Tin plated  
 Hardware: Brass, Nickel plated  
 Plating:  
 Gold flash over Nickel underplate overall  
 Electrical:  
 Operating voltage: 250 VAC max  
 Current rating: 5 Amps max  
 Contact resistance: 20 mohms max  
 Insulation resistance: 5,000 Mohms min  
 Dielectric withstanding voltage: 1,000 VAC for 1 minute  
 Temperature Rating:  
 Operating temperature: -65°C to +125°C  
 Environmental:  
 Lead free, RoHS compliant  
 Recommended soldering temp: 235°C for 5 seconds



UNLESS OTHERWISE SPECIFIED  
 ALL DIMENSIONS ARE INCHES [MM]  
 TOLERANCES: EXCEPT AS NOTED

|      |        |      |        |
|------|--------|------|--------|
| .X   | ± .10  | ØX   | ± .10  |
| .XX  | ± .020 | ØXXX | ± .015 |
| .XXX | ± .015 | ØXXX | ± .010 |

| APPROVALS | DATE |
|-----------|------|
| DRAWN     | SS   |
| CHECKED   |      |
| APPROVED  |      |

|      |             |              |
|------|-------------|--------------|
| SIZE | PART NO.    | REV.         |
| X    | DXXX-SH-C2A | -            |
| REF: | SCALE: NTS  | SHEET 1 OF 1 |