

TRB PLUG
PER MIL-STD-348
FIGURE 201-2
(AS APPLICABLE)

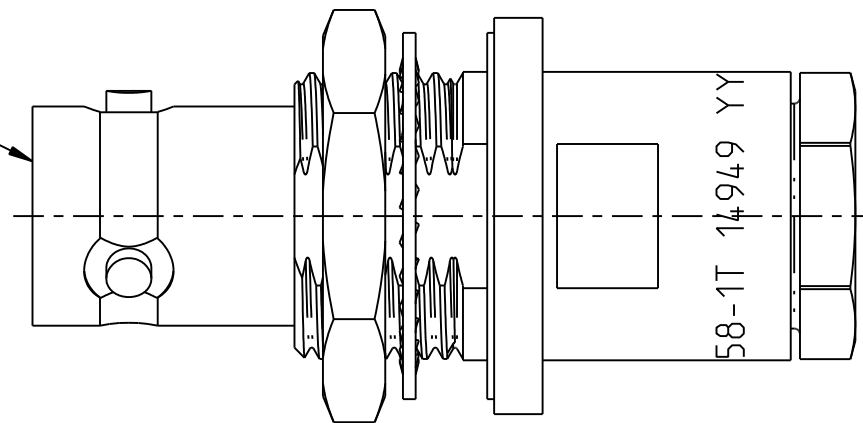

BJ79-58-1T SHOWN

NOTES: UNLESS OTHERWISE SPECIFIED (THIS PAGE)

1. MATERIAL & FINISH:

- 1.1 BODY, CONE & CLAMP NUT: TIN PLATED BRASS
- 1.2 INSULATORS & DIELECTRIC: PTFE (TEFLON)
- 1.3 INTERMEDIATE CONTACT: GOLD PLATED BRASS
- 1.4 CENTER CONTACT: GOLD PLATED BERYLLIUM COPPER
- 1.5 GASKET: SILICONE RUBBER
- 1.6 MOUNTING HARDWARE: TIN PLATED COPPER ALLOY

		TROMPETER	
		Title: TRB CABLE JACK, BULKHEAD MOUNT, WRENCH CRIMP	
<small>NOTICE: The information in this drawing is PROPRIETARY and must not be used without the permission of Cinch Connectivity Solutions. It may contain data whose export is restricted. Verify status prior to exporting.</small>	RoHS2 <input checked="" type="checkbox"/> 2011/65/EU	Model No. BJ79A-BBCC	
	<small>UNLESS OTHERWISE SPECIFIED UNITS: INCH</small> .XX ±.02 .XXX ±.010 ANGLES ±2°	Size B	DO NOT SCALE DRAWING
<small>INTERPRET DRAWING IN ACCORDANCE WITH ASME Y14.5-2018</small>			