

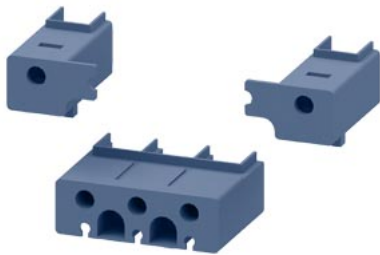





Terminal cover for box terminals, 4-pole, Contactor, Size S2



product brand name	SIRIUS
product designation	Cover
Substance Prohibitance (Date)	10/01/2014

Certificates/ approvals

General Product Approval	EMC	Declaration of Conformity
Confirmation  UL	 EAC	 RCM
		 UK CA
		 CE <small>EG-Konf.</small>

Marine / Shipping	other
-------------------	-------

 BUREAU VERITAS	 DNV	 PRS	 RMRS	Environmental Con- firmations	Confirmation
--	--	--	---	---	------------------------------

Further information

- Information- and Downloadcenter (Catalogs, Brochures,...)
<https://www.siemens.com/ic10>
- Industry Mall (Online ordering system)
<https://mall.industry.siemens.com/mall/en/en/Catalog/product?mlfb=3RT2936-4EA4>
- Cax online generator
<http://support.automation.siemens.com/WW/CAXorder/default.aspx?lang=en&mlfb=3RT2936-4EA4>
- Service&Support (Manuals, Certificates, Characteristics, FAQs,...)
<https://support.industry.siemens.com/cs/ww/en/ps/3RT2936-4EA4>
- Image database (product images, 2D dimension drawings, 3D models, device circuit diagrams, EPLAN macros, ...)
http://www.automation.siemens.com/bilddb/cax_de.aspx?mlfb=3RT2936-4EA4&lang=en
- Characteristic: Tripping characteristics, I²t, Let-through current
<https://support.industry.siemens.com/cs/ww/en/ps/3RT2936-4EA4/char>
- Further characteristics (e.g. electrical endurance, switching frequency)
<http://www.automation.siemens.com/bilddb/index.aspx?view=Search&mlfb=3RT2936-4EA4&objecttype=14&gridview=view1>

last modified: 12/21/2020 