

OGP280

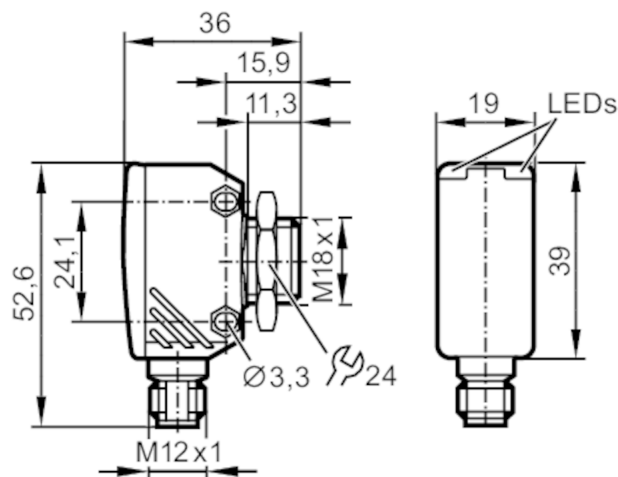

Retro-reflective sensor

OGP-DPKG/US/CUBE



Product characteristics

| | |
|---------------|-----------------------------|
| Type of light | red light |
| Housing | rectangular with M18 thread |

Application

| | |
|--------------------|-------------------------|
| Special feature | polarisation filter |
| Function principle | Retro-reflective sensor |

Electrical data

| | | |
|-----------------------------|------|---|
| Operating voltage | [V] | 10...30 DC; ("supply class 2" to cULus) |
| Rated insulation voltage | [V] | 32 |
| Current consumption | [mA] | 21 |
| Protection class | | III |
| Reverse polarity protection | | yes |
| Max. power-on delay time | [ms] | 300 |
| Type of light | | red light |
| Wave length | [nm] | 662 |

Outputs

| | | |
|---|------|--------------|
| Electrical design | | PNP |
| Output function | | dark-on mode |
| Max. voltage drop switching output DC | [V] | 2.5 |
| Permanent current rating of switching output DC | [mA] | 200 |
| Switching frequency DC | [Hz] | 1000 |
| Short-circuit protection | | yes |
| Type of short-circuit protection | | pulsed |

Detection zone

| | | |
|---------------------------------------|-----|--|
| Range referred to prismatic reflector | [m] | 0.1...4; (Prismatic reflector Ø 80 E20005) |
|---------------------------------------|-----|--|



Retro-reflective sensor

OGP-DPKG/US/CUBE

| | | |
|--------------------------------|------|------------------|
| Max. light spot diameter | [mm] | 160 |
| Light spot dimensions refer to | | at maximum range |
| Polarisation filter available | | yes |

| Interfaces | | |
|---------------------------------|---|------------|
| Communication interface | IO-Link | |
| Transmission type | COM2 (38,4 kBaud) | |
| IO-Link revision | 1.1 | |
| SDCI standard | IEC 61131-9 | |
| Profiles | Smart Sensor: Device Identification; Device Diagnosis; Teach Channel; Switching Channel | |
| SIO mode | yes | |
| Required master port type | A | |
| Min. process cycle time | [ms] | 2.5 |
| IO-Link process data (cyclical) | function | bit length |
| | device status | 4 |
| | binary switching information | 1 |
| IO-Link functions (acyclical) | application specific tag; operating hours counter; switching cycles counter | |
| Supported DeviceIDs | Type of operation | DeviceID |
| | Default | 1134 |
| Note | For further information please see the IODD PDF file under "Downloads" | |

| Operating conditions | | |
|----------------------|------|--------------|
| Ambient temperature | [°C] | -25...60 |
| Storage temperature | [°C] | -40...60 |
| Protection | | IP 65; IP 67 |

| Tests / approvals | | |
|-------------------|----------------|-------------|
| EMC | EN 60947-5-2 | |
| MTTF | [years] | 905 |
| UL approval | Ta | -25...60 °C |
| | Enclosure type | Type 1 |
| | power supply | Class 2 |
| | File number UL | E174191 |

| Mechanical data | | |
|--------------------|------|-----------------------------|
| Weight | [g] | 58.5 |
| Housing | | rectangular with M18 thread |
| Dimensions | [mm] | 52.6 x 19 x 36 |
| Thread designation | | M18 x 1 |
| Materials | | diecast zinc; PEI |
| Lens material | | PMMA |
| Lens alignment | | side lens |

| Displays / operating elements | | |
|-------------------------------|------------------|-----------------|
| Display | switching status | 1 x LED, yellow |
| | operation | 1 x LED, green |

| Accessories | |
|----------------|-------------|
| Items supplied | lock nut: 1 |

| Remarks | |
|---------|---|
| Remarks | operating voltage "supply class 2" according to cULus |

OGP280



Retro-reflective sensor

OGP-DPKG/US/CUBE

Pack quantity

1 pcs.

Electrical connection

Connector: 1 x M12; coding: A



Connection

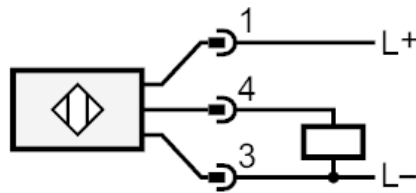

Retro-reflective sensor

OGP-DPKG/US/CUBE

Diagrams and graphs

excess gain graph

