

KT5150

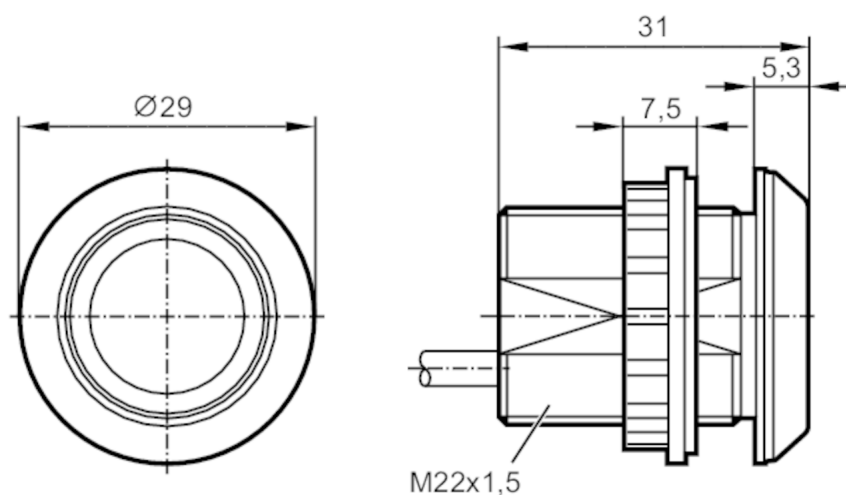

Capacitive illuminated pushbutton

KTMBF-KRGBPKG/2M



Product characteristics

Electrical design	PNP
Output function	normally open
Dimensions [mm]	Ø 29 / L = 31

Application

Operating principle	bistable
---------------------	----------

Electrical data

Operating voltage [V]	12...30 DC
Current consumption [mA]	30
Protection class	III
Reverse polarity protection	yes
Max. power-on delay time [ms]	500

Outputs

Electrical design	PNP
Output function	normally open
Permanent current rating of switching output DC [mA]	200
Short-circuit protection	yes
Overload protection	yes

Response times

Response time [ms]	35
--------------------	----

Operating conditions

Ambient temperature [°C]	-40...85
Protection	IP 65; IP 67; IP 69K; (on the front)

Tests / approvals

EMC	IEC 61000-4
-----	-------------

KT5150



Capacitive illuminated pushbutton

KTMBF-KRGBPKG/2M

Mechanical data

Weight	[g]	99
Dimensions	[mm]	Ø 29 / L = 31
Materials	PA 6.6-GF30 black; active face: PA Grilamid TR 90UV	

Displays / operating elements

Display	switching status	1 x LED, green
	function	1 x LED, red can be triggered

Accessories

Items supplied	lock nuts: 1
	Gasket: 1
Accessories (optional)	symbol disc

Remarks

Pack quantity	1 pcs.
---------------	--------

Electrical connection

Cable: 2 m, PUR

Connection

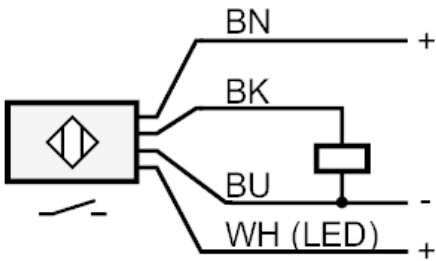

	Core colours :
BK =	black
BN =	brown
BU =	blue
WH =	white