

# KT5106

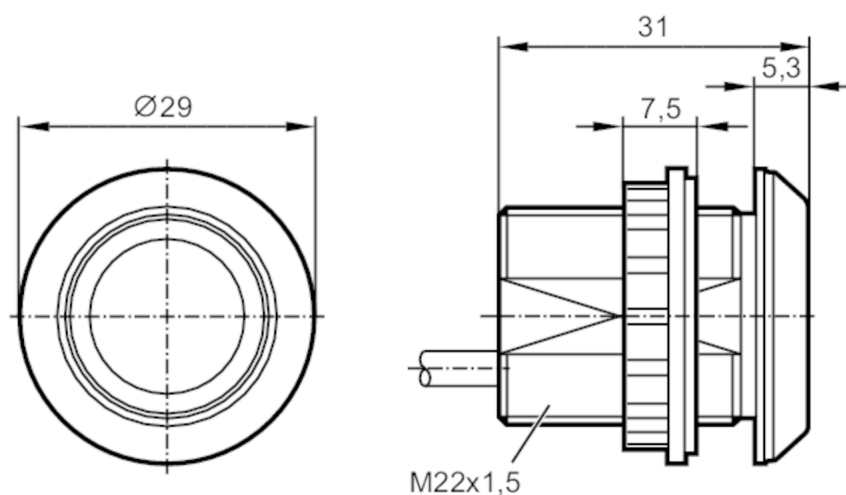

## Capacitive illuminated pushbutton

KTMSF-K-RBPKG/US/0,3M



### Product characteristics

Electrical design	PNP
Output function	normally open
Dimensions [mm]	Ø 29 / L = 31

### Application

Operating principle	static
---------------------	--------

### Electrical data

Operating voltage [V]	12...30 DC
Current consumption [mA]	30
Protection class	III
Reverse polarity protection	yes
Max. power-on delay time [ms]	500

### Outputs

Electrical design	PNP
Output function	normally open
Permanent current rating of switching output DC [mA]	200
Short-circuit protection	yes
Overload protection	yes

### Response times

Response time [ms]	35
--------------------	----

### Operating conditions

Ambient temperature [°C]	-40...85
Protection	IP 65; IP 67; IP 69K; (on the front)

### Tests / approvals

MTTF [years]	352
--------------	-----

# KT5106



## Capacitive illuminated pushbutton

KTMSF-K-RBPKG/US/0,3M

Mechanical data		
Weight	[g]	55.5
Dimensions	[mm]	Ø 29 / L = 31
Materials	PA 6.6-GF30 black; active face: PA Grilamid TR 90UV	

Displays / operating elements		
Display	switching status	1 x LED, red
	operation	1 x LED, green

Accessories		
Items supplied	lock nuts: 1	
	Gasket: 1	
Accessories (optional)	symbol disc	

Remarks		
Pack quantity	1 pcs.	

Electrical connection - plug		
Cable: 0.3 m, PUR		
Connector: 1 x M12; coding: A		



## Connection

