

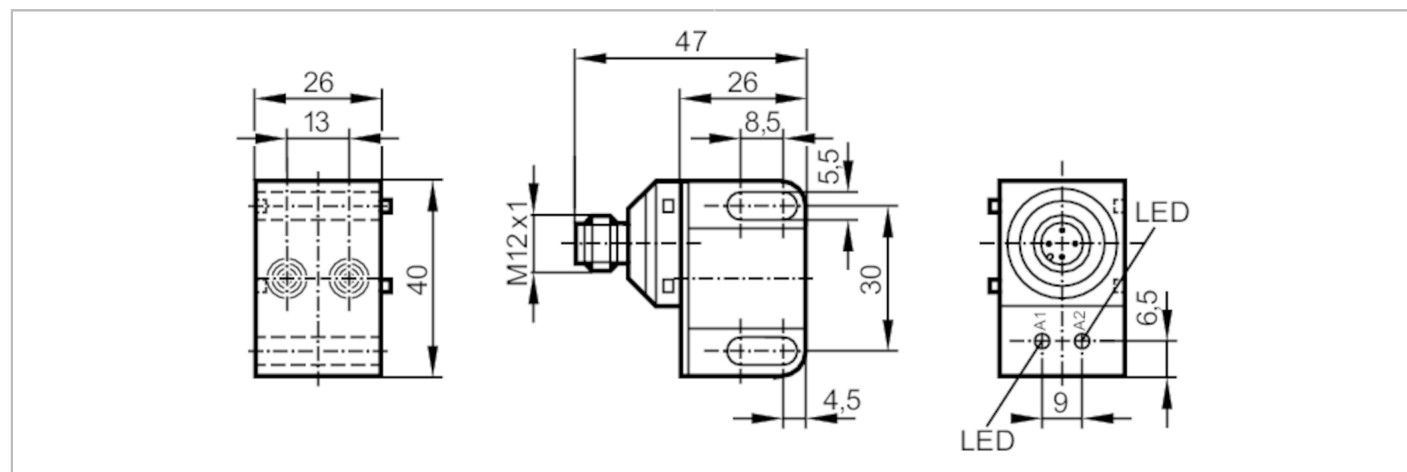

## Inductive dual sensor for valve actuators

IND3004DBPKG/US-100-DPV



## Product characteristics

Electrical design	PNP
Output function	2 x normally open
Sensing range [mm]	4
Housing	rectangular
Dimensions [mm]	40 x 26 x 47

## Application

Special feature	Gold-plated contacts
-----------------	----------------------

## Electrical data

Operating voltage [V]	10...36 DC
Current consumption [mA]	15; (24 V)
Protection class	II
Reverse polarity protection	yes

## Outputs

Electrical design	PNP
Output function	2 x normally open
Max. voltage drop switching output DC [V]	2.5
Permanent current rating of switching output DC [mA]	250
Switching frequency DC [Hz]	1300
Short-circuit protection	yes
Type of short-circuit protection	pulsed
Overload protection	yes

## Detection zone

Sensing range [mm]	4
Real sensing range $S_r$ [mm]	$4 \pm 10 \%$
Operating distance [mm]	0...3.25



## Inductive dual sensor for valve actuators

IND3004DBPKG/US-100-DPV

Accuracy / deviations			
Correction factor		steel: 1 / stainless steel: 0.7 / brass: 0.4 / aluminium: 0.3 / copper: 0.2	
Hysteresis	[% of Sr]	1...15	
Switch point drift	[% of Sr]	-10...10	
Operating conditions			
Ambient temperature		[°C]	-25...80
Protection			IP 67
Tests / approvals			
EMC		EN 60947-5-2	
		EN 55011	class B
MTTF	[years]	1064	
UL approval		Ta	0...40 °C
		Enclosure type	Type 1
		power supply	Hazardous voltage
		File number UL	E174191
Mechanical data			
Weight		[g]	57
Housing		rectangular	
Mounting		non-flush mountable	
Dimensions		[mm]	40 x 26 x 47
Materials		housing: PBT	
Displays / operating elements			
Display		switching status	2 x LED, yellow
Remarks			
Pack quantity		1 pcs.	
Electrical connection - plug			
Connector: 1 x M12; coding: A; Moulded body: stainless steel; Contacts: gold-plated			
<div></div>			

# IN5327



## Inductive dual sensor for valve actuators

IND3004DBPKG/US-100-DPV

### Connection

