

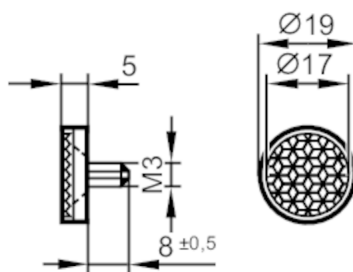

Reflector for retro-reflective laser sensors

REFLECTOR LASER TS-19



1 M3 8 mm deep

Application

Design	round, for retro-reflective laser sensors, M3
--------	---

Operating conditions

Ambient temperature	[°C]	-10...60
---------------------	------	----------

Mechanical data

Weight	[g]	3
Dimensions	[mm]	Ø 19 / L = 5
Reflector surface	[mm]	Ø 17
Materials	screw: stainless steel (316 / 1.4401); Spring washer: stainless steel (316 / 1.4401); nut: stainless steel (316 / 1.4401); front panel: PMMA; base: ABS	

Remarks

Pack quantity	1 pcs.
---------------	--------