

THIS PRODUCT MANUFACTURED WITH LEAD-FREE PROCESSING

DESIGNED & DIMENSIONED IN MILLIMETERS[INCHES]

BE23S-XXXXX-XX-XX-XXXX

DO NOT SCALE FROM THIS PRINT

PATENT NUMBER 7,544,093

CABLE CALLOUT END 1
23S: MWC-2350-01 CABLE, WITH PRB3-P-C-XX-ST-CS3 CONNECTOR (SEE FIG 4, SHT 4)

OVERALL CABLE LENGTH (MILLIMETERS)
0100-9999 [3.9 - 393.7] (SEE NOTE 4)

END 2 CONNECTOR
(SEE TABLE 1, SHT 2)

No. OF PHASE MATCHED CABLES
-02: (2 CABLES FOR THIS PART NUMBER)
-04: (4 CABLES FOR THIS PART NUMBER)
-06: (6 CABLES FOR THIS PART NUMBER)
-08: (8 CABLES FOR THIS PART NUMBER)

PHASE MATCHING SPEC (RANGE)
Ⓢ-02: 2.0 PICO-SECOND
-05: 5.0 PICO-SECONDS
-10: 10.0 PICO-SECONDS (SEE NOTE 5)

TABLE 2	
OVERALL LENGTH	"A"
0100-0200 [3.94-7.87]	+3.0 [.12]/-0.0 [.00]
0201-0500 [7.91-19.69]	+5.0 [.20]/-0.0 [.00]
0501-1100 [19.72-43.30]	+10.0 [.40]/-0.0 [.00]

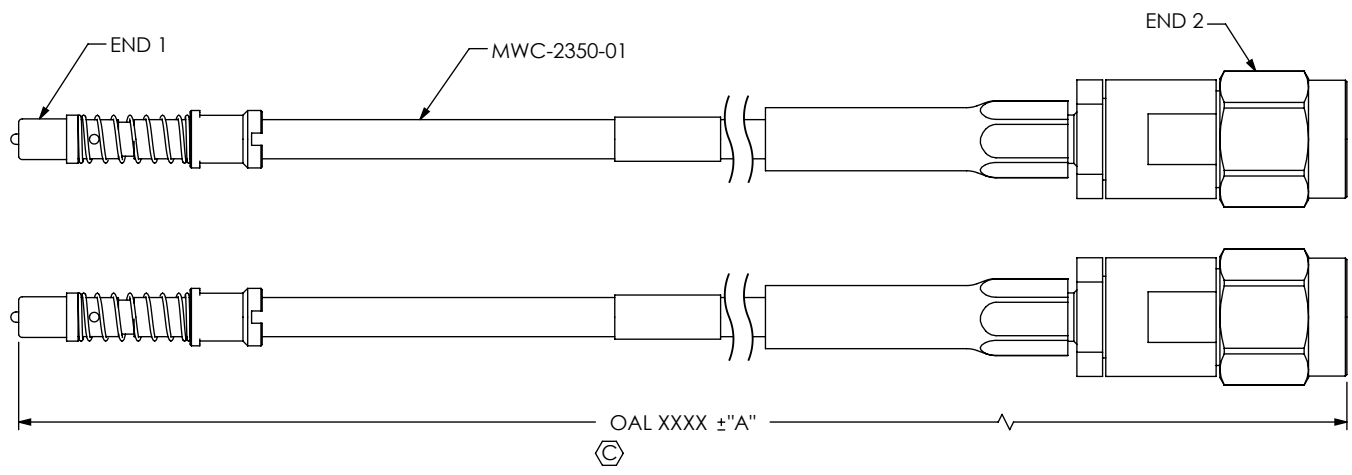

FIG 1
BE23S-92SPP-XX-02-XXXX SHOWN

F:\DWG\MISC\MKTG\BE23S-XXXX-XX-XX-XXXX-MKT.SLDDRW

UNLESS OTHERWISE SPECIFIED, DIMENSIONS ARE IN MILLIMETERS [INCHES]. TOLERANCES ARE:
DECIMALS ANGLES
.X: ±0.3 [.01] 5°
.XX: ±0.13 [.005]
.XXX: ±0.051 [.0020]

PROPRIETARY NOTE
THIS DOCUMENT CONTAINS CONFIDENTIAL AND PROPRIETARY INFORMATION AND ALL DESIGN, MANUFACTURING, REPRODUCTION, USE, PATENT RIGHTS AND SALES RIGHTS ARE EXPRESSLY RESERVED BY SAMTEC, INC. THIS DOCUMENT SHALL NOT BE DISCLOSED, IN WHOLE OR PART, TO ANY UNAUTHORIZED PERSON OR ENTITY NOR REPRODUCED, TRANSFERRED OR INCORPORATED IN ANY OTHER PROJECT IN ANY MANNER WITHOUT THE EXPRESS WRITTEN CONSENT OF SAMTEC, INC.

MATERIAL: DO NOT SCALE DRAWING SHEET SCALE: 2:1

INSULATORS: PTFE (SCC31) PCTFE OR ULTEM-1000(OTHERS)
GASKETS: SILICONE
INNER PIN, RETAINER, FERRULE, NUT: BRASS
C-RING: STAINLESS STEEL
SHELLS, INSERT, CABLE BODY, SPRING: BRASS OR STAINLESS STEEL



520 PARK EAST BLVD, NEW ALBANY, IN 47150
PHONE: 812-944-6733 FAX: 812-948-5047
e-Mail: info@SAMTEC.com code: 55322

DESCRIPTION:
BULLSEYE 23 AWG CABLE ASSEMBLY

DWG. NO.
BE23S-XXXXX-XX-XX-XXXX

BY:EMMA CHEN 3/10/2014 SHEET 1 OF 7

- NOTES:
- Ⓢ REPRESENTS A CRITICAL DIMENSION
 - ASSEMBLY TO BE 100% TESTED FOR OPENS, SHORTS & HI-POT TESTED (PER TABLE 3, AC OR DC), THE HI-POT VOLTAGE FOR THE ASSEMBLY SHOULD BE SET TO THE END OPTION WITH THE LOWEST TEST VOLTAGE RATING.
 - CABLE ASSEMBLY TO HAVE PROTECTIVE CAP ASSEMBLED ON EACH END AND TO BE INDIVIDUALLY PACKAGED IN ESD BAG (BG-09-12).
 - CABLE LENGTHS LONGER THAN 1000 MILLIMETERS ARE NOT SUPPORTED BY S.I. TEST DATA
 - PARTS TO BE PHASE MATCHED PER CO-HD-WI-3062-M.
 - FERRULE AND SPRING ARE FREE FLOATING AND ARE NOT STATIONARY.

PATENT NUMBER
7,544,093

TABLE 1

END 2 OPTION	SERIES	GENDER	CONFIGURATION	PLATING			FIGURE
				CENTER CONTACT	OUTER CONTACT	OTHER COMPONENTS	
-92SJP	2.92 MM	JACK	STRAIGHT	30μ" GOLD	STAINLESS STEEL	3μ" GOLD	SHT 3, FIG 2
-92SPP	2.92 MM	PLUG	STRAIGHT	30μ" GOLD	STAINLESS STEEL	3μ" GOLD	SHT 3, FIG 3
-SCC31	Bull's Eye ©	PLUG	STRAIGHT	30μ" GOLD	3μ" GOLD	3μ" GOLD	SHT 4, FIG 4
-35SJP	3.50 MM	JACK	STRAIGHT	30μ" GOLD	STAINLESS STEEL	3μ" GOLD	SHT 4, FIG 5
-35SPP	3.50 MM	PLUG	STRAIGHT	30μ" GOLD	STAINLESS STEEL	3μ" GOLD	SHT 5, FIG 6

TABLE 3

END OPTION	SUBTRACTOR	STRIP DIMENSIONS				HI POT	
		"Y"	"B"	"C"	"D"	"DC"	"AC"
-92SJP	7.7 [0.30]	2.25 [0.089]	3.25 [0.128]	6.75 [0.266]	1000	1000	
-92SPP	8.4 [0.33]	2.25 [0.089]	3.25 [0.128]	6.75 [0.266]	1000	1000	
-SCC31	1.7 [0.07]	2.16 [0.085]	2.16 [0.085]	5.94 [0.234]	1000	750	
-35SJP	8.3 [0.33]	1.65 [0.065]	2.45 [0.096]	5.95 [0.234]	1000	1000	
-35SPP	9.2 [0.36]	1.65 [0.065]	2.45 [0.096]	5.95 [0.234]	1000	1000	

F:\DWG\MISC\MKTG\BE23S-XXXX-XX-XX-XXXX-MKT.SLDDRW

PROPRIETARY NOTE
THIS DOCUMENT CONTAINS CONFIDENTIAL AND PROPRIETARY INFORMATION AND ALL DESIGN, MANUFACTURING, REPRODUCTION, USE, PATENT RIGHTS AND SALES RIGHTS ARE EXPRESSLY RESERVED BY SAMTEC, INC. THIS DOCUMENT SHALL NOT BE DISCLOSED, IN WHOLE OR PART, TO ANY UNAUTHORIZED PERSON OR ENTITY NOR REPRODUCED, TRANSFERRED OR INCORPORATED IN ANY OTHER PROJECT IN ANY MANNER WITHOUT THE EXPRESS WRITTEN CONSENT OF SAMTEC, INC.

DO NOT SCALE DRAWING

SHEET SCALE: 1:1



520 PARK EAST BLVD, NEW ALBANY, IN 47150
PHONE: 812-944-6733 FAX: 812-948-5047
e-Mail: info@SAMTEC.com code: 55322

DESCRIPTION:
BULLSEYE 23 AWG CABLE ASSEMBLY

DWG. NO.
BE23S-XXXX-XX-XX-XXXX

BY:EMMA CHEN 3/10/2014 SHEET 2 OF 7

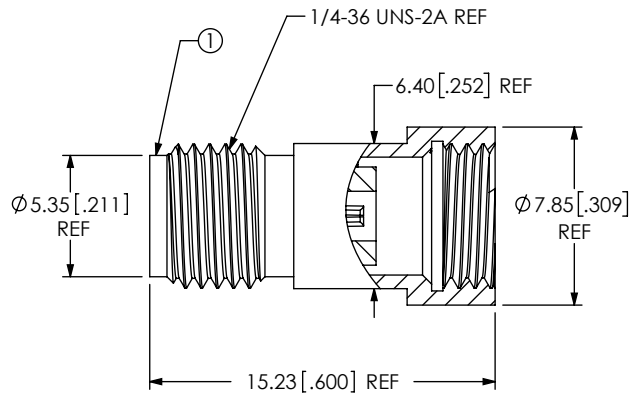
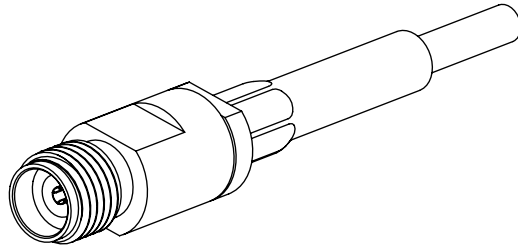
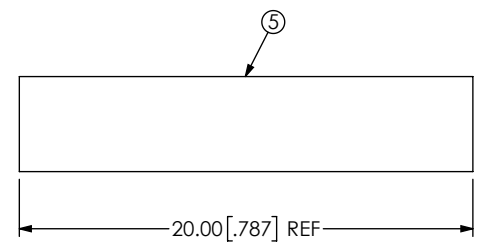
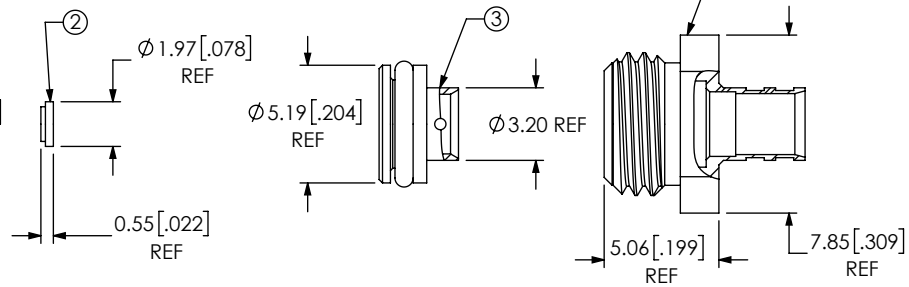

FIG 2
-92SJP SHOWN



BOM		
ITEM	COMPONENT	-HP
1	SUB ASSEMBLY	SUB-292PS-J-C-HP-ST-CS3
2	INSULATOR	292-ST-INS-CS3
3	SUB CABLE BODY	SUB-292-C-F-ST-CS3-CBDY
4	BODY	292PS-C-P-ST-CA7-BDY
5	HEAT SHRINK	HST-0.125-02-BLK-A

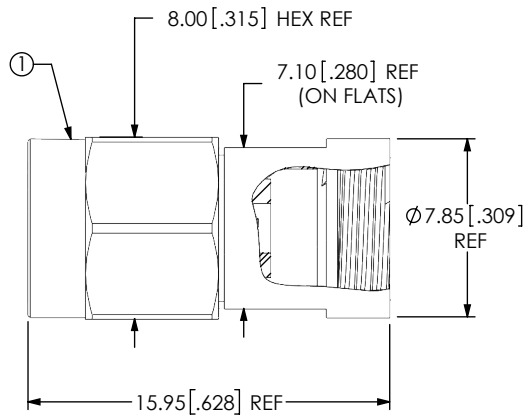
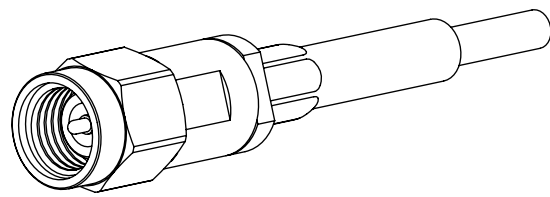
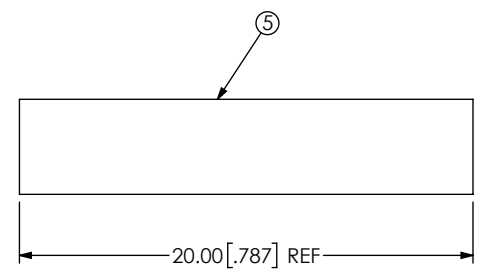
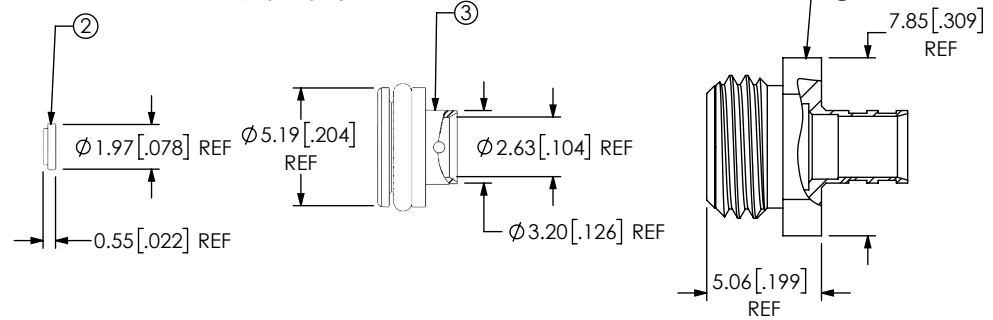

FIG 3
-92SPP SHOWN



BOM		
ITEM	COMPONENT	-HP
1	SUB ASSEMBLY	SUB-292PS-P-C-HP-ST-CS3
2	INSULATOR	292-ST-INS-CS3
3	SUB CABLE BODY	SUB-292-C-F-ST-CS3-CBDY
4	BODY	292PS-C-P-ST-CA7-BDY
5	HEAT SHRINK	HST-0.125-02-BLK-A

PROPRIETARY NOTE
THIS DOCUMENT CONTAINS CONFIDENTIAL AND PROPRIETARY INFORMATION AND ALL DESIGN, MANUFACTURING, REPRODUCTION, USE, PATENT RIGHTS AND SALES RIGHTS ARE EXPRESSLY RESERVED BY SAMTEC, INC. THIS DOCUMENT SHALL NOT BE DISCLOSED, IN WHOLE OR PART, TO ANY UNAUTHORIZED PERSON OR ENTITY NOR REPRODUCED, TRANSFERRED OR INCORPORATED IN ANY OTHER PROJECT IN ANY MANNER WITHOUT THE EXPRESS WRITTEN CONSENT OF SAMTEC, INC.

DO NOT SCALE DRAWING
SHEET SCALE: 3:1

samtec
520 PARK EAST BLVD, NEW ALBANY, IN 47150
PHONE: 812-944-6733 FAX: 812-948-5047
e-Mail: info@SAMTEC.com code: 55322

DESCRIPTION:
BULLSEYE 23 AWG CABLE ASSEMBLY

DWG. NO.
BE23S-XXXXX-XX-XX-XXXX

BY:EMMA CHEN 3/10/2014 SHEET 3 OF 7

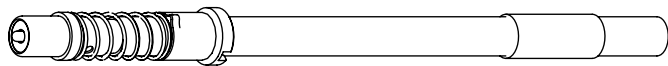
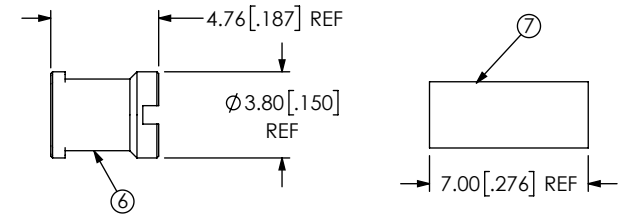
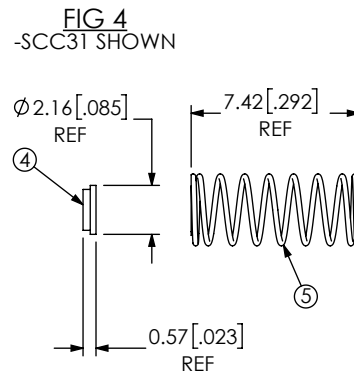
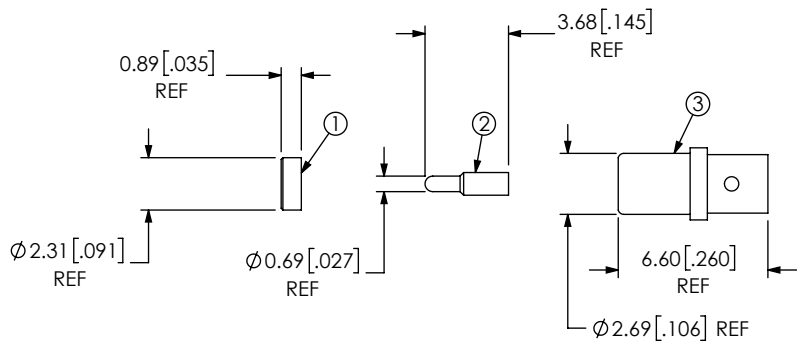

BOM		
ITEM	COMPONENT	-HF
1	INSULATOR 1	PRB3-INS-003
2	PIN	PRB3-PIN-002-H
3	FERRULE	PRB3-FER-002-F
4	RETAINER	PRB3-RET-002-F
5	SPRING	PRB3-SPR-002
6	INSULATOR 2	PRB3-INS-004
7	HEAT SHRINK	HST-0.125-02-BLK

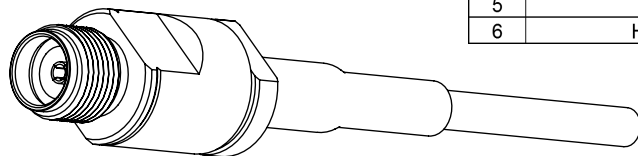
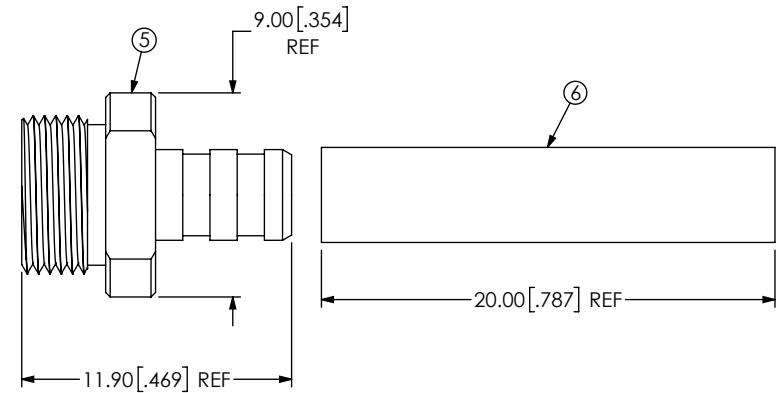
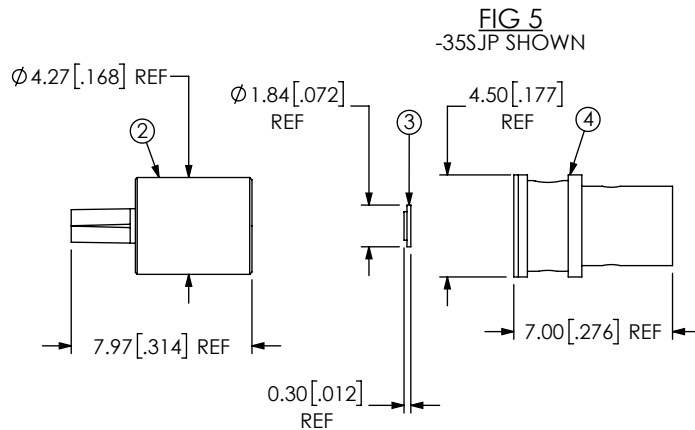
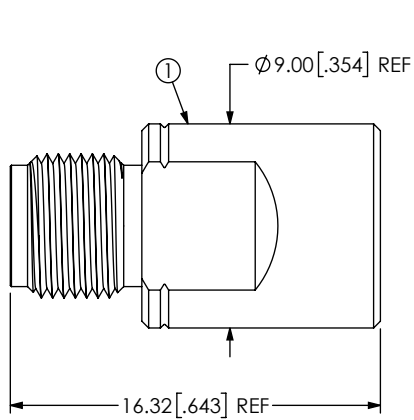

BOM		
ITEM	COMPONENT	-HP
1	SHELL	350-J-C-P-ST-CS3-SHL
2	SUB SOCKET ASSEMBLY	SUB-350-J-C-HP-ST-CS3-SKT
3	INSULATOR	350-ST-CS3-INS
4	CABLE BODY	350-C-F-ST-CS3-CBDY
5	BODY	350-C-P-ST-CS3-BDY
6	HEAT SHRINK	HST-0.125-02-BLK-A

PROPRIETARY NOTE
THIS DOCUMENT CONTAINS CONFIDENTIAL AND PROPRIETARY INFORMATION AND ALL DESIGN, MANUFACTURING, REPRODUCTION, USE, PATENT RIGHTS AND SALES RIGHTS ARE EXPRESSLY RESERVED BY SAMTEC, INC. THIS DOCUMENT SHALL NOT BE DISCLOSED, IN WHOLE OR PART, TO ANY UNAUTHORIZED PERSON OR ENTITY NOR REPRODUCED, TRANSFERRED OR INCORPORATED IN ANY OTHER PROJECT IN ANY MANNER WITHOUT THE EXPRESS WRITTEN CONSENT OF SAMTEC, INC.

DO NOT SCALE DRAWING

SHEET SCALE: 3:1



520 PARK EAST BLVD, NEW ALBANY, IN 47150
PHONE: 812-944-6733 FAX: 812-948-5047
e-Mail: info@SAMTEC.com code: 55322

DESCRIPTION:
BULLSEYE 23 AWG CABLE ASSEMBLY

DWG. NO.
BE23S-XXXXX-XX-XX-XXXX

BY:EMMA CHEN 3/10/2014 SHEET 4 OF 7

FIG 6
-35SPP SHOWN

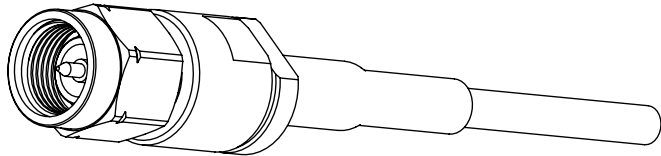
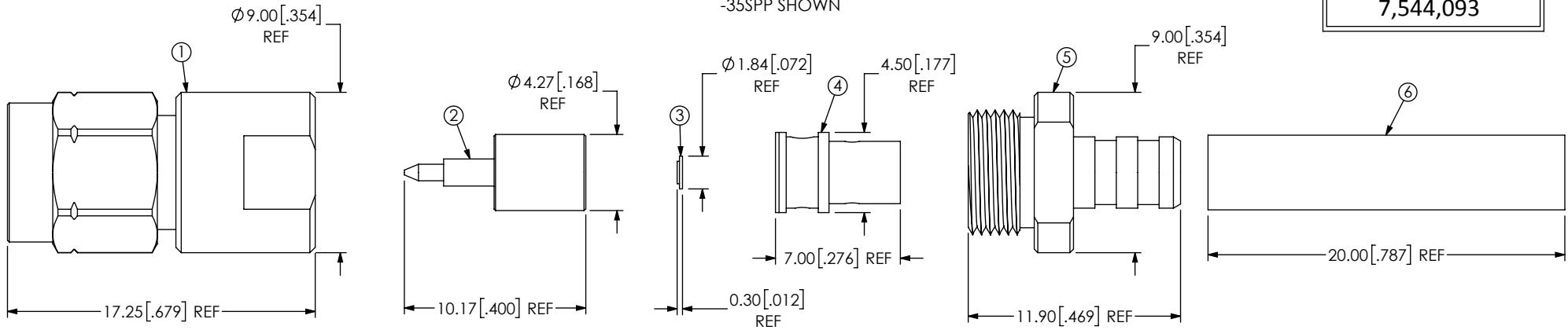

BOM		
ITEM	COMPONENT	-HP
1	SUB SHELL ASSEMBLY	SUB-350-P-C-P-ST-CS3-SHL
2	SUB PIN ASSEMBLY	SUB-350-P-C-HP-ST-CS3-PIN
3	INSULATOR	350-ST-CS3-INS
4	CABLE BODY	350-C-F-ST-CS3-CBDY
5	BODY	350-C-P-ST-CS3-BDY
6	HEAT SHRINK	HST-0.125-02-BLK-A

PROPRIETARY NOTE
THIS DOCUMENT CONTAINS CONFIDENTIAL AND PROPRIETARY INFORMATION AND ALL DESIGN, MANUFACTURING, REPRODUCTION, USE, PATENT RIGHTS AND SALES RIGHTS ARE EXPRESSLY RESERVED BY SAMTEC, INC. THIS DOCUMENT SHALL NOT BE DISCLOSED, IN WHOLE OR PART, TO ANY UNAUTHORIZED PERSON OR ENTITY NOR REPRODUCED, TRANSFERRED OR INCORPORATED IN ANY OTHER PROJECT IN ANY MANNER WITHOUT THE EXPRESS WRITTEN CONSENT OF SAMTEC, INC.



520 PARK EAST BLVD, NEW ALBANY, IN 47150
PHONE: 812-944-6733 FAX: 812-948-5047
e-Mail: info@SAMTEC.com code: 55322

DO NOT SCALE DRAWING

SHEET SCALE: 3:1

DESCRIPTION:
BULLSEYE 23 AWG CABLE ASSEMBLY

DWG. NO.
BE23S-XXXXX-XX-XX-XXXX

BY: EMMA CHEN 3/10/2014 SHEET 5 OF 7

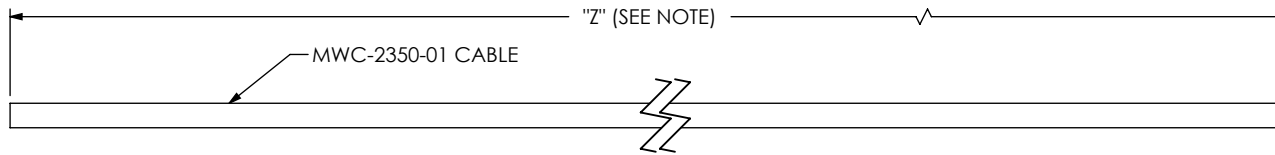

IN PROCESS 1
CUT CABLE TO LENGTH

NOTE: "Z" = OAL - 1.70[.067] - "Y"(END 2)

(Bull's Eye ®)
IN PROCESS 2
STRIP AND LOCATE JACKET

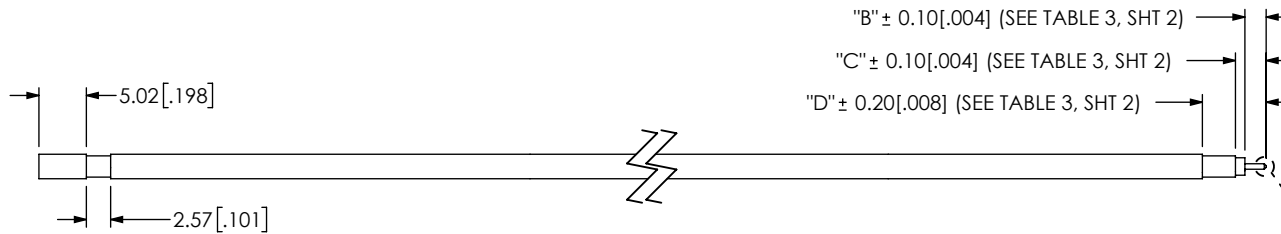

IN PROCESS 2
STRIP CABLE &
CHAMFER CENTER CONDUCTOR

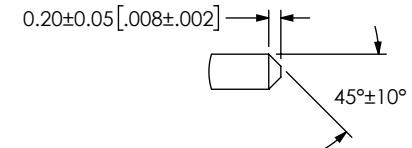

DETAIL 'A'
SCALE 8 : 1

IN PROCESS 3
STRIP AND TIN INNER CONDUCTOR,
REMOVE CUT JACKET

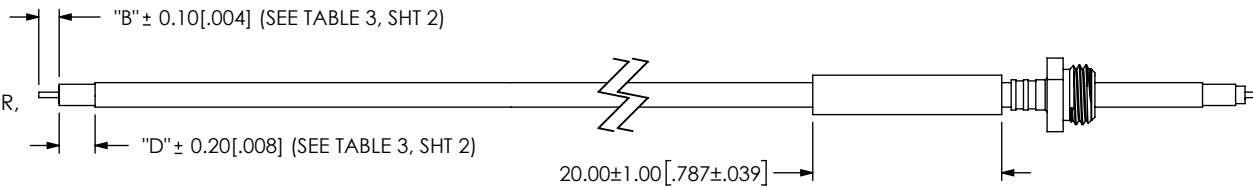

IN PROCESS 3
ADD BODY & HEAT SHRINK

IN PROCESS 4
ADD RETAINER, SPRING
AND HEAT SHRINK TUBE

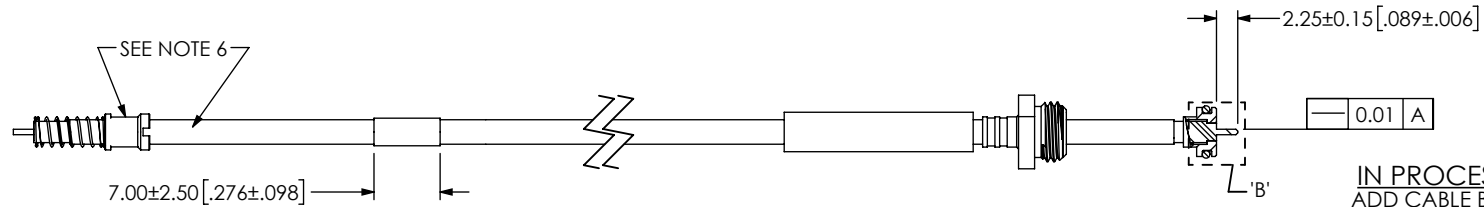

IN PROCESS 4
ADD CABLE BODY
SOLDER CABLE TO CABLE BODY
TRIM DIELECTRIC TO BE FLUSH WITH BODY

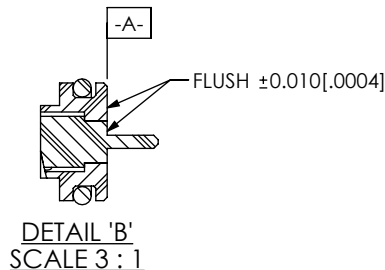

PROPRIETARY NOTE
THIS DOCUMENT CONTAINS CONFIDENTIAL AND PROPRIETARY INFORMATION AND ALL DESIGN, MANUFACTURING, REPRODUCTION, USE, PATENT RIGHTS AND SALES RIGHTS ARE EXPRESSLY RESERVED BY SAMTEC, INC. THIS DOCUMENT SHALL NOT BE DISCLOSED, IN WHOLE OR PART, TO ANY UNAUTHORIZED PERSON OR ENTITY NOR REPRODUCED, TRANSFERRED OR INCORPORATED IN ANY OTHER PROJECT IN ANY MANNER WITHOUT THE EXPRESS WRITTEN CONSENT OF SAMTEC, INC.



520 PARK EAST BLVD, NEW ALBANY, IN 47150
PHONE: 812-944-6733 FAX: 812-948-5047
e-Mail: info@SAMTEC.com code: 55322

DO NOT SCALE DRAWING

SHEET SCALE: 5:4

DESCRIPTION:
BULLSEYE 23 AWG CABLE ASSEMBLY

DWG. NO.
BE23S-XXXXX-XX-XX-XXXX

BY: EMMA CHEN 3/10/2014 SHEET 6 OF 7

IN PROCESS 5
ADD INSULATOR 2 AND
INDUCTIVE SOLDER PIN

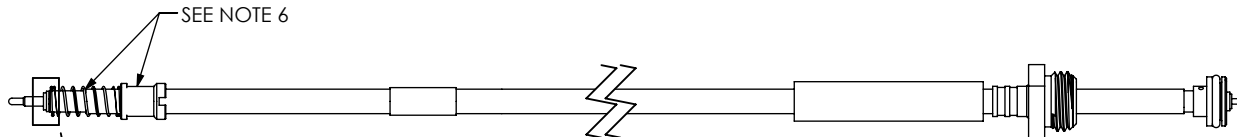

IN PROCESS 5
ADD GASKET

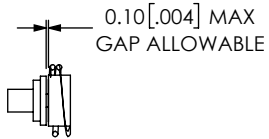

DETAIL 'C'
SCALE 3 : 1

IN PROCESS 6
ADD AND SOLDER FERRULE

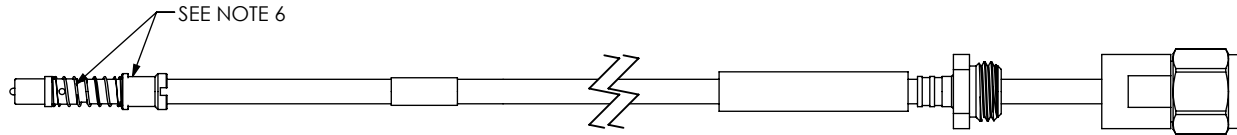

IN PROCESS 6
ADD SUB ASSEMBLY

IN PROCESS 7
ADD INSULATOR 1 AND COIN END

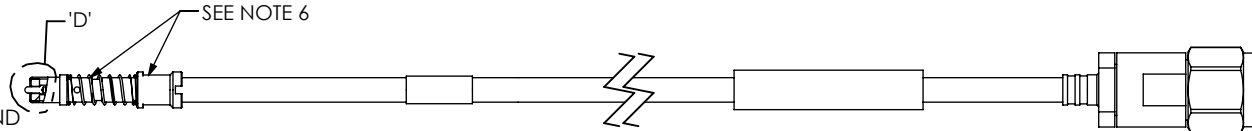

IN PROCESS 7
TORQUE SUB ASSEMBLY TO CABLE BODY,
20-30 IN-LBS

$R0.25 \pm 0.08 [0.10 \pm 0.003]$
(AFTER COINING)

$\phi 2.69 \pm 0.05 [1.06 \pm 0.002]$
(AFTER COINING)

0.41 [0.016]

(LENGTH OF COINED SECTION)

DETAIL 'D'
SCALE 3 : 1

$0.60 \pm 0.15 [0.024 \pm 0.006]$
(MAX GAP)

IN PROCESS 8
ACTIVATE HEAT SHRINK

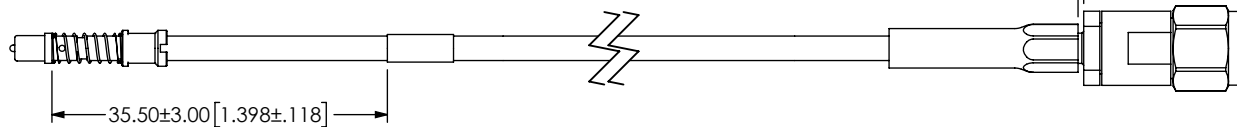

IN PROCESS 8
ACTIVATE HEAT SHRINK

PROPRIETARY NOTE
THIS DOCUMENT CONTAINS CONFIDENTIAL AND PROPRIETARY INFORMATION AND ALL DESIGN, MANUFACTURING, REPRODUCTION, USE, PATENT RIGHTS AND SALES RIGHTS ARE EXPRESSLY RESERVED BY SAMTEC, INC. THIS DOCUMENT SHALL NOT BE DISCLOSED, IN WHOLE OR PART, TO ANY UNAUTHORIZED PERSON OR ENTITY NOR REPRODUCED, TRANSFERRED OR INCORPORATED IN ANY OTHER PROJECT IN ANY MANNER WITHOUT THE EXPRESS WRITTEN CONSENT OF SAMTEC, INC.



520 PARK EAST BLVD, NEW ALBANY, IN 47150
PHONE: 812-944-6733 FAX: 812-948-5047
e-Mail: info@SAMTEC.com code: 55322

DO NOT SCALE DRAWING

SHEET SCALE: 5:4

DESCRIPTION:
BULLSEYE 23 AWG CABLE ASSEMBLY

DWG. NO.
BE23S-XXXXX-XX-XX-XXXX

BY: EMMA CHEN 3/10/2014 SHEET 7 OF 7