

# Product data sheet

Specifications



Illuminated push button, Harmony XB5, antimicrobial, plastic, orange, 30mm, universal LED, 1NO + 1NC, 230...240V AC

XB5FW35M5

## Main

|                                 |   |
|---------------------------------|---|
| Range of product                | Harmony XB5   |
| Product or component type       | Illuminated push-button   |
| Device short name               | XB5F  |
| Bezel material                  | Dark grey plastic   |
| Fixing collar material          | Plastic   |
| Head type                       | Built-in-flush  |
| Mounting diameter               | 1.20 in (30.5 mm)   |
| Sale per indivisible quantity   | 1   |
| Shape of signaling unit head    | Round   |
| Type of operator                | spring return   |
| Operator profile                | Orange flush, unmarked  |
| Operator additional information | With plain lens   |
| Contacts type and composition   | 1 NO + 1 NC   |
| Contact operation               | Slow-break  |
| Connections - terminals         | Screw clamp terminals, <= 2 x 1.5 mm² with cable end EN/IEC 60947-1<br>Screw clamp terminals, 1 x 0.22...2 x 2.5 mm² without cable end EN/IEC 60947-1 |
| Light source                    | Universal LED   |
| Bulb base                       | Integral LED  |
| [Us] rated supply voltage       | 220...240 V AC 50/60 Hz   |
| Cap/Operator or lens colour     | Orange  |

## Complementary

|                                    |   |
|------------------------------------|---|
| Height                             | 1.65 in (42 mm)                               |
| Width                              | 1.44 in (36.6 mm)                             |
| Depth                              | 2.17 in (55 mm)                               |
| Terminals description ISO n°1      | (21-22)NC<br>(13-14)NO                        |
| Resistance to high pressure washer | 1015.26 psi (7000000 Pa) 131 °F (55 °C) 0.1 m |
| Contacts usage                     | Standard contacts                             |
| Positive opening                   | With EN/IEC 60947-5-1 appendix K              |

|   |   |
|---|---|
| Operating travel                            | 0.06 in (1.5 mm) NC changing electrical state<br>0.10 in (2.6 mm) NO changing electrical state<br>0.17 in (4.3 mm) total travel)  |
| Operating force                             | 3.5 N NC changing electrical state<br>3.8 N   |
| Mechanical durability                       | 10000000 cycles   |
| Tightening torque                           | 7.08...10.62 lbf.in (0.8...1.2 N.m) EN 60947-1  |
| Shape of screw head                         | Cross Philips no 1<br>Cross pozidriv No 1<br>Slotted flat Ø 4 mm<br>Slotted flat Ø 5.5 mm   |
| Contacts material                           | Silver alloy (Ag/Ni)  |
| Short-circuit protection                    | 10 A cartridge fuse gG EN/IEC 60947-5-1   |
| [Ith] conventional free air thermal current | 10 A EN/IEC 60947-5-1   |
| [Ui] rated insulation voltage               | 600 V 3)EN/IEC 60947-1  |
| [Uimp] rated impulse withstand voltage      | 6 kV EN/IEC 60947-1   |
| [Ie] rated operational current              | 3 A 240 V, AC-15, A600 EN/IEC 60947-5-1<br>6 A 120 V, AC-15, A600 EN/IEC 60947-5-1<br>0.1 A 600 V, DC-13, Q600 EN/IEC 60947-5-1<br>0.27 A 250 V, DC-13, Q600 EN/IEC 60947-5-1<br>0.55 A 125 V, DC-13, Q600 EN/IEC 60947-5-1<br>1.2 A 600 V, AC-15, A600 EN/IEC 60947-5-1  |
| Electrical durability                       | 1000000 cycles, AC-15, 2 A 230 V 3600 cyc/h 0.5 EN/IEC 60947-5-1 appendix C<br>1000000 cycles, AC-15, 3 A 120 V 3600 cyc/h 0.5 EN/IEC 60947-5-1 appendix C<br>1000000 cycles, AC-15, 4 A 24 V 3600 cyc/h 0.5 EN/IEC 60947-5-1 appendix C<br>1000000 cycles, DC-13, 0.2 A 110 V 3600 cyc/h 0.5 EN/IEC 60947-5-1 appendix C<br>1000000 cycles, DC-13, 0.5 A 24 V 3600 cyc/h 0.5 EN/IEC 60947-5-1 appendix C |
| Electrical reliability                      | $\Lambda < 10\exp(-6)$ 5 V, 1 mA in clean environment EN/IEC 60947-5-4<br>$\Lambda < 10\exp(-8)$ 17 V, 5 mA in clean environment EN/IEC 60947-5-4   |
| Signalling type                             | Steady  |
| Supply voltage limits                       | 195...264 V AC  |
| Current consumption                         | 14 mA   |
| Service life                                | 100000 h at rated voltage and 25 °C   |
| Surge withstand                             | 1 kV IEC 61000-4-5  |
| Device presentation                         | Complete product  |

## Environment

|                                       |   |
|---------------------------------------|---|
| Protective treatment                  | TH  |
| Ambient air temperature for storage   | -40...158 °F (-40...70 °C)  |
| Ambient air temperature for operation | -40...158 °F (-40...70 °C)  |
| Overvoltage category                  | Class II IEC 60536  |
| IP degree of protection               | IP66 IEC 60529<br>IP67<br>IP69<br>IP69K   |
| NEMA degree of protection             | NEMA 13<br>NEMA 4X  |
| IK degree of protection               | IK03 IEC 50102  |
| Standards                             | EN/IEC 60947-1<br>UL 508<br>JIS C8201-5-1<br>EN/IEC 60947-5-4<br>EN/IEC 60947-5-1<br>CSA C22.2 No 14<br>JIS C8201-1<br>ISO 22196:2011 |

|                                       |  |
|---------------------------------------|--|
| Product certifications                | UL listed<br>CSA   |
| Vibration resistance                  | 5 gn 2...500 Hz)IEC 60068-2-6  |
| Shock resistance                      | 30 gn 18 ms) half sine wave acceleration IEC 60068-2-27<br>50 gn 11 ms) half sine wave acceleration IEC 60068-2-27 |
| Resistance to fast transients         | 2 kV IEC 61000-4-4   |
| Resistance to electromagnetic fields  | 9.14 V/yd (10 V/m) IEC 61000-4-3   |
| Resistance to electrostatic discharge | 6 kV on contact (on metal parts) IEC 61000-4-2<br>8 kV in free air (in insulating parts) IEC 61000-4-2             |
| Electromagnetic emission              | Class B IEC 55011  |

Packing Units

|                              |                       |
|------------------------------|-----------------------|
| Unit Type of Package 1       | PCE                   |
| Number of Units in Package 1 | 1                     |
| Package 1 Height             | 2.10 in (5.33 cm)     |
| Package 1 Width              | 1.70 in (4.32 cm)     |
| Package 1 Length             | 3.60 in (9.14 cm)     |
| Package 1 Weight             | 0.13 lb(US) (0.06 kg) |

Offer Sustainability

|                            |   |
|----------------------------|---|
| Sustainable offer status   | Green Premium product   |
| REACH Regulation           | <a href="#">REACH Declaration</a>   |
| EU RoHS Directive          | Pro-active compliance (Product out of EU RoHS legal scope)<br><a href="#">EU RoHS Declaration</a>                           |
| Mercury free               | Yes   |
| China RoHS Regulation      | <a href="#">China RoHS declaration</a>  |
| RoHS exemption information | <a href="#">Yes</a>   |
| Environmental Disclosure   | <a href="#">Product Environmental Profile</a>   |
| Circularity Profile        | <a href="#">End of Life Information</a>   |
| WEEE                       | The product must be disposed on European Union markets following specific waste collection and never end up in rubbish bins |

Dimensions

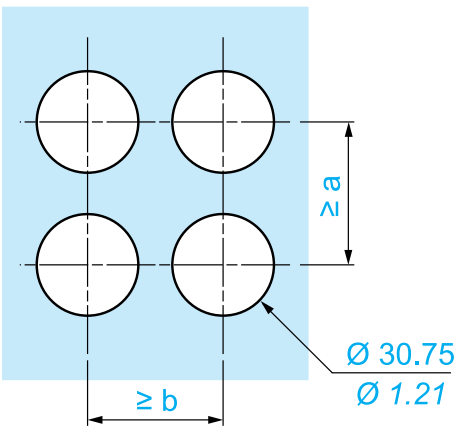
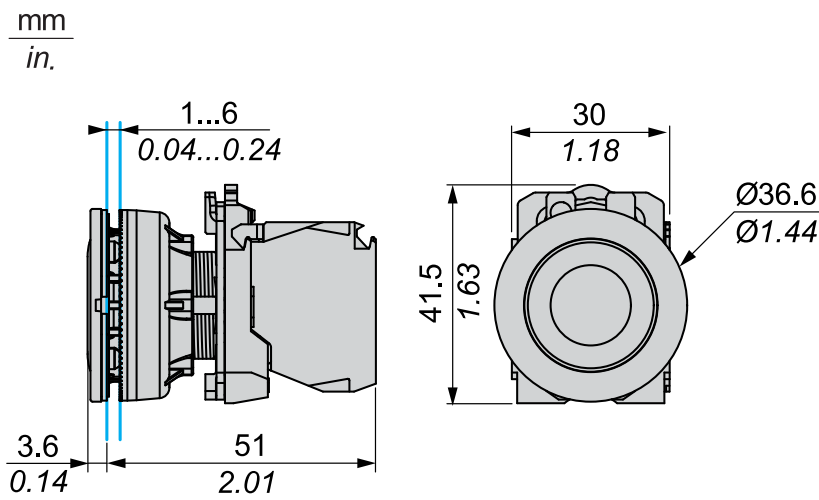

|            |           | a (mm) | a (in.) | b (mm) | b (in.) |
|------------|-----------|--------|---------|--------|---------|
|            |           | 40     | 1.57    | 40     | 1.57    |
| ZBE●●●●●●  | ZBV●●●●●  |        |         |        |         |
|            |           | 45     | 1.77    | 40     | 1.57    |
| ZBE●●●●●●3 | ZBV●●●●●3 |        |         |        |         |
|            |           | 40     | 1.57    | 40     | 1.57    |
| ZBE●●●●●●4 | ZBV●●●●●4 |        |         |        |         |

Recommended replacement(s)