



- 1
- 2
- 3
- 4
- 5
- 6
- 7
- 8
- 9
- 10
- 11
- 12
- 13
- 14
- 15
- 16
- 17
- 18

**MATERIAL**

Glass-fibre reinforced polyamide based (PA) technopolymer, polyamide based (PA) technopolymer coating, chemically bonded with semi-glossy finish, black colour.

**COLOURED CENTRE CAP**

Polyamide based (PA) technopolymer, in the standard colours, semi-glossy finish.

**STANDARD EXECUTIONS**

- **VB.839-B**: brass boss, threaded blind hole.
- **VB.839-SST**: AISI 303 stainless steel boss, threaded blind hole.
- **VB.839-p**: zinc-plated steel threaded stud, chamfered flat end according to UNI 947 : ISO 4753 (see Technical data on page A-11).

**FEATURES**

The three-arm shape is particularly ergonomic, ensuring an excellent grip.

**SPECIAL EXECUTIONS ON REQUEST**

- Three-arm knobs with AISI 304 stainless steel metal parts.
- Cap in other colours or with customised graphic symbols, marks or writings.

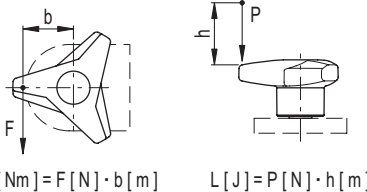

**Conversion Table**  
1 mm = 0.039 inch

D	
mm	inch
63	2.48
80	3.15
100	3.94

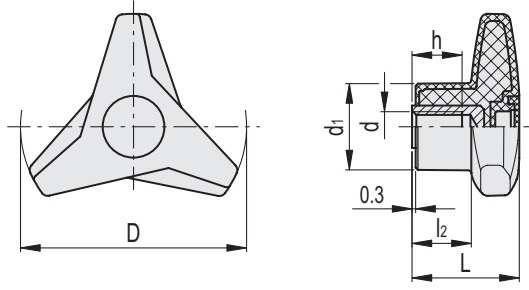

\* Complete with colour index, example: 64635-C2 VB.839/63 B-M8-C2

<b>C9</b> RAL9005	<b>C2</b> RAL2004	<b>C3</b> RAL7035	<b>C4</b> RAL1021	<b>C5</b> RAL5024	<b>C6</b> RAL3000	<b>C17</b> RAL6017
----------------------	----------------------	----------------------	----------------------	----------------------	----------------------	-----------------------



**VB.839-B**

Code	Description	D	d	L	d1	l2	h	C# [Nm]	L** [J]	⚖
64635-*	VB.839/63 B-M8-*	63	M8	30.5	23	16	13	30	9	41
64636-*	VB.839/63 B-M10-*	63	M10	30.5	23	16	13	30	9	40
64675-*	VB.839/80 B-M10-*	80	M10	37	30.5	20	17	80	10	71
64676-*	VB.839/80 B-M12-*	80	M12	37	30.5	20	17	80	10	75
64705-*	VB.839/100 B-M12-*	100	M12	43	35	23	20	110	11	110
64706-*	VB.839/100 B-M14-*	100	M14	43	35	23	20	110	11	121

# "Max limit Tightening torque" means the max torque value at which the metal insert, in normal conditions of use, is perfectly and strongly anchored to the plastic material.

\*\* For impact strength (L) see Technical data on page A-3.

Clamping elements



Conversion Table 1 mm = 0.039 inch	
D	
mm	inch
63	2.48
80	3.15
100	3.94

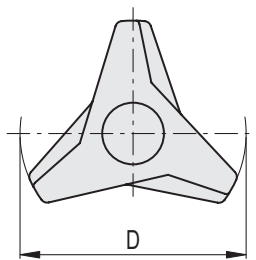

VB.839-SST

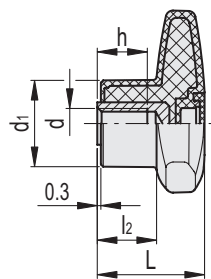

VB.839-p

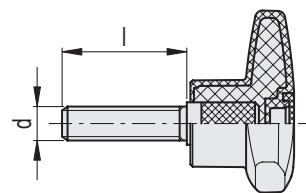

\* Complete with colour index, example: 64652-C2 VB.839/63 p-M8x25-C2

- C9 RAL9005
- C2 RAL2004
- C3 RAL7035
- C4 RAL1021
- C5 RAL5024
- C6 RAL3000
- C17 RAL6017



VB.839-SST

Code	Description	D	d	L	d1	l2	h	C# [Nm]	L** [J]	⚖
64638-*	VB.839/63 SST-M8-*	63	M8	30.5	23	16	13	30	9	41
64678-*	VB.839/80 SST-M10-*	80	M10	37	30.5	20	17	80	10	71
64708-*	VB.839/100 SST-M12-*	100	M12	43	35	23	20	110	11	109

VB.839-p



Code	Description	D	d	L	d1	l	l2	C# [Nm]	L** [J]	⚖
64652-*	VB.839/63 p-M8x25-*	63	M8	30.5	23	25	16	25	9	46
64655-*	VB.839/63 p-M8x35-*	63	M8	30.5	23	35	16	25	9	55
64692-*	VB.839/80 p-M10x30-*	80	M10	37	30.5	30	20	50	10	87
64722-*	VB.839/100 p-M12x40-*	100	M12	43	35	40	23	110	11	137

# "Max limit Tightening torque" means the max torque value at which the metal insert, in normal conditions of use, is perfectly and strongly anchored to the plastic material.

\*\* For impact strength (L) see Technical data on page A-3.