

Assorted Terminals



RING TERMINALS



CLOSED END CONNECTORS



BUTT SPLICES



FEMALE DISCONNECTS



SPADE TERMINALS

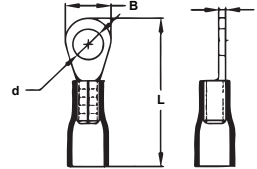
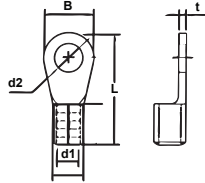

Uninsulated Ring Terminals (Brazed Seam)

AWG	Part No.	Stud Size	d1	d2	B	L	t
22-16	902-407-10	#4	.074	.126	.217	.453	.029
	902-406-10	#6	.074	.146	.260	.567	.029
	902-408-10	#8	.074	.169	.260	.567	.029
	902-409-10	1/4"	.074	.252	.457	.846	.029
16-14	902-410-10	#6	0.98	.146	.335	.661	.031
	902-411-10	#8	0.98	.169	.260	.567	.031
	902-412-10	#10	0.98	.209	.335	.661	.031
14-12	902-413-10	1/4"	0.98	.252	.472	.835	.031
	902-414-10	#10	.133	.209	.374	.768	.031
12-10	902-415-10	#8	.141	.169	.291	.728	.039
	902-416-10	#10	.141	.209	.291	.728	.039
	902-417-10	1/4"	.141	.252	.472	1.004	.039

Insulated Ring Terminals (Vinyl)

AWG	Part No.	Stud Size	B	d	L	t
22-16 (Red)	902-437-10	#6	.217	.146	.689	.030
	902-438-10	#8	.260	.169	.803	.030
	902-439-10	#10	.315	.209	.854	.030
	902-440-10	1/4"	.457	.252	1.087	.030
16-14 (Blue)	902-441-10	#6	.335	.146	.906	.031
	902-442-10	#8	.335	.169	.906	.031
	902-443-10	#10	.335	.209	.906	.031
12-10 (Yellow)	902-444-10	1/4"	.472	.252	1.106	.031
	902-445-10	#8	.291	.169	1.051	.039
	902-446-10	#10	.374	.209	1.051	.039
	902-447-10	1/4"	.472	.252	1.281	.039

• Dimensions in Inches.

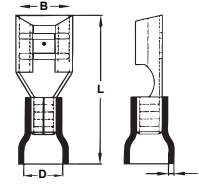
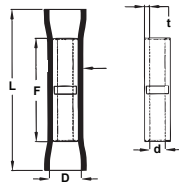
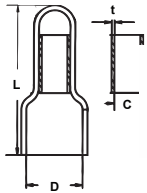

Closed End Connectors (Vinyl)

AWG	Part No.	D	C	L	T
22-16	902-402-10	.244	.102	.709	.014
16-14	902-403-10	.311	.118	.776	.014
12-10	902-404-10	.413	.157	1.004	.018
8	902-405-10	.472	.209	1.091	.037

Butt Splices Connectors (Vinyl)

AWG	Part No.	D	D	L	F	T
22-16 Red	902-418-10	.169	.067	.984	.591	.030
16-14 Blue	902-419-10	.177	.094	.984	.591	.031
12-10 Yellow	902-420-10	.256	.141	1.063	.591	.037

Female Disconnects (Push-Ons) (Vinyl)

AWG	Part No.	Tab Size	D	B	L	T
22-16 Red	902-421-10	.187 x .032	.142	.197	.748	.016
	902-422-10	.205 x .020	.142	.220	.787	.016
16-14 Blue	902-423-10	.187 x .032	.173	.197	.748	.016
	902-424-10	.205 x .020	.173	.22	.787	.016
12-10 Yellow	902-425-10	.187 x .032	.213	.197	.866	.016
	902-426-10	.250 x .032	.213	.264	.984	.016

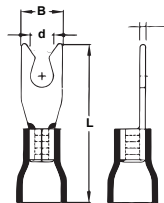
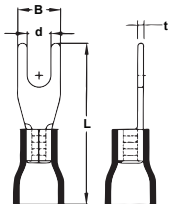

Spade Terminals (Vinyl)

AWG	Part No.	Stud Size	B	D	L	T
22-16 Red	902-448-10	#6	.224	.146	.866	.030
	902-449-10	#8	.252	.169	.866	.030
	902-450-10	#10	.209	.209	.866	.030
	902-451-10	1/4"	.252	.252	.906	.030
16-14 Blue	902-452-10	#6	.146	.146	.866	.031
	902-453-10	#8	.169	.169	.866	.031
	902-454-10	#10	.209	.209	.866	.031
12-10 Yellow	902-455-10	1/4"	.252	.252	.925	.031
	902-456-10	#8	.169	.169	1.051	.039
	902-457-10	#10	.209	.209	1.051	.039
	902-458-10	1/4"	.252	.252	1.209	.039

Locking Spade Terminals (Vinyl)

AWG	Part No.	Stud Size	B	D	L	T
22-16 Red	902-427-10	#6	.224	.146	.866	.030
	902-428-10	#8	.286	.169	.866	.030
	902-429-10	#10	.315	.209	.906	.030
16-14 Blue	902-430-10	#6	.244	.146	.866	.031
	902-431-10	#8	.283	.169	.866	.031
	902-432-10	#10	.315	.209	.866	.031
12-10 Yellow	902-433-10	#6	.319	.146	1.051	.039
	902-434-10	#8	.323	.169	1.051	.039
	902-435-10	#10	.354	.209	1.051	.039
	902-436-10	1/4"	.472	.252	1.209	.039