

REV	ECN	APP'D
A	4859	JT 6-26-02
B	5022	JT 10-14-02
D	5031	JT 10-14-02
E	5092	

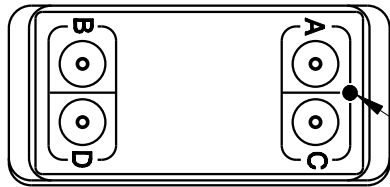

INDEXING INDICATOR

NOTES:

- MATERIALS:**
HOUSING: POLYETHERIMIDE, COLOR: BLACK.
GROMMET: SILICONE ELASTOMER, COLOR: BLUE.
R1: 590Ω , $\pm 1\%$, 1W, G-1-80.
R2: $2.0K\Omega$, $\pm 1\%$, 1W, RS-1A.
- MODULE SUPPLIED WITH 5 CONTACTS, M39029/1-101.
- MODULE CONFORMS TO MIL-T-81714.

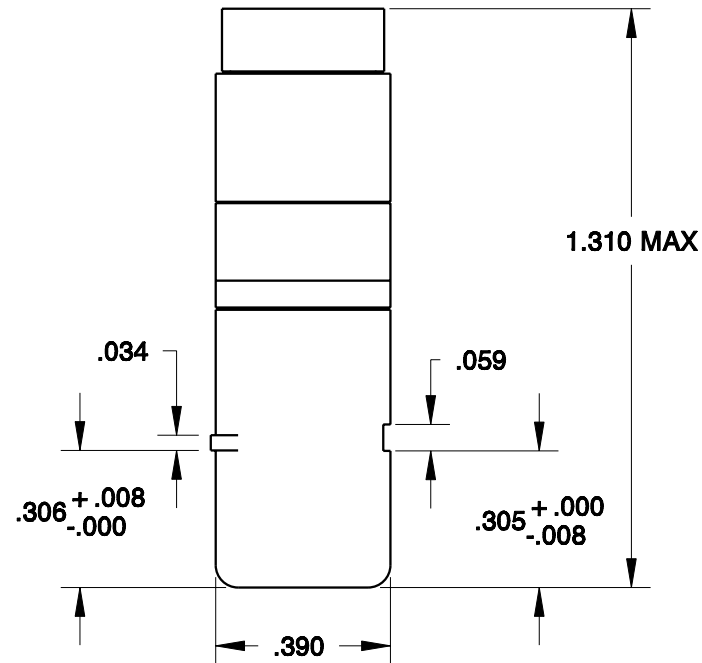
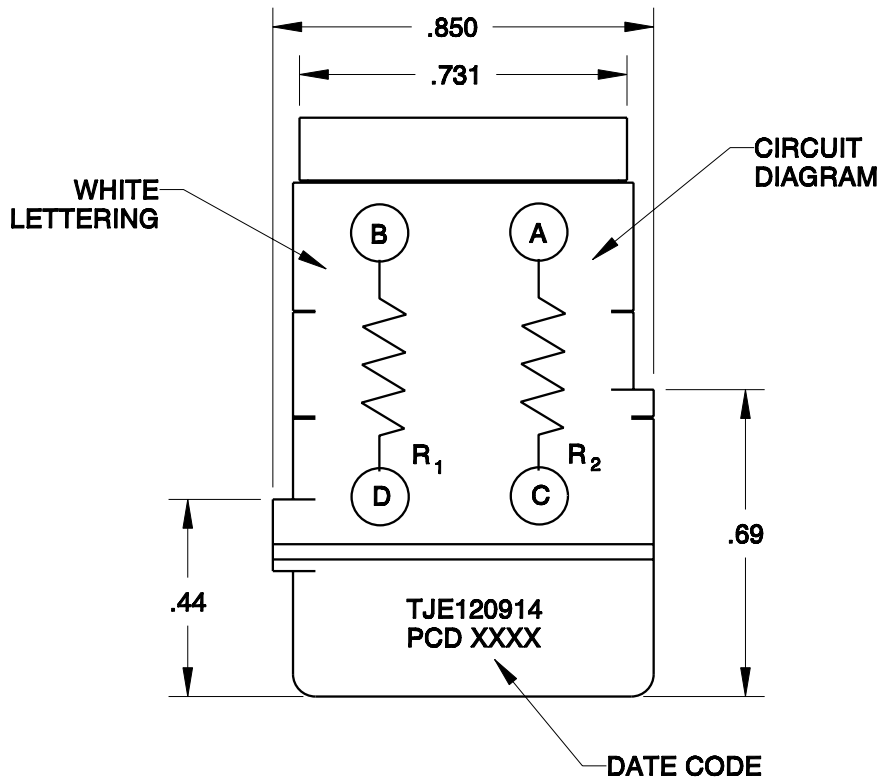

DIMENSIONS	TOLERANCES	PROJECTION	SPECIFICATION DRAWING		TITLE	
ANSI Y14.5M UNITS: INCHES Pro/E FILE	.XX ± 0.01 .XXX ± 0.005 ANGLES $\pm 1.0^\circ$		ENGR S. HORNER 15-May-02		TJE RESISTORS 590 & 2.0K Ω	
ORIGINAL	THIS DOCUMENT CONTAINS PROPRIETARY INFORMATION WHICH IS THE CONFIDENTIAL PROPERTY OF PCD, INC. PEABODY, MA, USA	CHKD J. TON 26-June-02	SIZE A	DWG NO. TJE120914	REV E	
		APPD J. TON 26-June-02	CODE: 58982	SCALE: NONE	SHEET 1 OF 1	