



# TAI-SAW TECHNOLOGY CO., LTD.

No. 3, Industrial 2nd Rd., Ping-Chen Industrial District,  
Taoyuan, 324, Taiwan, R.O.C.

TEL: 886-3-4690038 FAX: 886-3-4697532

E-mail: [tstsales@mail.taisaw.com](mailto:tstsales@mail.taisaw.com) Web: [www.taisaw.com](http://www.taisaw.com)

## Product Specifications Approval Sheet

Product Name: SAW Filter 2332.5MHz (BW 25MHz) SMD 3.0x3.0mm

TST Parts No.:TA1282A

Customer Parts No.: \_\_\_\_\_

Customer signature required
Company: _____
Division: _____
Approved by : _____
Date: _____

Checked by: Andy Yu *Andy*

Approval by: Francis Chen *Francis Chen*

Date: 2011/07/05

1. Customer signed back is required before TST can proceed with sample build and receive orders.
2. Orders received without customer signed back will be regarded as agreement on the specifications.
3. Any specifications changes must be approved upon by both parties and a new revision of specifications shall be released to reflect the changes



# TAI-SAW TECHNOLOGY CO., LTD.

No. 3, Industrial 2nd Rd., Ping-Chen Industrial District,  
Taoyuan, 324, Taiwan, R.O.C.

TEL: 886-3-4690038 FAX: 886-3-4697532

E-mail: [tstsales@mail.taisaw.com](mailto:tstsales@mail.taisaw.com) Web: [www.taisaw.com](http://www.taisaw.com)

## SAW Filter 2332.5 MHz(BW 25MHz)

MODEL NO.: TA1282A

REV. NO.:1

### A. MAXIMUM RATING:

1. Input Power Level: 10 dBm
2. DC voltage: 3 V
3. Operating Temperature: -40°C to +105°C
4. Storage Temperature: -40°C to +105°C

RoHS Compliant  
Lead free  
Lead-free soldering

### B. ELECTRICAL CHARACTERISTICS:

Terminating source impedance :  $Z_s = 50 \Omega$

Terminating load impedance :  $Z_L = 50 \Omega$

Item	Unit	Min.	Type.	Max.	Note
<b>Center Frequency</b> <span style="float: right;"><b>Fc</b></span>	MHz	-	2332.5	-	-
<b>Max. Insertion Loss</b> (2320~2345 MHz)	<b>IL</b> dB	-	2.7	3.6	-
<b>Passband ripple</b> (2320~2345 MHz)	dB	-	1.2	1.5	-
<b>Amplitude ripple</b> (2320~2332.5 MHz)	dB	-	0.8	1.3	-
<b>Amplitude ripple</b> (2332.5~2345 MHz)	dB	-	0.8	1.1	-
<b>S11 &amp; S22 VSWR</b>		10	12		
<b>Attenuation</b>					
D.C~2175 MHz	dB	35	38	-	-
2175~2227 MHz	dB	15	40	-	-
2400~2500 MHz	dB	12	30	-	-
2500~4200 MHz	dB	25	28	-	-
Package size	mm	SMD 3.0x3.0			
Temp Coefficient	ppm/K	-36			-

### C. Frequency Characteristics :

(1) wide band Response: (span 4GHz)

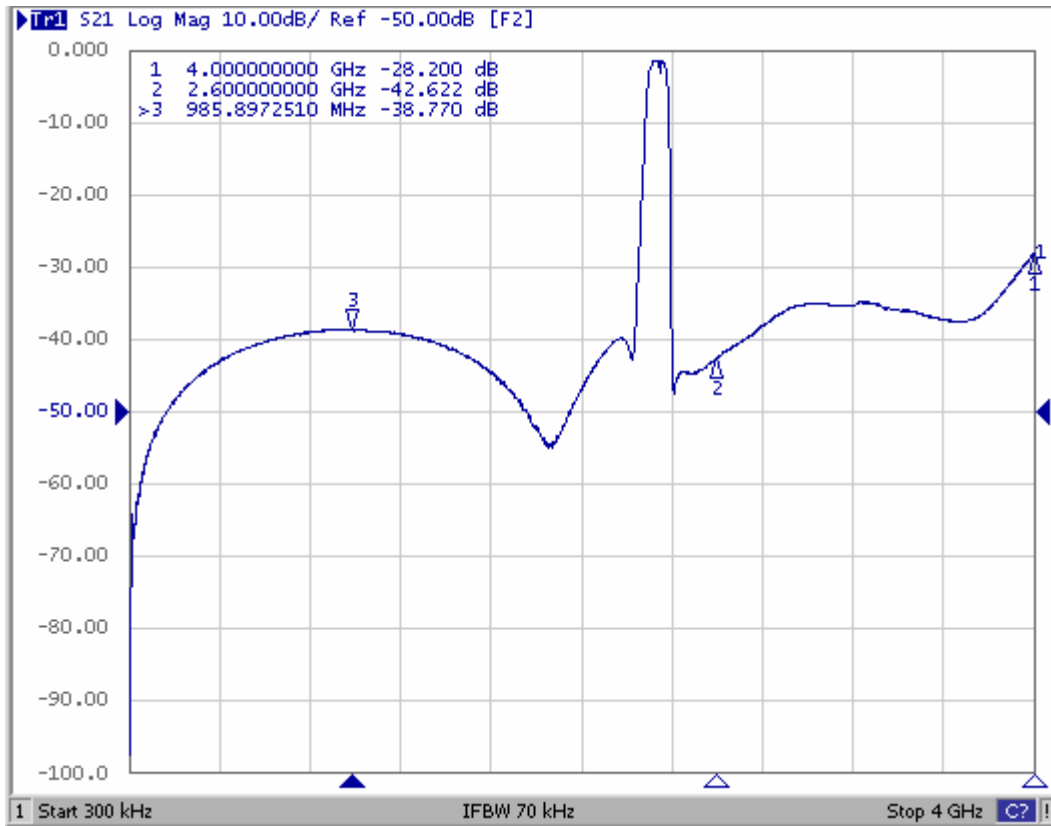

(2) Pass band Response:( span 500MHz)

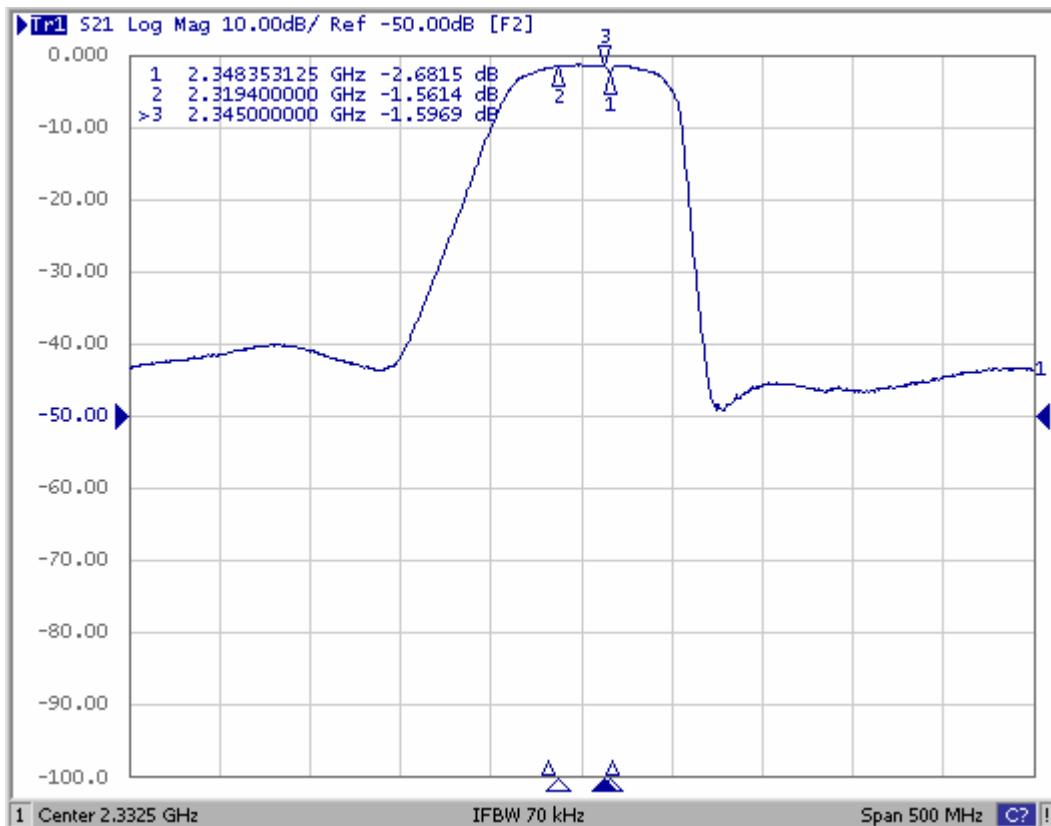

(3) S11 & S22 VSWR Response:( span 500MHz)

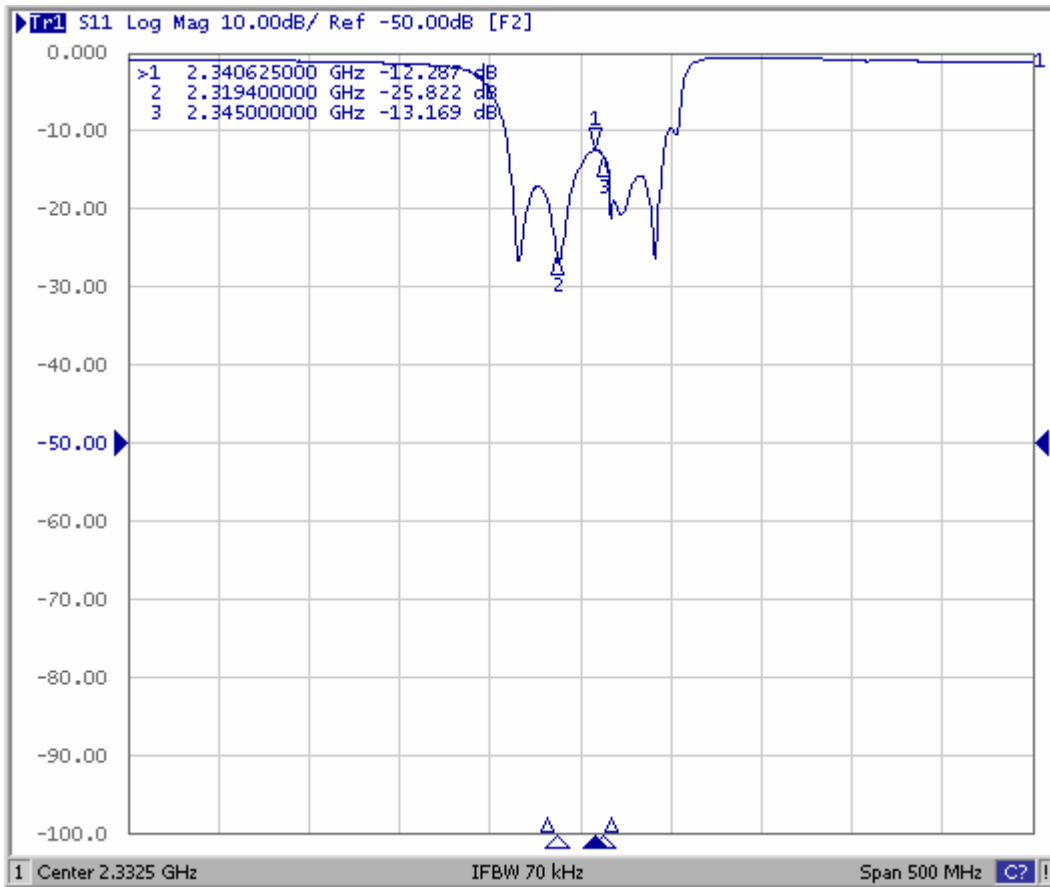

**D. MEASUREMENT CIRCUIT:**

HP Network analyzer

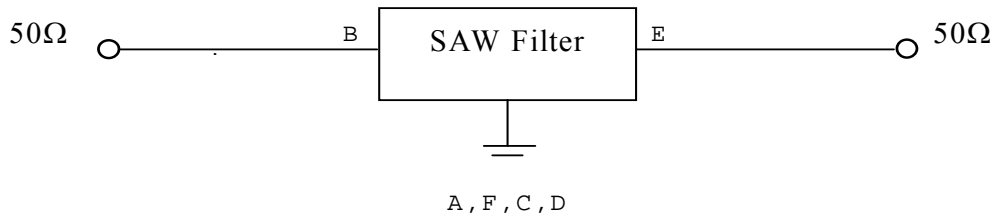

**E. OUTLINE DRAWING:**

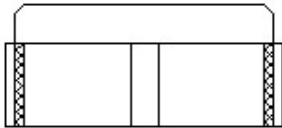
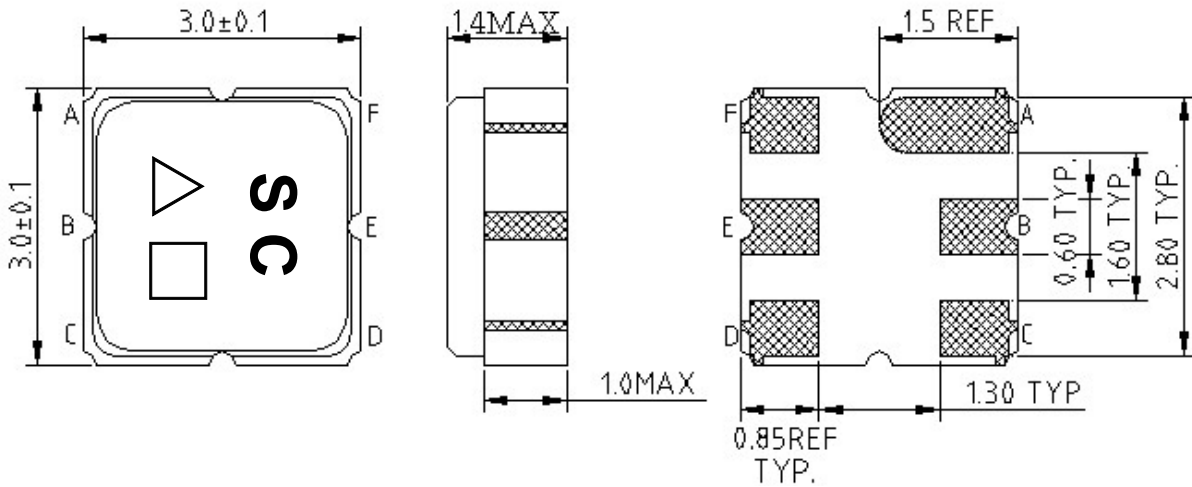

- #B: Input
  - #E: Output
  - #A,C,D,F: Ground
  - △: Year code (ex 2008→8)
  - : Date code
- Unit: mm

**F. PCB FootPrint**

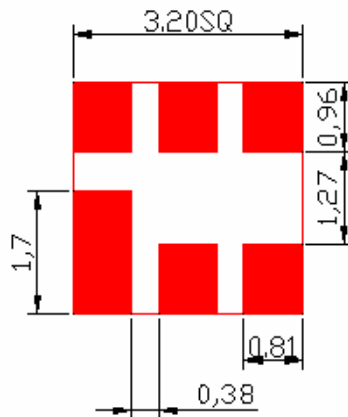

## G. PACKING:

### 1. REEL DIMENSION

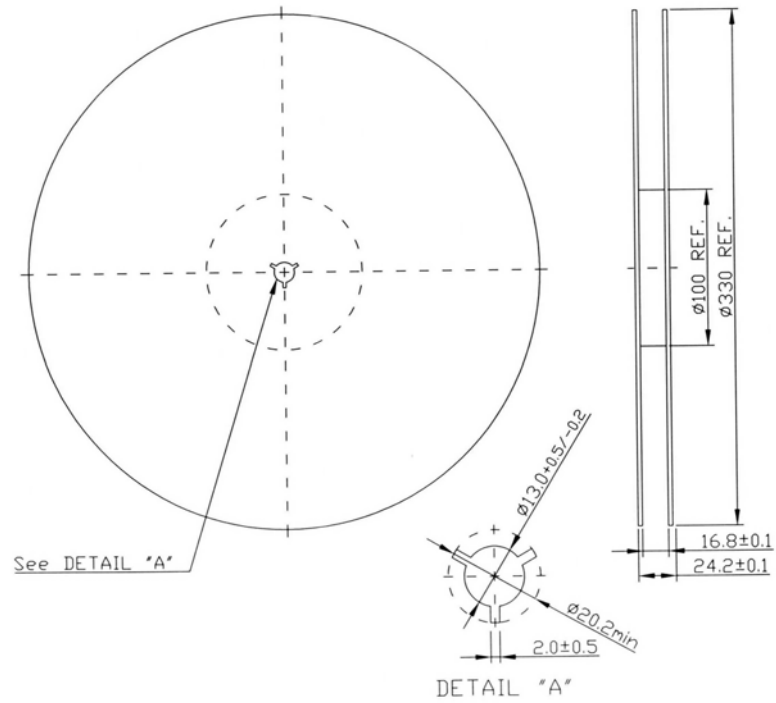

### 2. TAPE DIMENSION

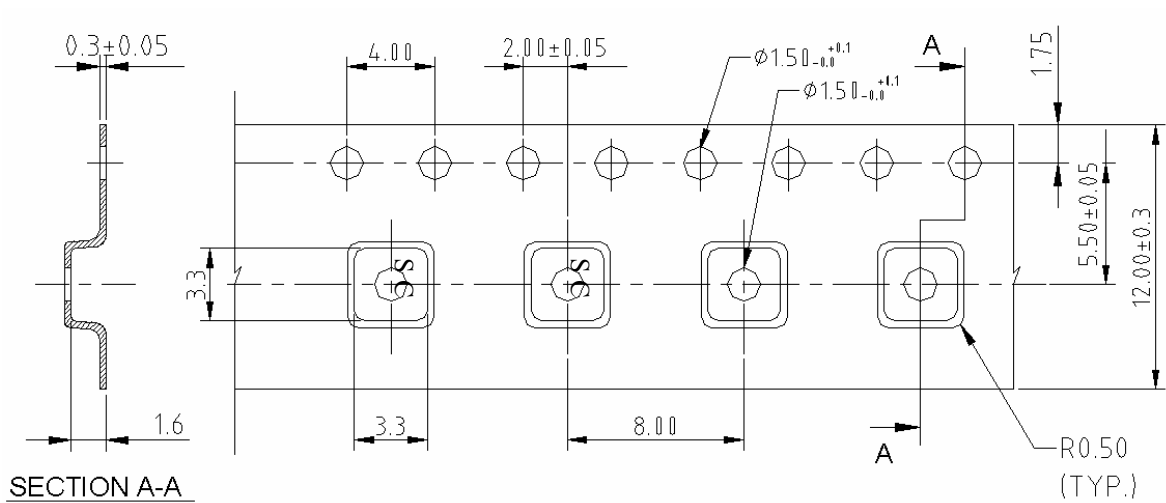

## H. RECOMMENDED REFLOW PROFILE :

