

REVISIONS				
REV	ECO	DESCRIPTION	DATE	BY APPR
A1	-	RELEASED DRAWING	Nov-9-17	Rookie Tommy
A2	-	ADD THE GS PART NUMBER	Jan-28-19	Blink Tommy
A3	-	CHANGE HAND CRIMPER	Nov-8-19	Flan Tommy

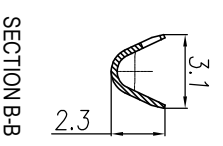
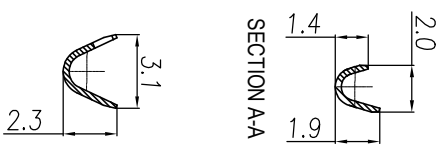
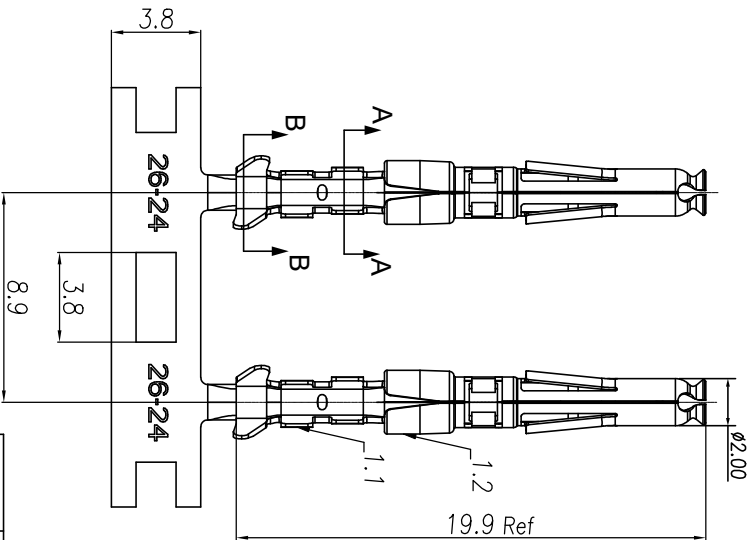
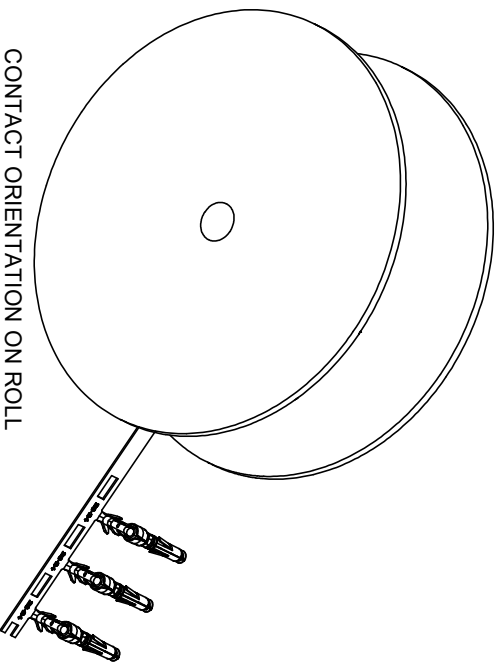

- CONTACT ORIENTATION ON ROLL
 NOTES: (UNLESS OTHERWISE SPECIFIED)
- MATERIAL:
 - CONTACT BODY: COPPER ALLOY.
 - OUTER SPRING: STAINLESS STEEL.
 - SPECIFICATIONS:
 - CURRENT RATING: 5A MAX.
 - TERMINATION TYPE: CRIMPING.
 - WIRE RANGE: 26~24AWG.
 - WIRE INSULATION DIA(MAX): $\phi 2.2\text{mm}$.
 - ROHS COMPLIANT.
 - ALL DIMENSIONS ARE FOR REFERENCE USE ONLY.
 - AVAILABLE TOOLS:
 - HAND CRIMPER: MFX-3958. A3
 - CRIMP APPLICATOR: MFX-3957.
 - EXTRACTION TOOL: QXRT20.

P/N	CONTACT PLATING(MATING AREA)
SS24W2T	TIN PLATING OVER NICKEL.
SS24W2N	NICKEL PLATING OVER COPPERIZE.
SS24W2F	GOLD FLASH PLATING OVER NICKEL.
SS24W2G5	5 μ " GOLD PLATING OVER NICKEL.
SS24W2G10	10 μ " GOLD PLATING OVER NICKEL.
SS24W2G15	15 μ " GOLD PLATING OVER NICKEL.
SS24W2G30	30 μ " GOLD PLATING OVER NICKEL.

QUANTITY	PART NUMBER	DESCRIPTION	ITEM
		MATERIALS LIST	
UNLESS OTHERWISE SPECIFIED 1) All dimensions are in millimeters. 2) Tolerances are as follows: 1 Pt. DEC 0.030 Fractions 1/164 3 Pt. DEC 0.015 Fractions 1/164 3) Note reference =			
MATERIAL SPECIFICATIONS CUSTOMER: Tommy APPROVE: Tommy DATE: Nov-8-19		THE DRAWING IS SUBJECT TO MODIFICATIONS AND PERFORMANCE DATA SPECIFICATIONS AND PERFORMANCE DATA WILL BE SUPPLIED TO THE CUSTOMER WITHOUT LIABILITY. REPRODUCTION OR REPRODUCTION IS PROHIBITED. ALL DIMENSIONS ARE IN MILLIMETERS UNLESS OTHERWISE SPECIFIED.	
PROCESS SPECIFICATIONS NEXT ASBY:		ECO-MATE SOCKET CONTACT, STAMPED, 24-26AWG, SIZE 20 DWG NO: SS24W2XX SCALE: NONE SHEET 1 OF 1	
SIGNATURES DRAWN: Rli CHECKED: Mth ENGINEER: Tommy DATE: Nov-8-19		Amphenol Sine Systems - www.amphenol-sine.com 44724 Montey Drive Clinton Township, MI 48038	