

## SUMMARY

### # Wires

Low voltage	16
-------------	----



*Image is for illustrative purpose only*

Series	SP
Termination type	Male solder
IP rating	50
AWG wire size	36.00 - 28.00
Cable Ø	4.00 - 5.20 mm
Status	Active
Matching parts	<a href="#">SKN.M16.NLLN</a>

### Download

[Request a quote](#)

[Eplan](#)

[Catalog](#)

## TECHNICAL DETAILS

### Mechanics

Shell Style/Model	SA*: Straight plug, key (N) or keys (P, S and T), with black cable collet
Keying	3 keys (alpha=0, gamma=30, plug: male contacts, receptacle: female contacts)
Housing Material	Proprietary sulfone, black
Variant	N : Black collet nut
Weight	7.76 g

### Performance

Configuration	SP.M16 : 16 Low V.
Insulator	L: PEEK (UL 94 / V-0/1.5)
Rated Current	3.0 Amps

### Specifications

Contact Type: Solder
Contact Dia.: 0.5 mm (0.0196in)
Bucket Dia.: 0.45 mm (0.0177in)
Max. Solid Conductor: 0.12 mm <sup>2</sup> (AWG 28)
Max. Stranded Conductor: 0.12 mm <sup>2</sup> (AWG 28)
R (max): 8.5 mOhm
Test voltage (kV rms) Contact-contact: 0.75

LEMO products and services are provided "as is". LEMO makes no warranties or representations with regard to LEMO product & services or use of them, express, implied or statutory, including for accuracy, completeness, or security. The user is fully responsible for his products and applications using LEMO components.

Air clearance min.: 0.47 mm  
Creepage distance min.: 0.47 mm

Others

Endurance (Shell): >2000 mating cycles  
Temp (min / max): -50°C / +170°C

DRAWINGS

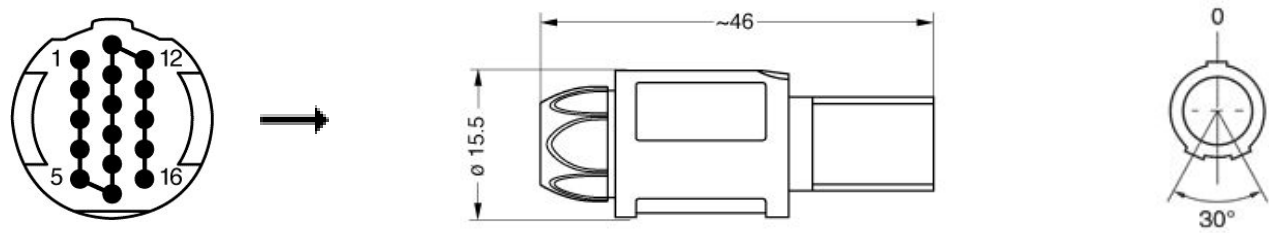

Dimensions

	A	L
mm.	15.5	46
in.	0,61	1,81

RECOMMENDED BY LEMO

Tools

Cables

CMN.16.T30.047QGZE	TPR (medical)	Grey	
16050	PVC	Black	

LEMO products and services are provided “as is”. LEMO makes no warranties or representations with regard to LEMO product & services or use of them, express, implied or statutory, including for accuracy, completeness, or security. The user is fully responsible for his products and applications using LEMO components.