

ITEM:	MATERIAL:	FINISH:	NOTES:
CONNECTOR BODY	BRASS, NOTE 1	GOLD, NOTE 8	1. PER QQ-B-626 2. PER QQ-S-764 3. PER QQ-C-530 4. PER QQ-B-750 5. PER MIL-P-19468 6. PER ZZ-R-765 7. PER WW-T-799 8. GOLD PLATED 5µin MIN. OVER NICKEL PLATE 50µin MIN. OVER COPPER STRIKE. 9. NICKEL PLATE 100µin MIN. OVER COPPER STRIKE. 10. PER ASTM-A967 11. GOLD PLATE 30µin MIN. OVER NICKEL PLATE 50µin MIN. OVER COPPER STRIKE. 12. TIN ZINC PLATE 100µin MIN. OVER COPPER STRIKE.
CENTER CONTACT	BERYLLIUM COPPER, NOTE 3	GOLD, NOTE 11	
INSULATION	TEFLON, NOTE 5	-----	
FERRULE	-----	-----	
GASKET	-----	-----	
HEX NUT	BRASS, NOTE 1	GOLD, NOTE 8	
LOCK WASHER	BRASS, NOTE 1	GOLD, NOTE 8	

REVISIONS				
REV	ECR	DESCRIPTION	DRAWN	DATE
1		ENGINEERING RELEASE	PAB	11/07/2011
2		CHANGED HEIGHT DIM, WAS 9MM S/B 8MM. ADDED 4.5MM DIMENSION FOR BARREL HEIGHT	PAB	03/25/2013

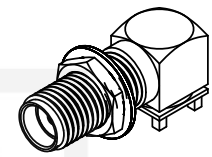

SCALE: 2/1

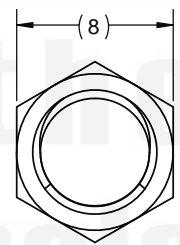
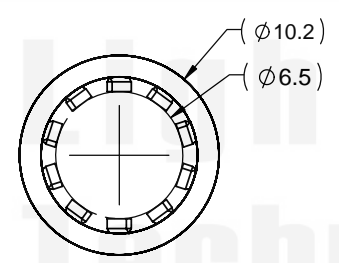
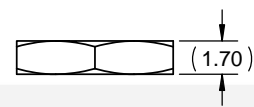
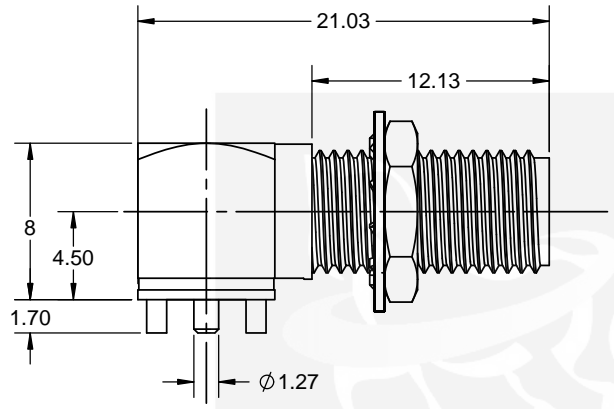
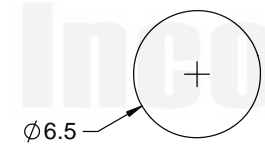
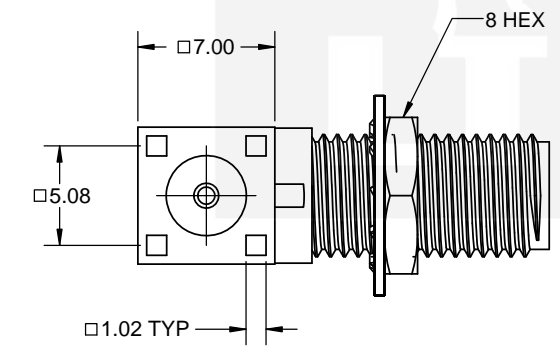

SUGGESTED PANEL CUTOUT

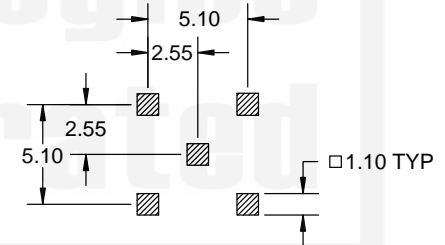

SUGGESTED PCB LAYOUT

PROPRIETARY AND CONFIDENTIAL
 UNLESS OTHERWISE SPECIFIED: THIS DOCUMENT CONTAINS LIGHTHORSE TECHNOLOGIES INFORMATION, REPRODUCTION, USE, DISCLOSURE OR TRANSMITTAL OF ALL OR ANY PART OF THIS DOCUMENT IS PROHIBITED EXCEPT TO THE EXTENT APPROVED IN WRITING BY AN AUTHORIZED REPRESENTATIVE OF LIGHTHORSE TECHNOLOGIES. LIGHTHORSE TECHNOLOGIES RESERVES ALL RIGHTS UNDER PATENTS, TRADEMARKS, COPYRIGHTS AND TRADE SECRETS. COPY RIGHTS OF LIGHTHORSE TECHNOLOGIES 2011, ALL RIGHTS RESERVED.



DO NOT SCALE DRAWING	
TOLERANCES UNLESS OTHERWISE SPECIFIED	
DIMENSIONS ARE IN MILLIMETERS	
X	= ±0.5
X.X	= ±0.25
X.XX	= ±0.13
ANGLE	= ±30
THIRD ANGLE PROJECTION	
CUSTOMER APPROVAL	
SIGN / DATE:	
ENG APPR.	
CHECKED	
DRAWN	P. BURDGE
NAME	DATE

 San Diego, CA WWW.RFCCONNECTOR.COM	
TITLE: SMA, RHT ANGLE, JACK, PCB SLDR PADS, PCB SURFACE MNT, BLUKHEAD MOUNT	
SIZE	PART/DWG. NO:
B	SALF663GT
REV	2
SCALE: 4:1	FILE NAME
SHEET 1 OF 1	