

General information

Part number	S23F2C-P16MM00-600S
Termination	solder
Size	3
Locking principle	push
Coding	2_halfshell
Cable Diameter	cable_mini_60
Cable outlet	bend_relief

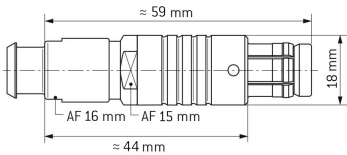

DIMENSIONS:



Contact insert description

Number of contacts	16
Contact type	pins
Contact diameter	12_07_4_16mm
Insulator material	peek
Wire cross section	26_awg_14_awg
Termination	solder
Termination diameter	065mm180mm

reverse\_gender\_on\_request

Technical information

Max. creepage and air clearance distance	07_07_mm	07_25_mm
Nominal current single contact	6_21_a	iec_60512_5_2
Test voltage	09_15_kv_ac	sae_13441

safety\_text

Mechanical and environmental data

Degree of protection*	ip50
Operating temperature	40_120_c
Mating cycles	5000

mated\_unmated

Material and surface treatments

Housing	m_chrome
Contact	cu_alloy_gold

safety\_text\_2  
ul\_text  
illustrative\_text