

| REVISIONS | | | | | |
|-----------|-----|----------------------------|-------------|------|-------|
| REV | ECO | DESCRIPTION | DATE | BY | APPR |
| B1 | - | RELEASED DRAWING | NOV-01-2017 | FLAN | TOMMY |
| B2 | - | MODIFICATON OF PART NUMBER | JAN-26-2018 | FLAN | TOMMY |
| B3 | - | Update the dimension | JUN-29-2021 | Flan | Tommy |

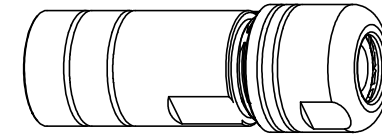
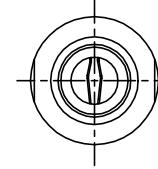
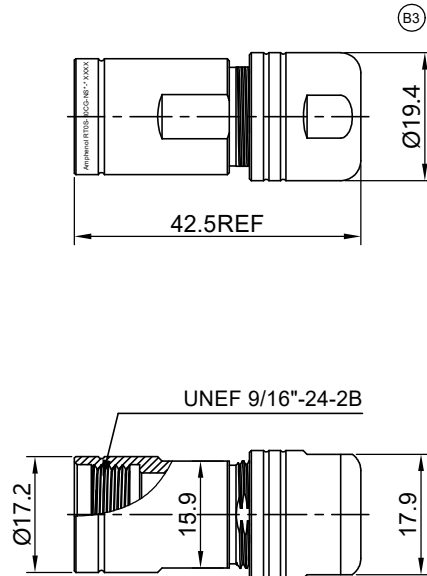

| P/N | CABLE O.D. |
|-----------------|-------------|
| RT0S-10CG-NS1-* | Ø3.0-Ø5.0mm |
| RT0S-10CG-NS2-* | Ø5.0-Ø8.5mm |

NOTES: (UNLESS OTHERWISE SPECIFIED)

1. MATERIAL:
 - 1.1. NUT: ZINC ALLOY.
 - 1.2. BACK SHELL: ZINC ALLOY.
 - 1.3. O-RING: SILICONE RUBBER.
 - 1.4. CABLE SEAL: EPDM.
 - 1.5. EMI SHIELDING RING: STAINLESS STEEL.
 - 1.6 CLAMP INSERT: THERMOPLASTIC UL94 V-0.
2. RoHS COMPLIANT.
3. ALL DIMENSIONS ARE FOR REFERENCE USE ONLY.
4. SHELL FINISHED:

| P/N | " * " | SHELL FINISHED |
|-----------------|-------|----------------|
| RT0S-10CG-NS*-* | OMIT | PLATED NICKLE |
| | Z | BLACK ZINC |
| | G | GREEN ZINC |

| QUANTITY | PART NUMBER | DESCRIPTION | ITEM |
|---|-------------|--|---|
| MATERIALS LIST | | | |
| UNLESS OTHERWISE SPECIFIED 1) All dimensions are in metric(mm). 2) Tolerances are as follows: 1 PL DEC ±0.30 2 PL DEC ±0.15 3 PL DEC ±0.08 3) Note reference = | | SIGNATURES DATE DRAWN: <u>Flan</u> <u>JUN-29-2021</u> CHECKED: <u>Orion</u> <u>JUN-30-2021</u> ENGINEER: APPROVAL: <u>Tommy</u> <u>JUN-30-2021</u> CUSTOMER: | Amphenol Sine Systems - www.amphenol-sine.com 44724 Morley Drive Clinton Township, MI 48036 |
| MATERIAL SPECIFICATIONS: PROCESS SPECIFICATIONS: NEXT ASSY: | | THIS DRAWING IS SUPPLIED FOR INFORMATION ONLY. DESIGN FEATURES, SPECIFICATIONS AND PERFORMANCE DATA SHOWN HEREON ARE THE PROPERTY OF THE AMPHENOL CORPORATION. NO RIGHTS OF REPRODUCTION ARE IMPLIED. ALL DIMENSIONS ARE SUBJECT TO NORMAL MANUFACTURING VARIATIONS. | EcoMate RM CORD GRIP, SIZE 10. SIZE TYPE DWG NO: B C- RT0S-10CG-NS*-* B3 SCALE: NONE SHEET 1 OF 1 |

TITLE: EcoMate RM,CORD GRIP, SIZE 10
 DWG NO: RT0S-10CG-NS*-*
 REV: B3
 SH: 1
 OF: 1