

**SCHEMATIC**

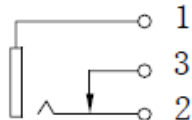

**SPECIFICATION**

- 1. Rating : DC 30V 0.5A;
- 2. Contact resistance:  $\leq 0.03\Omega$ ;
- 3. Insulation resistance:  $\geq 100M\Omega$  (DC250V);
- 4. Withstand voltage: 500VAC ;
- 5. Insertion and extraction force: 3-25N;
- 6. life test: 5,000 cycles.

NOTE: ALL DIMS ARE IN mm.

NO.	DESCRIPTION	QTY	MATERIAL	PLATING
6	COVER	1	PBT	
5	HOUSING	1	PBT	
4	AXIS SUPPORT	1	H59 BRASS	Ni-Plating
3	CURVE PIECE	1	H62 BRASS	Sn-Plating
2	SPRING PIECE	1	SUS301	Sn-Plating
1	FLAT PIECE	1	H62 BRASS	Sn-Plating

PROJECTION

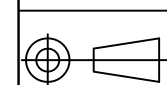

Research Develop Innovate

RDI, Inc. 333 North Bedford Road, Suite 135, Mount Kisco, NY 10549

SCALE UNDEFINED

TITLE Jack, RoHS Compliant

TOLERANCE EXCEPT AS NOTED

DR. Tina	DATE 04/13/20	REF. P/N: RSJ-370-NL	SHEET 1 OF 1
----------	---------------	----------------------	--------------

DEC. MILLIMETERS .X±0.10 .XX±0.25 .XXX±0.35

CK. MS	PRE- JK	DRAWING NO. 5058	SIZE A	REV. -
--------	---------	------------------	--------	--------

ANG. .X±3.0°

THIS DOCUMENT IS OWNED BY, AND THE INFORMATION CONTAINED IN IT IS PROPRIETARY TO, RDI, BY RECEIPT HEREOF THE HOLDER AGREES NOT TO USE THE INFORMATION AND NOT TO DISCLOSE IT TO ANY THIRD PARTY, NOR REPRODUCE THIS DOCUMENT WITHOUT THE WRITTEN CONSENT OF RDI, AND AGREES TO RETURN THIS DOCUMENT FORTHWITH UPON REQUEST.

ECN#	DATE	SYM	REVISION RECORD	AUTH	BY
------	------	-----	-----------------	------	----