

- 1
- 2
- 3
- 4
- 5
- 6
- 7
- 8
- 9
- 10
- 11
- 12
- 13
- 14
- 15
- 16
- 17
- 18

STANDARD EXECUTION

(AlNiCo) Aluminium-nickel-cobalt magnet, resistant to temperatures up to 450°C.

See Guidelines for the choosing (on page 1180).

FEATURES AND APPLICATIONS

RML-US retaining magnets are unshielded cylindric magnets.

They are mostly attached by gluing.

When used without air gap, RML-US unshielded magnets have lower adhesive forces than the magnet systems RML (see page 1197) in which magnetic shielding increases enormously the intensity of the adhesive force acting on the surface.

SPECIAL EXECUTIONS ON REQUEST

Different lengths.



Conversion Table	
1 mm = 0,039 inch	
d1	
mm	inch
3	0.12
4	0.16
5	0.20
6	0.24
8	0.31
10	0.39
12	0.47
15	0.59
20	0.79
34	1.34

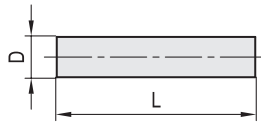

METRIC

Code	Description	D ^{+0-0.2}	L ^{±0.1}	Temperature max. [°C]	Nominal adhesive forces* [N]	⚖
502041	RML-US-AN-3-10	3	10	450	1.1	1
502043	RML-US-AN-3-12	3	12	450	1.3	1
502045	RML-US-AN-4-16	4	16	450	1.9	1
502047	RML-US-AN-4-20	4	20	450	2	2
502049	RML-US-AN-5-20	5	20	450	2.3	3
502051	RML-US-AN-6-15	6	15	350	2.8	3
502053	RML-US-AN-6-24	6	24	450	2.8	4
502055	RML-US-AN-6-30	6	30	450	2.8	6
502057	RML-US-AN-8-25	8	25	450	3.8	9
502059	RML-US-AN-8-32	8	32	450	3.8	11
502061	RML-US-AN-10-20	10	20	350	5	11
502063	RML-US-AN-10-40	10	40	450	7	23
502065	RML-US-AN-12-40	12	40	450	8	33
502067	RML-US-AN-12-48	12	48	450	8	39
502069	RML-US-AN-15-30	15	30	350	10	39
502071	RML-US-AN-15-60	15	60	450	11	76
502073	RML-US-AN-20-40	20	40	350	17	92
502075	RML-US-AN-34-80	34	80	350	61	527