

## RH-ST

## Bridge handles

Round cross section, steel

METRIC



## RH-SS

## Bridge handles

Round cross section, steel

METRIC



- 1
- 2
- 3
- 4
- 5
- 6
- 7
- 8
- 9
- 10
- 11
- 12
- 13
- 14
- 15
- 16
- 17
- 18

### MATERIAL

Round cross section steel bar, chrome-plated surface, glossy finish.

### WASHERS

Brass, chrome-plated surface.

### STANDARD EXECUTION

Threaded blind holes.

### SPECIAL EXECUTIONS ON REQUEST

Different lengths.

### MATERIAL

Round cross section steel bar, ground and light chrome-plated surface, matte finish.

### CENTRAL GRIP

Plastic, black colour, smooth matte finish.

### END SUPPORTS

Brass, chrome-plated surface, matte finish.

### STANDARD EXECUTION

Threaded blind holes.

### SPECIAL EXECUTIONS ON REQUEST

Different lengths.



Conversion Table			
1 mm = 0.039 inch			
mm	inch	mm	inch
32	1.26	88	3.43
42	1.65	100	3.94
55	2.16	120	4.72
64	2.52	180	7.09
76	2.99	200	7.87

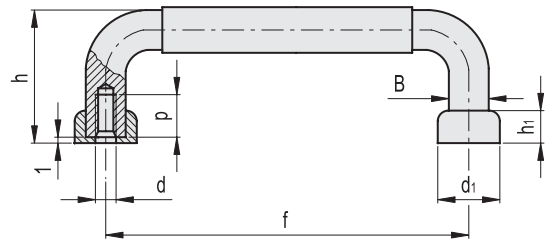
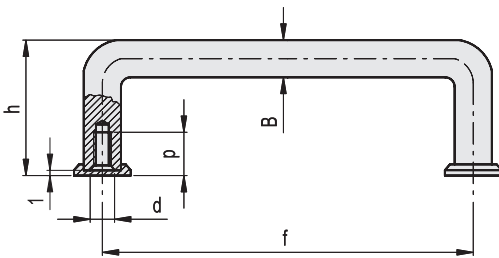

METRIC

Code	f	d	p	B	h	⚖️
RHST-05.032.22	32	M3	6	5	25	8
RHST-05.042.22	42	M3	6	5	25	11
RHST-05.055.22	55	M3	6	5	25	14
RHST-05.076.22	76	M3	6	5	25	18
RHST-05.088.22	88	M3	6	5	25	20
RHST-08.032.22	32	M4	8	8	33	30
RHST-08.055.22	55	M4	8	8	33	44
RHST-08.064.22	64	M4	8	8	33	45

METRIC

Code	f	d	p	B	h	h1	d1	⚖️
RHSS-10.055.28	55	M5	10	10	41	8	14	77
RHSS-10.088.28	88	M5	10	10	41	8	14	98
RHSS-10.100.28	100	M5	10	10	41	8	14	105
RHSS-10.120.28	120	M5	10	10	41	8	14	119
RHSS-10.180.28	180	M5	10	10	41	8	14	163
RHSS-10.200.28	200	M5	10	10	41	8	14	170