

**MATERIAL**

AISI 304 stainless steel tube, ground and brushed surface with a high resistance to strong impacts and scratches.

**STANDARD EXECUTIONS**

AISI 303 stainless steel tapped bosses for M10x30 cylindrical-head screws with hexagon socket and AISI 303 stainless steel washers, included in the supply.

- **RHER-A:** double-curved handle.
- **RHER-D:** angular handle.
- **RHER-S:** U-shaped handle.

**ACCESSORIES ON REQUEST**

AISI 304 stainless steel collar with plastic washer (RHER-33.0050.RO).

**SPECIAL EXECUTIONS ON REQUEST**

- Different lengths.
- Version for assembly in pairs opposed to each other.
- Version with adaptable boss.

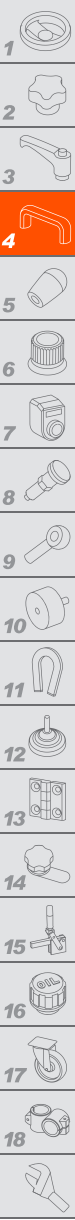

**RH-ER-RO**

**INOX** STAINLESS STEEL **METRIC**

Code	Diameter	⚖️
RHER-33.0050.RO	50x1.5	21

Application example with collar and washer

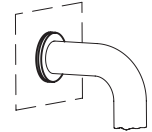

**RHER-A**

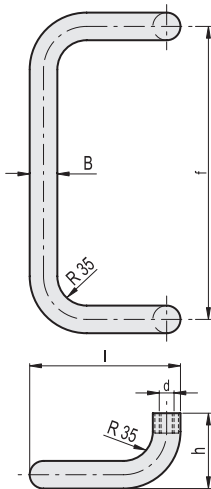

**RHER-D**

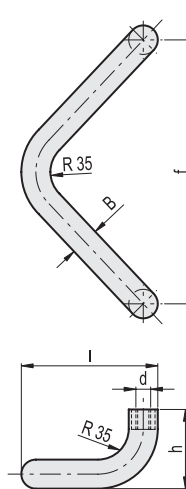

**RHER-S**

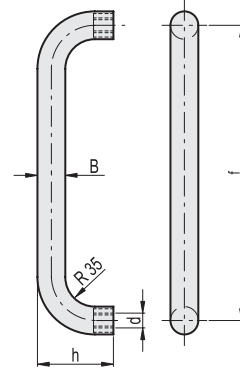

Conversion Table	
1 mm = 0.039 inch	
f	
mm	inch
300	11.81
350	13.78
500	19.68

**RH-ER-A**

**INOX** STAINLESS STEEL **METRIC**

Code	f	d	B	h	l	⚖️
RHER-33.A350.EG	350	M10	33	90	180	1227
RHER-33.A500.EG	500	M10	33	90	180	1048

**RH-ER-D**

**INOX** STAINLESS STEEL **METRIC**

Code	f	d	B	h	l	⚖️
RHER-33.D300.EG	300	M10	33	90	155	1008

**RH-ER-S**

**INOX** STAINLESS STEEL **METRIC**

Code	f	d	B	h	⚖️
RHER-33.S350.EG	350	M10	33	90	1015
RHER-33.S500.EG	500	M10	33	90	1010