



















- 1 
- 2 
- 3 
- 4 
- 5 
- 6 
- 7 
- 8 
- 9 
- 10 
- 11 
- 12 
- 13 
- 14 
- 15 
- 16 
- 17 
- 18 

COVERING

Mould-on polyurethane, hardness 95 Shore A.

WHEEL CENTRE BODY

Cast iron.

ROLLING ACTION

Hub with ball bearings. Ideal solution for heavy loads and continuous moving.

FIXED PLATE BRACKET

Electrolytically zinc-plated electro-welded steel. The bracket is designed to withstand loads up to 9000N. Suitable for heavy industrial applications and for severe conditions of use, such as impact and high speeds.

TURNING PLATE BRACKET

Electrolytically zinc-plated electro-welded steel.

The presence of an axial bearing and a conical bearing ensures excellent manoeuvrability also at full load and increases the resistance of the bracket against side impact. It is equipped with lubricator and anti-loosening system of the locking nut. The bracket is designed to withstand loads up to 9000N. Suitable for heavy industrial applications and for severe conditions of use, such as impact and high speeds.

It consists of (see Fig.1):

1. fitting plate: forged steel with built-in pin, electrolytically zinc-plated;
2. fork: drawn sides electro-welded to the flange, electrolytically zinc-plated;
3. rotation system: axial ball bearing and conical roller bearing;
4. lubricator
5. anti-loosening system of the locking nut.

BRAKE

Dual-effect rear brake with simultaneous locking of wheel and bracket. The brake is simple and effective to use: it is actuated and released by a simple action from the top downward at the tip of two separate pedals, thus ensuring the utmost manoeuvring comfort. The braking efficacy may be adjusted with a socket head screw M8.

STANDARD EXECUTIONS

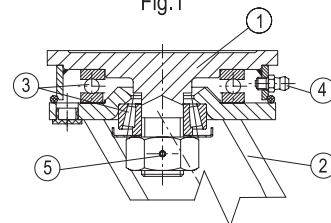
- PSL-WH: fixed plate bracket, without brake.
- SSL-WH: turning plate bracket, without brake.
- SSF-WH: turning plate bracket, with brake.

APPLICATIONS

Suitable for heavy industrial applications and severe conditions of use. The mould-on polyurethane wheels ensure excellent rolling resistance and elasticity, high wear and tearing resistance. For further information see wheel technical data sheet RE.F4 (see page 1834).

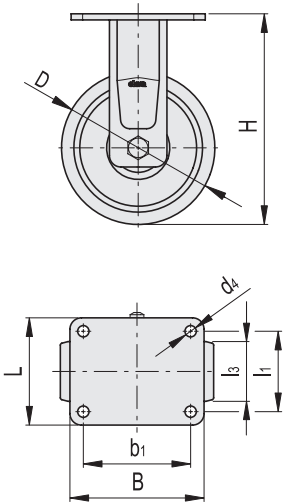


Fig.1

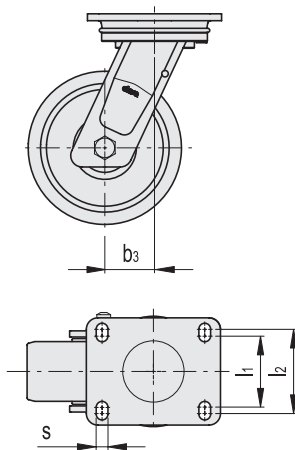


| Conversion Table | |
|-------------------|------|
| 1 mm = 0.039 inch | |
| D | |
| mm | inch |
| 125 | 4.92 |
| 160 | 6.30 |
| 200 | 7.87 |

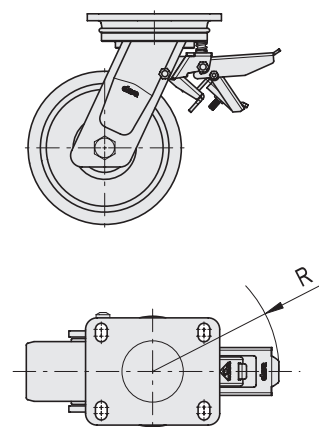
RE.F4-PSL-WH



RE.F4-SSL-WH



RE.F4-SSF-WH



METRIC

| Code | Description | D | d4 | l1 | l2 | l3 | H | B | L | s | b1 | b3 | R | Rolling resistance# [N] | Dynamic carrying capacity# [N] | ⚖️ |
|--------|------------------|-----|----|----|----|----|-----|-----|-----|----|-----|----|-----|-------------------------|--------------------------------|------|
| 451465 | RE.F4-125-PSL-WH | 125 | 11 | 80 | - | 50 | 182 | 135 | 110 | - | 105 | - | - | 2700 | 5500 | 3900 |
| 451466 | RE.F4-150-PSL-WH | 150 | 11 | 80 | - | 50 | 210 | 135 | 110 | - | 105 | - | - | 2900 | 7000 | 4510 |
| 451467 | RE.F4-200-PSL-WH | 200 | 11 | 80 | - | 50 | 252 | 135 | 110 | - | 105 | - | - | 3800 | 9000 | 5790 |
| 451425 | RE.F4-125-SSL-WH | 125 | - | 73 | 87 | 50 | 182 | 135 | 110 | 11 | 105 | 51 | - | 2700 | 5500 | 4880 |
| 451426 | RE.F4-150-SSL-WH | 150 | - | 73 | 87 | 50 | 210 | 135 | 110 | 11 | 105 | 60 | - | 2900 | 7000 | 5500 |
| 451427 | RE.F4-200-SSL-WH | 200 | - | 73 | 87 | 50 | 252 | 135 | 110 | 11 | 105 | 70 | - | 3800 | 9000 | 6770 |
| 451446 | RE.F4-125-SSF-WH | 125 | - | 73 | 87 | 50 | 182 | 135 | 110 | 11 | 105 | 51 | 157 | 2700 | 5500 | 5760 |
| 451447 | RE.F4-150-SSF-WH | 150 | - | 73 | 87 | 50 | 210 | 135 | 110 | 11 | 105 | 60 | 157 | 2900 | 7000 | 6380 |
| 451448 | RE.F4-200-SSF-WH | 200 | - | 73 | 87 | 50 | 252 | 135 | 110 | 11 | 105 | 70 | 157 | 3800 | 9000 | 7650 |

For rolling resistance and dynamic carrying capacity see Technical data (on page 1880).

Models all rights reserved in accordance with the law. Always mention the source when reproducing our drawings and photos.

