

- 1
- 2
- 3
- 4
- 5
- 6
- 7
- 8
- 9
- 10
- 11
- 12
- 13
- 14
- 15
- 16
- 17
- 18

**COVERING**

Grey anti-trace rubber.

**WHEEL CENTRE BODY**

Polypropylene-based (PP) technopolymer, with polyamide thread guards (D = 40 mm) or with metal thread guards (D = 50, 60, 80 mm).

**ROLLING ACTION**

Hub with pass-through hole.

**APPLICATIONS**

Castors for the general public, excellent rolling resistance and elasticity features. For selection parameters see Technical data (on page 1295). RE.C7 wheels are also supplied with steel sheet bracket RE.C7-C (see page 1273).

**ENVIRONMENTAL CONDITIONS**

Suitable for use in humid environments and in the presence of medium-aggressive chemical environments; use in environments with the presence of organic, chlorinated solvents, hydrocarbons and mineral oils is not recommended.

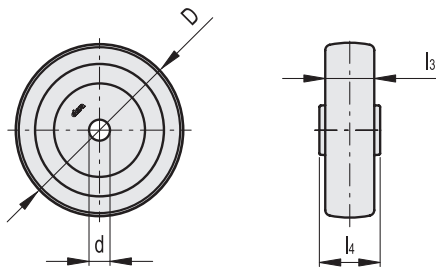

Conversion Table	
1 mm = 0.039 inch	
D	
mm	inch
40	1.56
50	1.95
60	2.34
80	3.12

**METRIC**

Code	Description	D	d	l3	l4	Dynamic carrying capacity# [N]	⚖️
452076	RE.C7-040-RBL	40	8	18	21	300	30
452081	RE.C7-050-RBL	50	8	18	21	350	60
452086	RE.C7-060-RBL	60	8	24	28	500	100
452091	RE.C7-080-RBL	80	8	24	28	550	170

Castors and wheels

# For static load, rolling resistance and dynamic carrying capacity see Technical data (on page 1296).