

## SUMMARY

### # Wires

Low voltage 8



*Image is for illustrative purpose only*

|                  |                |
|------------------|----------------|
| Series           | 1P             |
| Termination type | Female solder  |
| IP rating        | 50             |
| AWG wire size    | 32.00 - 24.00  |
| Cable Ø          | 0.00 - 0.00 mm |
| Status           | Active         |

### Download

[Request a quote](#)

[Catalog](#)

## TECHNICAL DETAILS

### Mechanics

|                   |   |
|-------------------|---|
| Shell Style/Model | PK*: Fixed receptacle with two nuts (back panel mounting)           |
| Keying            | 2 keys (alpha=60; Plug: male contacts; Receptacle: female contacts) |
| Housing Material  | PEI (Polyetherimide), gray  |
| Variant           | V : Green front nut   |

### Performance

|               |                           |
|---------------|---------------------------|
| Configuration | 1P.M08 : 8 Low Voltage    |
| Insulator     | L: PEEK (UL 94 / V-0/1.5) |
| Rated Current | 5 Amps                    |

### Specifications

Contact Type: Solder  
Contact Dia.: 0.7 mm (0.0275in)  
Bucket Dia.: 0.6 mm (0.024in)  
Max. Solid Conductor: 0.14 mm<sup>2</sup> (AWG 26)  
Max. Stranded Conductor: 0.14 mm<sup>2</sup> (AWG 26)  
R (max): 6.5 mOhm  
Test voltage (kV rms) Contact-contact: 1.05  
Air clearance min.: 0.6 mm  
Creepage distance min.: 0.6 mm

LEMO products and services are provided "as is". LEMO makes no warranties or representations with regard to LEMO product & services or use of them, express, implied or statutory, including for accuracy, completeness, or security. The user is fully responsible for his products and applications using LEMO components.

Others

- Endurance (Shell): >2000 mating cycles
- Temp (min / max): -50°C / +170°C
- F ret (min): 50 N
- F ret (max): 150 N
- Steam sterilization: > 100 times (with potting on rear connection)

DRAWINGS

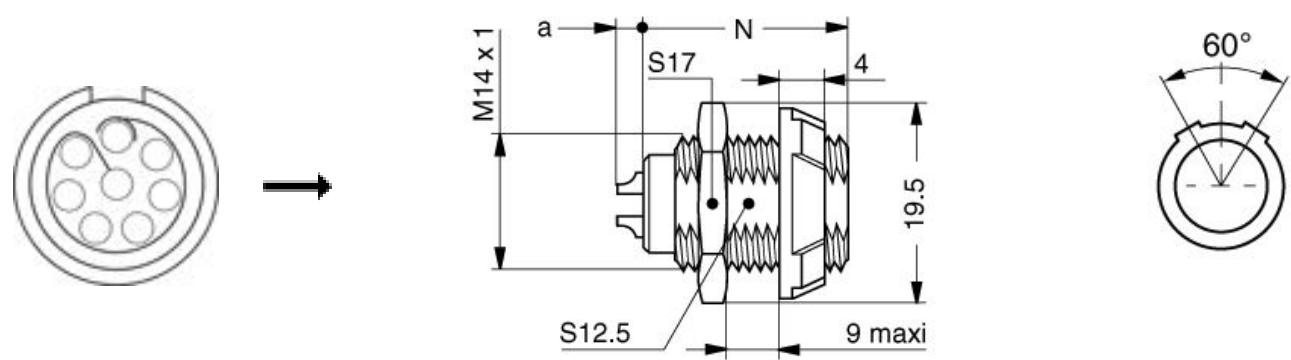

Dimensions

|     | A    | N         | a     |
|-----|------|-----------|-------|
| mm. | 19.5 | 20.5-22.2 | 0-4.5 |
| in. | 0,77 | 0,81      | 0,00  |

RECOMMENDED BY LEMO

Tools

LEMO products and services are provided “as is”. LEMO makes no warranties or representations with regard to LEMO product & services or use of them, express, implied or statutory, including for accuracy, completeness, or security. The user is fully responsible for his products and applications using LEMO components.