

OX4180A-HZ-0.6-12.800-3.3



ELECTRICAL SPECIFICATIONS

PARAMETER	SYMBOL	CONDITION	VALUE			UNIT
			Min.	Typ.	Max.	
Nominal Frequency	f_0		12.800			MHz
Supply Voltage	V_s	$V_s \pm 5\%$ @ 25°C	3.135	3.3	3.465	V
Power Consumption	P_s	Steady state, @ 25°C		1.5		W
	$P_{s,w}$	During warm-up		3.5	4.0	W
Load	O_{Load}	Output to Ground	5	10	15	pF
Frequency Calibration	$\Delta f/f_0$	$V_s = 3.3V$, $T_a = 25^\circ C$, at the time of shipment	-1		+1	ppm
Frequency Stability vs. Temperature	$\Delta f/f_0 (T_a)$	$T_a = -20^\circ C \dots +70^\circ C$	-6		+6	ppb
Frequency Stability vs. Load Change	$\Delta f/f_0 (\Delta R_L)$	$T_a = 25^\circ C$, $V_s \pm 5\%$, load=10pF	-2		+2	ppb
Frequency Stability vs. Supply Voltage	$\Delta f/f_0 (\Delta V_s)$		-2		+2	ppb
Short Term Stability		Still air, 1.0 s		0.01		ppb
Aging, after 30 days of operation	$\Delta f/\Delta t_d$	Daily	0.5		+0.5	ppb
	$\Delta f/\Delta t_y$	Per Year	-80		+80	ppb
	$\Delta f/\Delta t_y$	Per 20 Years	-1.0		+1.0	ppm
Warm-up Time		$T_a = 25^\circ C$, to within 6 ppb of frequency @ 60 minutes.			5	min
Operating Temperature range	T_a		-20		+70	°C
Operable Temperature range	T_a		-40		+85	°C
Start-up Time					50	ms

OX4180A-HZ-0.6-12.800-3.3

CMOS Output Characteristics

PARAMETER	SYMBOL	CONDITION	VALUE			UNIT
			Min.	Typ.	Max.	
Output signals Levels	VOH		2.4			V
	VOL				0.4	V
Rise/ Fall Time	Tr/Tf	10% to 90% Vout			5.0	ns
Duty Cycle	DC	Measured @ 1.65V	40	50	60	%
Load				15		pF

PHASE NOISE

PARAMETER	SYMBOL	CONDITION	VALUE			UNIT
			Min.	Typ.	Max.	
@10 Hz Offset	$\mathcal{L}(\Delta f)$			-115		dBc/Hz
@100 Hz Offset	$\mathcal{L}(\Delta f)$			-135		dBc/Hz
@1 kHz Offset	$\mathcal{L}(\Delta f)$			-145		dBc/Hz
@10 kHz Offset	$\mathcal{L}(\Delta f)$			-146		dBc/Hz

Environmental

Shock	500 G's 1ms, half sine, 3 shocks per direction, per MIL-STD 202F, Method 213B Test condition D
Sinusoidal Vibration	0.06" D.A. or 10G's peak, 10 to 500Hz, per MIL-STD 202F, Method 204D, Test condition A
Random vibration	5.35 G's rms, 20 to 2000Hz per MIL-STD-202F, Method 214, Test Condition 1A, 15 minutes each axis.
Moisture	10 cycles, 95% RH, per MIL-STD-202F, Method 112.
Resistance to solder heat	Per MIL-STD-202F, Method 210, Condition E

OX4180A-HZ-0.6-12.800-3.3

MECHANICAL DIMENSIONS AND PIN FUNCTIONING

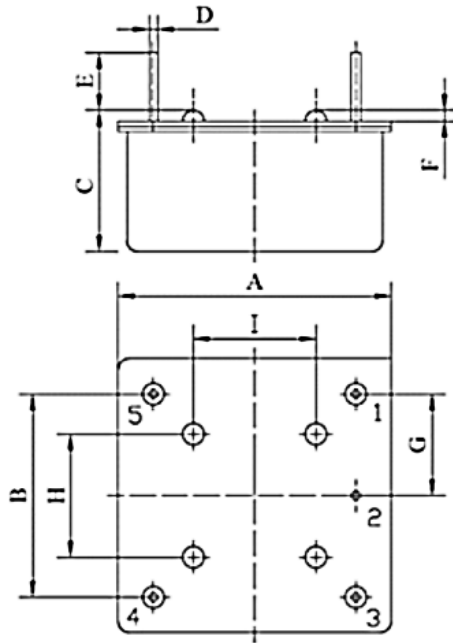

Symbol	Dimensions (mm)	
	Min	Nominal
A		25.6
B	18.80	19.20
C		12.7
D	0.70	0.90
E	4.60	6.20
F	0.40	0.70
G	9.40	9.60
H	11.5 nominal	
I	11.5 nominal	

PIN	SYMBOL	FUNCTION
1	RF OUT	RF Output
2	GND	Case/Ground
3	NC	NO CONNECTED
4	NC	NO CONNECTED
5	Vs	Supply Voltage

	Signed	Date
Created	CP	January, 15, 2019
Eng. approved	SP	January
REV A		

Raltron Electronics / RAMI Technology USA, LLC, including its affiliates, employees, agents and other persons acting on its behalf (collectively Raltron/RAMI Tech), disclaim any and all liability for any errors or inaccuracies contained in this data sheet. While Raltron/RAMI Tech has made every reasonable effort to ensure the accuracy of all product information, specifications and data contained herein, Raltron/RAMI Tech does not guarantee that the information is accurate, reliable or current. The product information is provided only for reference purposes only and is subject to change, correction or revision, at any time without notice. Raltron/RAMI Tech does not assume any liability arising out of an application or use of any product described herein and disclaims any warranties expressed or implied. The user of products in such applications shall assume all risks of such use and will agree to hold Raltron/RAMI Tech, harmless against all damages.

Copyright © 2016, Raltron Electronics / RAMI Technology USA, LLC. All rights reserved. No part of this document may be reproduced in any form without the prior written permission of Raltron Electronics / RAMI Technology USA, LLC.

OX4180A-HZ-0.6-12.800-3.3