

1	2	3	4	5	6	7
SIGN	DATE	DESCRIPTION			APPROVER	
A						
A						
A						

Technical Data:

Material:

- Contact (metal housing): Brass
- Wire guard: Stainless steel
- Surface of solder tail: tin plated
- Insulator body (housing): Polyamide (Glass filled) (UL 94V-0)
- Standard Color: Grey

Electrical:

- Voltage rating: 300VAC
- Current rating: 16 Amps / way max
- Contact resistance: $20m\Omega$ (max)
- Insulation resistance: $5000M\Omega/1000V$
- Withstanding Voltage: 1500VAC (1min) Test time=60sec/1pcs
- Wire range: 14-28AWG

Mechanical:

- Operating temperature: -30°C to +105°C
- Soldering ability: 95% coverage (min)
Test temperature= 230°C ± 10°C
Test time= 4sec ± 0.5sec
- Soldering reliability:
Test temperature= 250°C ± 10°C
5 seconds max

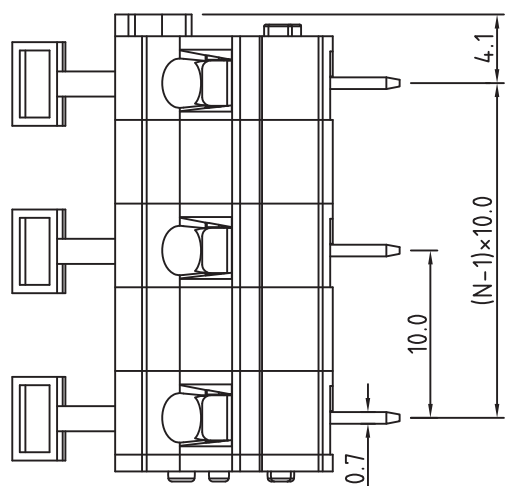
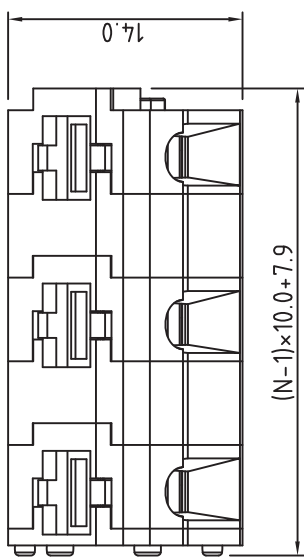
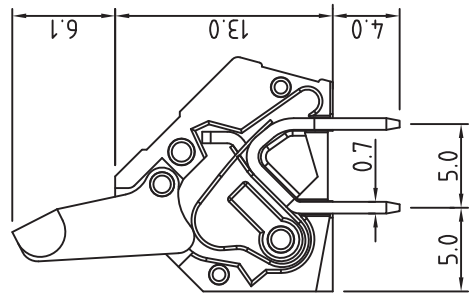

N=Number of contacts

P.C.B LAYOUT

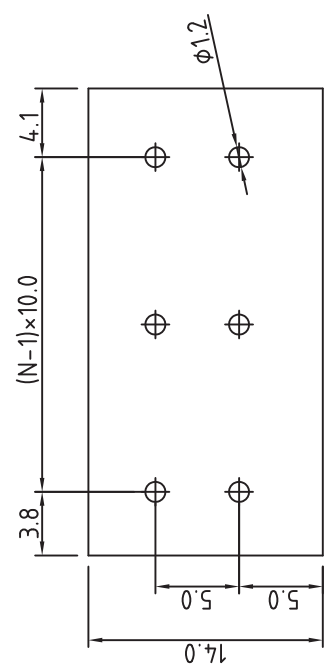

THESE DRAWINGS AND SPECIFICATIONS ARE THE PROPERTY OF ON-SHORE TECHNOLOGY, INC. AND SHALL NOT BE REPRODUCED, COPIED OR USED IN ANY MANNER WITHOUT THE PRIOR WRITTEN CONSENT OF ON-SHORE TECHNOLOGY, INC.



ON-SHORE TECHNOLOGY, INC.

PART NAME: OSTHT - 10.0mm Series		TITLE:	
PART NO.: OSTHTXX1080 (XX DENOTES NUMBER OF POSITIONS)		DWG NAME: OSTHTXX1080.DWG	
APPROVED BY	CHECKED BY	DESIGNED BY	DRAWN BY
		Marvin	Marvin
		2003.02.09	2003.02.09
CUSTOM NO.:		UNITS: mm	
		SCALE: 3/1	
		REVISION: B1	
Tolerance		X. ±0.50	
X.X ±0.30		X.XX ±0.10	
X° ±1°			

E D C B A

1 2 3 4 5 6 7