

| SIGN  | DATE       | DESCRIPTION                  | APPROVER |
|---|------------|------------------------------|----------|
| △   | 2008.11.01 | Amps changed from 10A to 15A |          |
| △   | 2008.11.01 | CUL Safety approval added    |          |
| <i>THIS IS CAD DRAWING, DO NOT REVISE MANUALLY!!!</i> |            |                              |          |

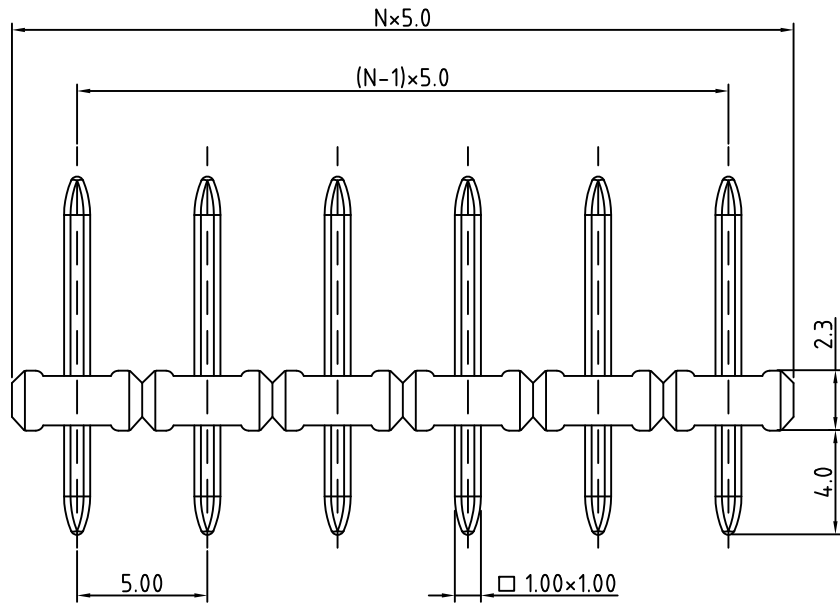

N = Number of poles

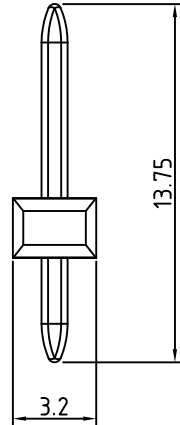

Material:

- Insulating body Thermoplastic ( UL94V-0 )
- Solid PIN Tin plated

Electrical:

- Voltage rating: 300V
- Current rating: 15A
- Withstanding Voltage: 1.6KV
- Operating temperature: -40°C to +115°C
- Soldering temperature: 250°C ± 10°C / 5 Sec
- △ Safety approval: us

RoHS Compliant

PART NUMBER:

OSTEPXX0000

No. of Poles  
02: 2 Poles  
:  
:  
24: 24 Poles

COLOR  
0: Black

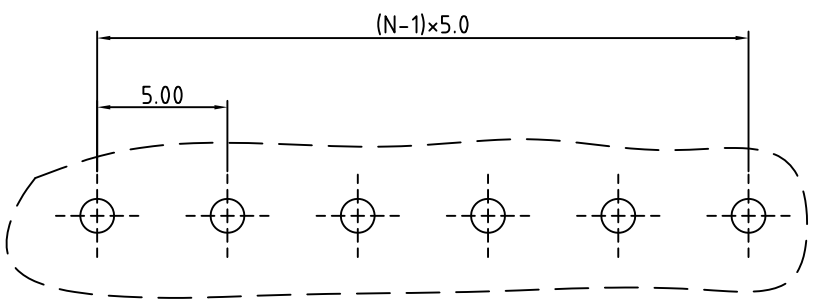

P.C.B. LAYOUT

THESE DRAWINGS AND SPECIFICATIONS ARE THE PROPERTY OF ON-SHORE TECHNOLOGY, INC. AND SHALL NOT BE REPRODUCED, COPIED OR USED IN ANY MANNER WITHOUT THE PRIOR WRITTEN CONSENT OF ON-SHORE TECHNOLOGY, INC.



|          |             |  |                     |                 |            |
|----------|-------------|--|---------------------|-----------------|------------|
| TITLE    |             | OSTEP 5.0 Series ( L=13.75mm , PIN 1.0x1.0mm ) |                     |                 |            |
| PART NO. | OSTEPXX0000 |  | DWG NO.             | OSTEPXX0000.DWG |            |
| APPROVED | CHECKED     | DESIGNED                                       | DRAWN               | CUST NO.        |            |
|          |             | Jacke<br>2008.12.23                            | Jacke<br>2008.12.23 |                 |            |
|          |             |  |                     | SHEET: 01/01    | REV.: B    |
|          |             |  |                     |                 | Tolerance  |
|          |             |  |                     |                 | X. ±0.50   |
|          |             |  |                     |                 | X.X ±0.30  |
|          |             |  |                     |                 | X.XX ±0.10 |
|          |             |  |                     |                 | X° ±1°     |