

Product data sheet

Specifications

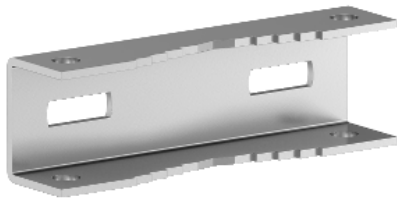

Post fixing device WM Spacial,
length 200. For post max 675. Max.
Load:100kg.

NSYSFPSC20

 To be discontinued on: 31 August 2023

 To be discontinued

Main

Range	Spacial
Accessory / separate part category	Fixing accessory
Product or component type	Post fixing device
Device application	Multi-purpose
Enclosure nominal dimensions	-
Mounting location	Rear of enclosure
Range compatibility	Spacial (Spacial SBM)
Device composition	fixing elements 2 support rail 2 strip
Quantity per set	Set of 1

Complementary

Material	Galvanised steel
Fixing mode	By fixing element - screw type M8 - to the inserts in the rear of the enclosure location Minimum diameter 150 mm Maximum diameter 215 mm
Permanent permissible load	100 kg
Height	45 mm
Width	195 mm
Depth	32.5 mm
Net weight	1.048 kg

Packing Units

Unit Type of Package 1	PCE
Number of Units in Package 1	1
Package 1 Height	25.0 cm
Package 1 Width	18.0 cm
Package 1 Length	6.5 cm
Package 1 Weight	1.048 kg

Offer Sustainability

REACH Regulation	REACH Declaration
REACH free of SVHC	Yes
EU RoHS Directive	Pro-active compliance (Product out of EU RoHS legal scope) EU RoHS Declaration
Toxic heavy metal free	Yes
Mercury free	Yes
China RoHS Regulation	China RoHS declaration Pro-active China RoHS declaration (out of China RoHS legal scope)
RoHS exemption information	Yes

Recommended replacement(s)

NSYSFPSC20 is replaced by:

1x



Post fixing device WM Spacial, length 300. For post max 675. Max. Load:100kg.
NSYSFPSC30