

3215031

<https://www.phoenixcontact.com/us/products/3215031>

Please be informed that the data shown in this PDF document is generated from our online catalog. Please find the complete data in the user documentation. Our general terms of use for downloads are valid.



High-current terminal block, nom. voltage: 1500 V, nominal current: 309 A, number of connections: 2, number of positions: 1, connection method: PowerTurn connection, 1 level, cross section: 50 mm<sup>2</sup> - 150 mm<sup>2</sup>, mounting type: direct screw connection, color: blue

Commercial data

|                                      |                                |
|--------------------------------------|--------------------------------|
| Item number                          | 3215031                        |
| Packing unit                         | 1 pc                           |
| Minimum order quantity               | 3 pc                           |
| Note                                 | Made to order (non-returnable) |
| Sales key                            | BE22                           |
| Product key                          | BE2211                         |
| Catalog page                         | Page 131 (C-1-2017)            |
| GTIN                                 | 4046356903493                  |
| Weight per piece (including packing) | 355.2 g                        |
| Weight per piece (excluding packing) | 355.2 g                        |
| Customs tariff number                | 85369010                       |
| Country of origin                    | PL                             |

# PTPOWER 150 F BU - High-current terminal block



3215031

<https://www.phoenixcontact.com/us/products/3215031>

## Technical data

### Product properties

|                       |                             |
|-----------------------|-----------------------------|
| Product type          | High current terminal block |
| Number of positions   | 1                           |
| Pitch                 | 31 mm                       |
| Number of connections | 2                           |
| Number of rows        | 1                           |
| Potentials            | 1                           |

### Insulation characteristics

|                      |     |
|----------------------|-----|
| Overvoltage category | III |
| Degree of pollution  | 3   |

### Electrical properties

|                     |      |
|---------------------|------|
| Rated surge voltage | 8 kV |
|---------------------|------|

### Connection data

|                                 |                     |
|---------------------------------|---------------------|
| Number of connections per level | 2                   |
| Nominal cross section           | 150 mm <sup>2</sup> |

#### 1 level

|  |  |
|--|--|
| Stripping length   | 40 mm  |
| Internal cylindrical gage  | B14  |
| Connection in acc. with standard   | IEC 60947-7-1  |
| Conductor cross section rigid  | 50 mm <sup>2</sup> ... 150 mm <sup>2</sup>               |
| Cross section AWG  | 1/0 ... 300 kcmil (converted acc. to IEC)                |
| Conductor cross section flexible   | 50 mm <sup>2</sup> ... 150 mm <sup>2</sup>               |
| Conductor cross section, flexible [AWG]  | 1/0 ... 300 kcmil (converted acc. to IEC)                |
| Conductor cross-section flexible (ferrule without plastic sleeve)                  | 50 mm <sup>2</sup> ... 95 mm <sup>2</sup>                |
| Flexible conductor cross section (ferrule with plastic sleeve)                     | 50 mm <sup>2</sup> ... 95 mm <sup>2</sup>                |
| Cross-section with insertion bridge, rigid   | 50 mm <sup>2</sup> ... 150 mm <sup>2</sup>               |
| Cross-section with insertion bridge, flexible                                      | 50 mm <sup>2</sup> ... 150 mm <sup>2</sup>               |
| Cross-section with insertion bridge, flexible, with ferrule without plastic sleeve | 50 mm <sup>2</sup> ... 95 mm <sup>2</sup>                |
| Cross-section with insertion bridge, flexible, with ferrule with plastic sleeve    | 50 mm <sup>2</sup> ... 95 mm <sup>2</sup>                |
| Nominal current  | 309 A  |
| Maximum load current   | 309 A (with 150 mm <sup>2</sup> conductor cross section) |
| Nominal voltage  | 1500 V DC  |
|  | 1000 V AC  |

#### 1 level Connection cross sections directly pluggable

|   |  |
|---|--|
| Conductor cross section rigid                                     | 50 mm <sup>2</sup> ... 150 mm <sup>2</sup> |
| Conductor cross-section flexible (ferrule without plastic sleeve) | 50 mm <sup>2</sup> ... 95 mm <sup>2</sup>  |

# PTPOWER 150 F BU - High-current terminal block



3215031

<https://www.phoenixcontact.com/us/products/3215031>

Flexible conductor cross section (ferrule with plastic sleeve)

50 mm<sup>2</sup> ... 95 mm<sup>2</sup>

## Dimensions

Dimensional drawing

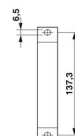

Width

31 mm

Height

108.3 mm

Drill hole spacing

137.2 mm

Hole diameter

6.5 mm

Pitch

31 mm

## Material specifications

Color

blue

Flammability rating according to UL 94

V0

Insulating material group

I

Insulating material

PA

Static insulating material application in cold

-60 °C

Temperature index of insulation material (DIN EN 60216-1 (VDE 0304-21))

125 °C

Relative insulation material temperature index (Elec., UL 746 B)

130 °C

Fire protection for rail vehicles (DIN EN 45545-2) R22

HL 1 - HL 3

Fire protection for rail vehicles (DIN EN 45545-2) R23

HL 1 - HL 3

Fire protection for rail vehicles (DIN EN 45545-2) R24

HL 1 - HL 3

Fire protection for rail vehicles (DIN EN 45545-2) R26

HL 1 - HL 3

Calorimetric heat release NFPA 130 (ASTM E 1354)

27,5 MJ/kg

Surface flammability NFPA 130 (ASTM E 162)

passed

Specific optical density of smoke NFPA 130 (ASTM E 662)

passed

Smoke gas toxicity NFPA 130 (SMP 800C)

passed

## Mechanical properties

Mechanical data

Open side panel

No

Technical data

Drill hole spacing

137.2 mm

## Standards and regulations

Connection in acc. with standard

IEC 60947-7-1

## Mounting

Mounting type

direct screw connection

# PTPOWER 150 F BU - High-current terminal block



3215031

<https://www.phoenixcontact.com/us/products/3215031>

## Drawings

Dimensional drawing

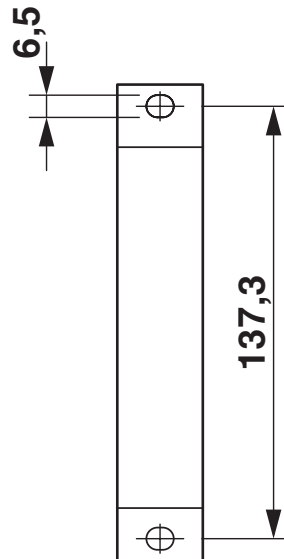

Circuit diagram



# PTPOWER 150 F BU - High-current terminal block



3215031

<https://www.phoenixcontact.com/us/products/3215031>

## Classifications

ETIM

|          |          |
|----------|----------|
| ETIM 7.0 | EC000897 |
|----------|----------|

# PTPOWER 150 F BU - High-current terminal block



3215031

<https://www.phoenixcontact.com/us/products/3215031>

## Environmental product compliance

|            |   |
|------------|---|
| China RoHS | Environmentally friendly use period: unlimited = EFUP-e |
|            | No hazardous substances above threshold values          |

# PTPOWER 150 F BU - High-current terminal block



3215031

<https://www.phoenixcontact.com/us/products/3215031>

## Accessories

**i** Note: Applying some accessories below might limit this product.

### EB 2-31/PT - Insertion bridge

3215057

<https://www.phoenixcontact.com/us/products/3215057>

Insertion bridge, pitch: 31 mm, number of positions: 2, length: 78 mm, color: red



**i** Max. current carrying capacity: 232 A

### EB 3-31/PT - Insertion bridge

3215058

<https://www.phoenixcontact.com/us/products/3215058>

Insertion bridge, pitch: 31 mm, number of positions: 3, length: 78 mm, color: red



**i** Max. current carrying capacity: 232 A

# PTPOWER 150 F BU - High-current terminal block



3215031

<https://www.phoenixcontact.com/us/products/3215031>

## AGK 10-PTPOWER - Pick-off terminal

3260145

<https://www.phoenixcontact.com/us/products/3260145>



Pick-off terminal, nom. voltage: 1500 V, nominal current: 57 A, number of connections: 2, connection method: Push-in connection, 1 level, Rated cross section: 10 mm<sup>2</sup>, cross section: 0.5 mm<sup>2</sup> - 16 mm<sup>2</sup>, mounting type: on base element, color: gray

---

## AGK 10-PTPOWER BU - Pick-off terminal

3260148

<https://www.phoenixcontact.com/us/products/3260148>



Pick-off terminal, nom. voltage: 1500 V, nominal current: 57 A, number of connections: 2, connection method: Push-in connection, 1 level, Rated cross section: 10 mm<sup>2</sup>, cross section: 0.5 mm<sup>2</sup> - 16 mm<sup>2</sup>, mounting type: on base element, color: blue



# PTPOWER 150 F BU - High-current terminal block



3215031

<https://www.phoenixcontact.com/us/products/3215031>

## AGK 10-PTPOWER GN/YE - Pick-off terminal

3260151

<https://www.phoenixcontact.com/us/products/3260151>



Pick-off terminal, nom. voltage: 1500 V, nominal current: 57 A, number of connections: 2, connection method: Push-in connection, 1 level, Rated cross section: 10 mm<sup>2</sup>, cross section: 0.5 mm<sup>2</sup> - 16 mm<sup>2</sup>, mounting type: on base element, color: green/yellow

---

## AGK 10-PTPOWER BK/YE - Pick-off terminal

3260154

<https://www.phoenixcontact.com/us/products/3260154>



Pick-off terminal, nom. voltage: 1500 V, nominal current: 57 A, number of connections: 2, connection method: Push-in connection, 1 level, Rated cross section: 10 mm<sup>2</sup>, cross section: 0.5 mm<sup>2</sup> - 16 mm<sup>2</sup>, mounting type: on base element, color: black/yellow

# PTPOWER 150 F BU - High-current terminal block



3215031

<https://www.phoenixcontact.com/us/products/3215031>

## SZF 3-1,0X5,5 - Screwdriver

1206612

<https://www.phoenixcontact.com/us/products/1206612>



Actuation tool, for ST terminal blocks, also suitable for use as a bladed screwdriver, size: 1.0 x 5.5 x 150 mm, 2-component grip, with non-slip grip

---

## NS 35/15 PERF 2000MM - DIN rail perforated

1201730

<https://www.phoenixcontact.com/us/products/1201730>



DIN rail perforated, similar to EN 60715, material: Steel, galvanized, passivated with a thick layer, Standard profile, color: silver, Pack of 25 (50 m)

# PTPOWER 150 F BU - High-current terminal block



3215031

<https://www.phoenixcontact.com/us/products/3215031>

## NS 35/15 UNPERF 2000MM - DIN rail, unperforated

1201714

<https://www.phoenixcontact.com/us/products/1201714>



DIN rail, unperforated, similar to EN 60715, material: Steel, galvanized, passivated with a thick layer, Standard profile, color: silver, Pack of 25 (50 m)

---

## NS 35/15 WH PERF 2000MM - DIN rail perforated

0806602

<https://www.phoenixcontact.com/us/products/0806602>



DIN rail perforated, similar to EN 60715, material: Steel, Galvanized, white passivated, Standard profile, color: white, Pack of 25 (50 m)

# PTPOWER 150 F BU - High-current terminal block



3215031

<https://www.phoenixcontact.com/us/products/3215031>

## NS 35/15 WH UNPERF 2000MM-VPE 10 - DIN rail, unperforated

1204135

<https://www.phoenixcontact.com/us/products/1204135>



DIN rail, unperforated, similar to EN 60715, material: Steel, Galvanized, white passivated, Standard profile, color: silver, Pack of 10 (20 m)

---

## NS 35/15 AL UNPERF 2000MM - DIN rail, unperforated

1201756

<https://www.phoenixcontact.com/us/products/1201756>



DIN rail, unperforated, similar to EN 60715, material: Aluminum, uncoated, Standard profile, color: silver

# PTPOWER 150 F BU - High-current terminal block



3215031

<https://www.phoenixcontact.com/us/products/3215031>

## NS 35/15 ZN PERF 2000MM - DIN rail perforated

1206599

<https://www.phoenixcontact.com/us/products/1206599>



DIN rail perforated, similar to EN 60715, material: Steel, galvanized, Standard profile, color: silver, Pack of 25 (50 m)

---

## NS 35/15 ZN UNPERF 2000MM - DIN rail, unperforated

1206586

<https://www.phoenixcontact.com/us/products/1206586>



DIN rail, unperforated, similar to EN 60715, material: Steel, galvanized, Standard profile, color: silver, Pack of 25 (50 m)

# PTPOWER 150 F BU - High-current terminal block



3215031

<https://www.phoenixcontact.com/us/products/3215031>

## NS 35/15 CU UNPERF 2000MM-VPE 10 - DIN rail, unperforated

1201895

<https://www.phoenixcontact.com/us/products/1201895>



DIN rail, unperforated, similar to EN 60715, material: Copper, uncoated, Standard profile, color: copper-colored, Pack of 10 (20 m)

---

## NS 35/15 CAP - End cap

1206573

<https://www.phoenixcontact.com/us/products/1206573>

DIN rail end piece, for DIN rail NS 35/15



# PTPOWER 150 F BU - High-current terminal block



3215031

<https://www.phoenixcontact.com/us/products/3215031>

## E/AL-NS 35 - End clamp

1201662

<https://www.phoenixcontact.com/us/products/1201662>



End clamp, for end support of UKH 50 to UKH 240, is pushed onto DIN rail NS 35 and fixed with 2 screws, width: 10 mm, color: aluminum

---

## TMT (EX9,5)R - Marker for terminal blocks

0828295

<https://www.phoenixcontact.com/us/products/0828295>



Marker for terminal blocks, Roll, white, unlabeled, can be labeled with: THERMOMARK E.300 (D)/600 (D), THERMOMARK ROLL 2.0, THERMOMARK ROLL, THERMOMARK ROLL X1, THERMOMARK ROLLMASTER 300/600, THERMOMARK X1.2, mounting type: snapped, snap into tall marker groove, for terminal block width: 30000 mm, lettering field size: 9.5 x 50000 mm, Number of individual labels: 1

# PTPOWER 150 F BU - High-current terminal block



3215031

<https://www.phoenixcontact.com/us/products/3215031>

## US-TM 100 - Marker for terminal blocks

0829255

<https://www.phoenixcontact.com/us/products/0829255>



Marker for terminal blocks, Card, white, unlabeled, can be labeled with: BLUEMARK ID COLOR, BLUEMARK ID, THERMOMARK PRIME, THERMOMARK CARD 2.0, THERMOMARK CARD, mounting type: snapped, lettering field size: 104 x 9.8 mm, Number of individual labels: 13

---

## ZB 10:UNBEDRUCKT - Zack marker strip

1053001

<https://www.phoenixcontact.com/us/products/1053001>



Zack marker strip, Strip, white, unlabeled, can be labeled with: PLOTMARK, CMS-P1-PLOTTER, mounting type: snapped, for terminal block width: 10.2 mm, lettering field size: 10.5 x 10.15 mm, Number of individual labels: 10



# PTPOWER 150 F BU - High-current terminal block



3215031

<https://www.phoenixcontact.com/us/products/3215031>

## ZB 10 CUS - Zack marker strip

0824941

<https://www.phoenixcontact.com/us/products/0824941>

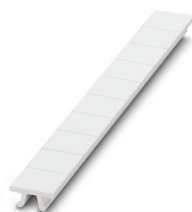

Zack marker strip, can be ordered: Strip, white, labeled according to customer specifications, mounting type: snap into tall marker groove, for terminal block width: 10.2 mm, lettering field size: 10,15 x 10,5 mm, Number of individual labels: 10

---

## ZB10,LGS:FORTL.ZAHLEN - Zack marker strip

1053014

<https://www.phoenixcontact.com/us/products/1053014>



Zack marker strip, Strip, white, labeled, can be labeled with: CMS-P1-PLOTTER, printed horizontally: consecutive numbers 1 ... 10, 11 ... 20, etc. up to 91 ... 100, mounting type: snapped, for terminal block width: 10.2 mm, lettering field size: 10,15 x 10,5 mm, Number of individual labels: 10

# PTPOWER 150 F BU - High-current terminal block



3215031

<https://www.phoenixcontact.com/us/products/3215031>

## ZB10,QR:FORTL.ZAHLEN - Zack marker strip

1053027

<https://www.phoenixcontact.com/us/products/1053027>



Zack marker strip, Strip, white, labeled, can be labeled with: CMS-P1-PLOTTER, Printed vertically: consecutive numbers 1 ... 10, 11 ... 20, etc. up to 91 ... 100, mounting type: snapped, for terminal block width: 10.2 mm, lettering field size: 10,15 x 10,5 mm, Number of individual labels: 10

---

## ZB10,LGS:L1-N,PE - Marker for terminal blocks

1053412

<https://www.phoenixcontact.com/us/products/1053412>

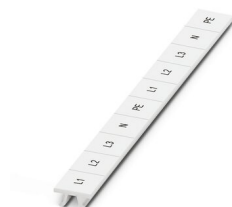

Marker for terminal blocks, Strip, white, labeled, can be labeled with: CMS-P1-PLOTTER, horizontal: L1, L2, L3, N, PE, L1, L2, L3, N, PE, mounting type: snapped, for terminal block width: 10.2 mm, lettering field size: 10,15 x 10,5 mm, Number of individual labels: 10

# PTPOWER 150 F BU - High-current terminal block



3215031

<https://www.phoenixcontact.com/us/products/3215031>

## ZB10,LGS:U-N - Marker for terminal blocks

1053438

<https://www.phoenixcontact.com/us/products/1053438>

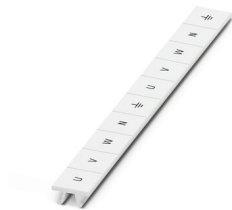

Marker for terminal blocks, Strip, white, labeled, can be labeled with: CMS-P1-PLOTTER, horizontal: U, V, W, N, GND, U, V, W, N, GND, mounting type: snapped, for terminal block width: 10.2 mm, lettering field size: 10,15 x 10,5 mm, Number of individual labels: 10

---

## UC-TM 10 - Marker for terminal blocks

0818069

<https://www.phoenixcontact.com/us/products/0818069>



Marker for terminal blocks, Sheet, white, unlabeled, can be labeled with: BLUEMARK ID COLOR, BLUEMARK ID, BLUEMARK CLED, PLOTMARK, CMS-P1-PLOTTER, mounting type: snapped, for terminal block width: 10.2 mm, lettering field size: 9.6 x 10.5 mm, Number of individual labels: 48

# PTPOWER 150 F BU - High-current terminal block



3215031

<https://www.phoenixcontact.com/us/products/3215031>

## UC-TM 10 CUS - Marker for terminal blocks

0824605

<https://www.phoenixcontact.com/us/products/0824605>



Marker for terminal blocks, can be ordered: by sheet, white, labeled according to customer specifications, mounting type: snap into tall marker groove, for terminal block width: 10.2 mm, lettering field size: 9.6 x 10.5 mm, Number of individual labels: 48

---

## UCT-TM 10 - Marker for terminal blocks

0829142

<https://www.phoenixcontact.com/us/products/0829142>



Marker for terminal blocks, Sheet, white, unlabeled, can be labeled with: TOPMARK NEO, TOPMARK LASER, BLUEMARK ID COLOR, BLUEMARK ID, BLUEMARK CLED, THERMOMARK PRIME, THERMOMARK CARD 2.0, THERMOMARK CARD, mounting type: snapped, for terminal block width: 10.2 mm, lettering field size: 8.9 x 9.6 mm, Number of individual labels: 36

# PTPOWER 150 F BU - High-current terminal block



3215031

<https://www.phoenixcontact.com/us/products/3215031>

## UCT-TM 10 CUS - Marker for terminal blocks

0829623

<https://www.phoenixcontact.com/us/products/0829623>



Marker for terminal blocks, can be ordered: by sheet, white, labeled according to customer specifications, mounting type: snap into tall marker groove, for terminal block width: 10.2 mm, lettering field size: 8.9 x 9.6 mm, Number of individual labels: 36

---

## ZB 20,3:UNPRINTED - Zack marker strip

0820248

<https://www.phoenixcontact.com/us/products/0820248>



Zack marker strip, Strip, white, unlabeled, can be labeled with: PLOTMARK, CMS-P1-PLOTTER, mounting type: snapped, for terminal block width: 20.3 mm, lettering field size: 10.5 x 20.25 mm, Number of individual labels: 5

# PTPOWER 150 F BU - High-current terminal block



3215031

<https://www.phoenixcontact.com/us/products/3215031>

## ZB 20,3 CUS - Zack marker strip

0824948

<https://www.phoenixcontact.com/us/products/0824948>



Zack marker strip, can be ordered: Strip, white, labeled according to customer specifications, mounting type: snap into tall marker groove, for terminal block width: 20.3 mm, lettering field size: 10.5 x 20.25 mm, Number of individual labels: 5

---

## MPS-MT - Test plugs

0201744

<https://www.phoenixcontact.com/us/products/0201744>



Test plugs, with solder connection up to 1 mm<sup>2</sup> conductor cross section, number of positions: 1, color: gray

# PTPOWER 150 F BU - High-current terminal block



3215031

<https://www.phoenixcontact.com/us/products/3215031>

## MPS-IH WH - Insulating sleeve

0201663

<https://www.phoenixcontact.com/us/products/0201663>

Insulating sleeve, color: white



---

## MPS-IH RD - Insulating sleeve

0201676

<https://www.phoenixcontact.com/us/products/0201676>

Insulating sleeve, color: red



# PTPOWER 150 F BU - High-current terminal block



3215031

<https://www.phoenixcontact.com/us/products/3215031>

## MPS-IH BU - Insulating sleeve

0201689

<https://www.phoenixcontact.com/us/products/0201689>

Insulating sleeve, color: blue

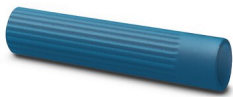

---

## MPS-IH YE - Insulating sleeve

0201692

<https://www.phoenixcontact.com/us/products/0201692>

Insulating sleeve, color: yellow





# PTPOWER 150 F BU - High-current terminal block



3215031

<https://www.phoenixcontact.com/us/products/3215031>

## MPS-IH GN - Insulating sleeve

0201702

<https://www.phoenixcontact.com/us/products/0201702>

Insulating sleeve, color: green



---

## MPS-IH GY - Insulating sleeve

0201728

<https://www.phoenixcontact.com/us/products/0201728>

Insulating sleeve, color: gray



## PTPOWER 150 F BU - High-current terminal block

3215031

<https://www.phoenixcontact.com/us/products/3215031>



## MPS-IH BK - Insulating sleeve

0201731

<https://www.phoenixcontact.com/us/products/0201731>

Insulating sleeve, color: black



## PROJECT COMPLETE - Software

1050453

<https://www.phoenixcontact.com/us/products/1050453>



Intuitive planning and marking software for configuring terminal strips and for professional marking of marking materials for terminal blocks, conductors, cables, devices, and systems. The software is available for download

# PTPOWER 150 F BU - High-current terminal block



3215031

<https://www.phoenixcontact.com/us/products/3215031>

## A 25 -40 - Ferrule

3241238

<https://www.phoenixcontact.com/us/products/3241238>



Ferrule, length: 40 mm, color: silver

---

## A 35 -40 - Ferrule

3241239

<https://www.phoenixcontact.com/us/products/3241239>



Ferrule, length: 40 mm, color: silver

# PTPOWER 150 F BU - High-current terminal block



3215031

<https://www.phoenixcontact.com/us/products/3215031>

## A 50 -40 - Ferrule

3241240

<https://www.phoenixcontact.com/us/products/3241240>



Ferrule, length: 40 mm, color: silver

---

## A 70 -40 - Ferrule

3241241

<https://www.phoenixcontact.com/us/products/3241241>



Ferrule, length: 40 mm, color: silver

# PTPOWER 150 F BU - High-current terminal block



3215031

<https://www.phoenixcontact.com/us/products/3215031>

## A 95 -40 - Ferrule

3241242

<https://www.phoenixcontact.com/us/products/3241242>



Ferrule, length: 40 mm, color: silver

---

## CRIMPFOX 50R - Crimping pliers

1212041

<https://www.phoenixcontact.com/us/products/1212041>



Crimping pliers, for ferrules without insulating collar according to DIN 46228 Part 1 and ferrules with insulating collar according to DIN 46228 Part 4, 35 mm<sup>2</sup> ... 50 mm<sup>2</sup>, lateral entry, WM crimp

# PTPOWER 150 F BU - High-current terminal block



3215031

<https://www.phoenixcontact.com/us/products/3215031>

## CRIMPFOX-M - Crimping pliers

1212072

<https://www.phoenixcontact.com/us/products/1212072>



Basic pliers, for accommodating dies for a wide range of type of contacts

---

## CRIMPFOX-C120 - Crimping pliers

1212318

<https://www.phoenixcontact.com/us/products/1212318>



Basic pliers, for accommodating dies for a wide range of type of contacts up to 120 mm<sup>2</sup>

---

Phoenix Contact 2023 © - all rights reserved  
<https://www.phoenixcontact.com>

Phoenix Contact USA  
586 Fulling Mill Road  
Middletown, PA 17057, United States  
(+717) 944-1300  
[info@phoenixcon.com](mailto:info@phoenixcon.com)