

HC-HV 6-ESTS - Contact insert



1773352

<https://www.phoenixcontact.com/us/products/1773352>

Please be informed that the data shown in this PDF document is generated from our online catalog. Please find the complete data in the user documentation. Our general terms of use for downloads are valid.



HEAVYCON male insert, for 690 V(III/3), with 6 N/O contacts and 2 switching contacts, screw connection

Commercial data

Item number	1773352
Packing unit	1 pc
Minimum order quantity	1 pc
Note	Made to order (non-returnable)
Sales key	BF61
Product key	BF7ABG
Catalog page	Page 201 (PC-2005)
GTIN	4017918103675
Weight per piece (including packing)	88.89 g
Weight per piece (excluding packing)	85.96 g
Customs tariff number	85366990
Country of origin	DE

HC-HV 6-ESTS - Contact insert

1773352

<https://www.phoenixcontact.com/us/products/1773352>



Technical data

Notes

General	For HEAVYCON-ADVANCE housing type B16 and HEAVYCON type HV6
---------	---

Product properties

Type	HV6
Product type	Contact insert with a fixed no. of positions
Number of positions	6
Connection profile	6+2+PE

Insulation characteristics

Overvoltage category	III
Degree of pollution	3

Dimensions

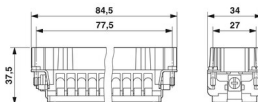
Dimensional drawing	
Width	34 mm
Height	35.5 mm
Length	84.5 mm

Connection data

Connection technology

Connection technology	Screw connection
-----------------------	------------------

Conductor connection

Conductor cross section	0.5 mm ² ... 2.5 mm ²
Connection cross section AWG	20 ... 14
Tightening torque	0.5 Nm
Stripping length of the individual wire	7 mm (N/O contacts) 7 mm (control contacts)

Electrical properties

Rated voltage (III/3)	400 V (Power contacts wire-ground) 250 V control contacts 690 V (Power contacts wire-ground)
Rated voltage for power contacts	400/690 V
Rated surge voltage	6 kV (N/O contacts) 4 kV (control contacts)
Rated current	16 A

HC-HV 6-ESTS - Contact insert

1773352

<https://www.phoenixcontact.com/us/products/1773352>



Test voltage	3 kV AC
--------------	---------

Mechanical properties

Mechanical data

Insertion/withdrawal cycles	≥ 500
-----------------------------	-------

Material specifications

Flammability rating according to UL 94	V0
Contact material	Copper alloy
Contact surface material	Ag
Contact carrier material	PA

Environmental and real-life conditions

Ambient conditions

Ambient temperature (operation)	-40 °C ... 125 °C (including heating up of contacts)
---------------------------------	--

Standards and regulations

Constructional and testing regulations	DIN VDE 0627/86
	DIN VDE 0110/02.79
	DIN VDE 0110-1/04.97
	IEC 60664-1, DIN IEC 60512
	IEC 60352
Tests	DIN VDE 0627/86
	DIN VDE 0110/02.79
	DIN VDE 0110-1/04.97
	IEC 60664-1, DIN IEC 60512
	IEC 60352

Drawings

Schematic diagram

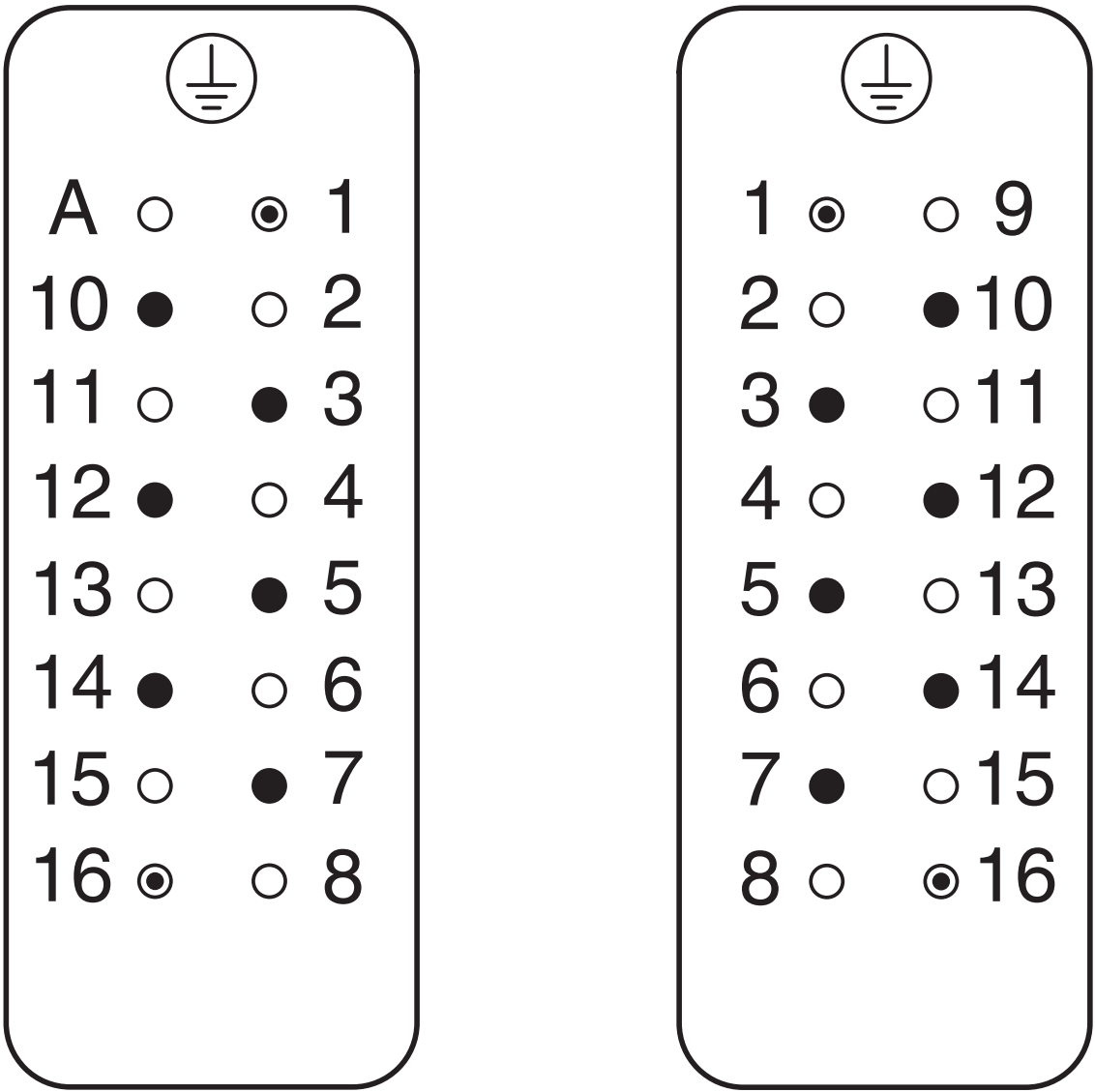

View termination side

Diagram

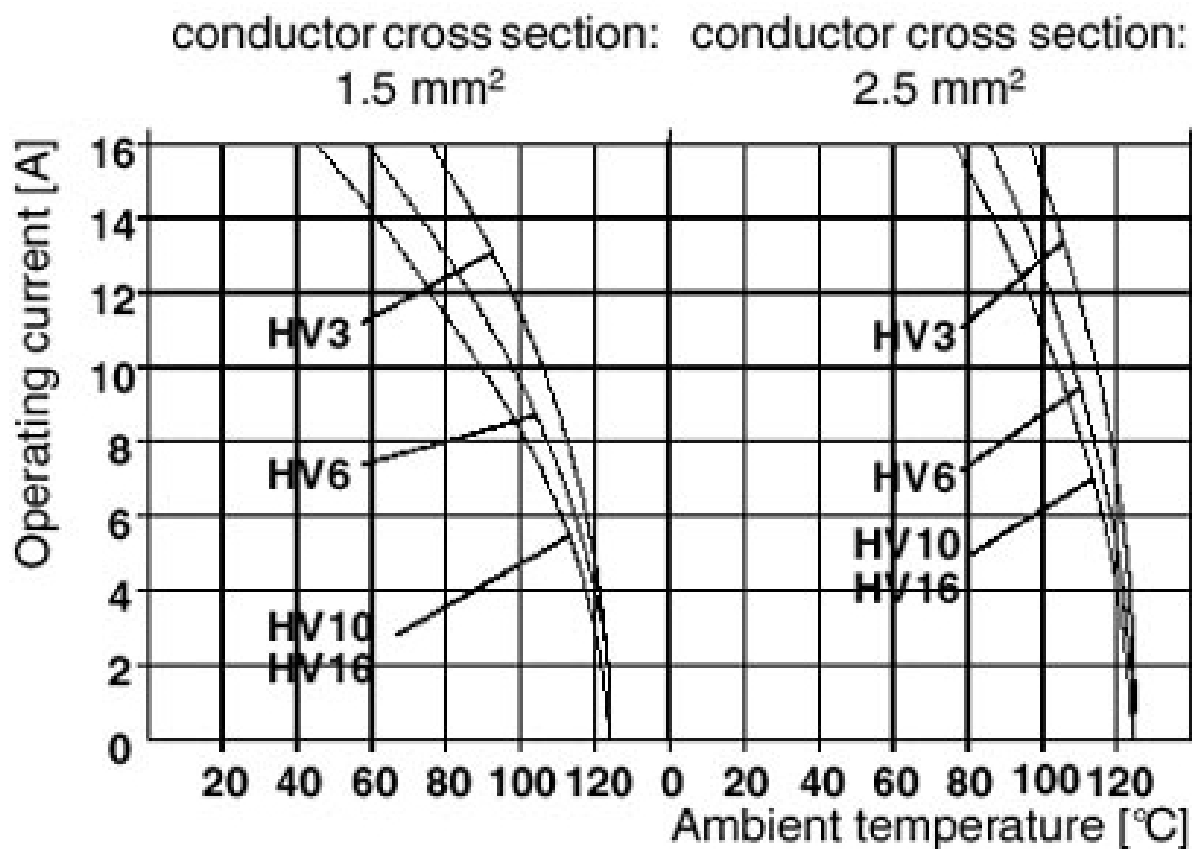

HC-HV 6-ESTS - Contact insert

1773352

<https://www.phoenixcontact.com/us/products/1773352>

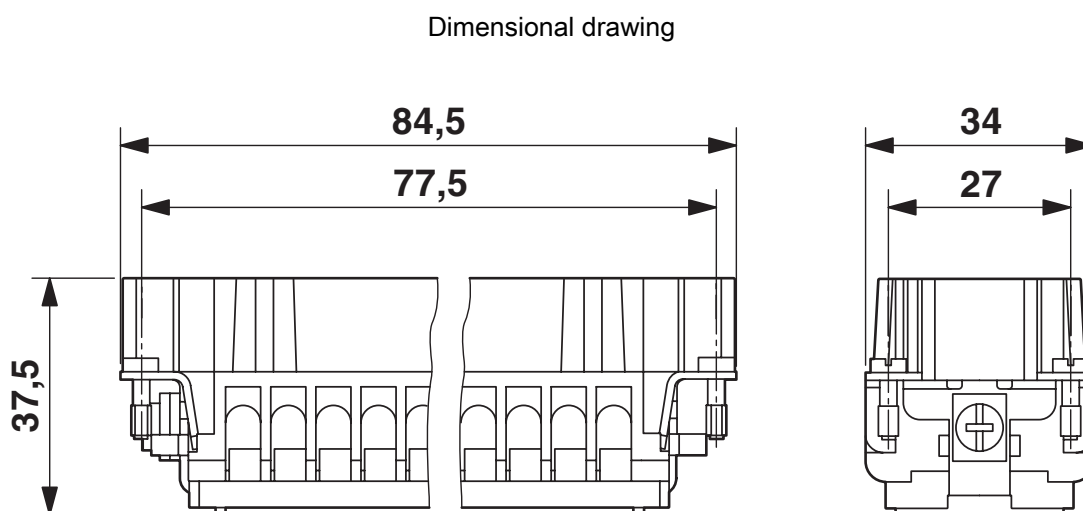
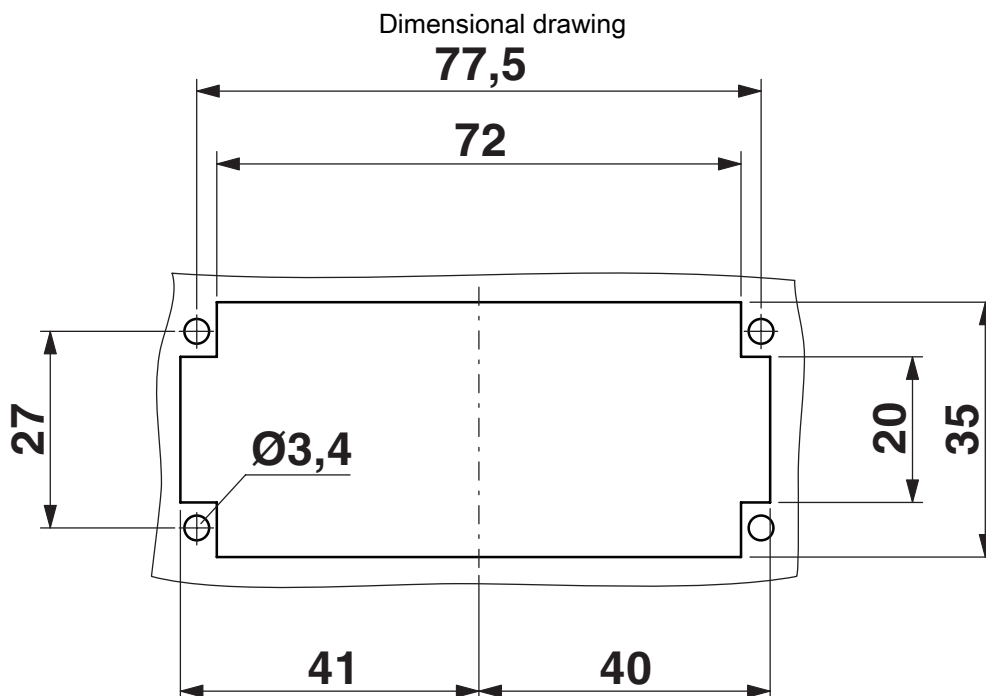

Male insert

HC-HV 6-ESTS - Contact insert

1773352

<https://www.phoenixcontact.com/us/products/1773352>



Classifications

ECLASS

ECLASS-11.0	27440205
ECLASS-13.0	27440223

HC-HV 6-ESTS - Contact insert



1773352

<https://www.phoenixcontact.com/us/products/1773352>

Environmental product compliance

China RoHS	Environmentally Friendly Use Period = 50 years
	For information on hazardous substances, refer to the manufacturer's declaration available under "Downloads"

HC-HV 6-ESTS - Contact insert

1773352

<https://www.phoenixcontact.com/us/products/1773352>



Accessories

HC-B-3PE - PE multiplier

1644326

<https://www.phoenixcontact.com/us/products/1644326>

PE multiplier, for 3 PE connections, for HC-B / HC-BB / HC-DD / HC-D40 / HC-D64 contact inserts



Phoenix Contact 2023 © - all rights reserved
<https://www.phoenixcontact.com>

Phoenix Contact USA
586 Fulling Mill Road
Middletown, PA 17057, United States
(+717) 944-1300
info@phoenixcon.com