

HC-B 24-AFQD - Housing

1771956

<https://www.phoenixcontact.com/us/products/1771956>



Please be informed that the data shown in this PDF document is generated from our online catalog. Please find the complete data in the user documentation. Our general terms of use for downloads are valid.



HEAVYCON B24 panel mounting base, for double locking latch, height: 29 mm, with plastic cover, with flat gasket

Commercial data

Item number	1771956
Packing unit	1 pc
Minimum order quantity	10 pc
Note	Made to order (non-returnable)
Sales key	BF55
Product key	BF7AAC
Catalog page	Page 538 (C-4-2013)
GTIN	4017918036638
Weight per piece (including packing)	157.82 g
Weight per piece (excluding packing)	157.26 g
Customs tariff number	85389099
Country of origin	DE

HC-B 24-AFQD - Housing

1771956

<https://www.phoenixcontact.com/us/products/1771956>



Technical data

Notes

General	For contact inserts HC-B24, BB46, BBB64, D64, DD108, M
---------	--

Product properties

Type	B24
Product type	Housing with locking latch
Application	Standard
Housing type	Panel mounting base
Protective cover	yes
Shielded	no
Pg screw connection	none

Dimensions

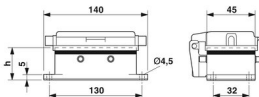
Dimensional drawing	
Width	43 mm
Height	29 mm
Length	140 mm

Installation dimensions

Width of the assembly cutout	35 mm
Length of the assembly cutout	113 mm

Material specifications

Seal material	NBR
	CR
Housing surface material	Powder-coated, gray
Material, protective cover	PA
Housing material	die-cast aluminum

Mechanical properties

Mechanical data

Locking type	Pin
--------------	-----

Environmental and real-life conditions

Ambient conditions

Degree of protection	IP65 (When plugged in)
Ambient temperature (operation)	-40 °C ... 125 °C

HC-B 24-AFQD - Housing

1771956

<https://www.phoenixcontact.com/us/products/1771956>



Drawings

Dimensional drawing

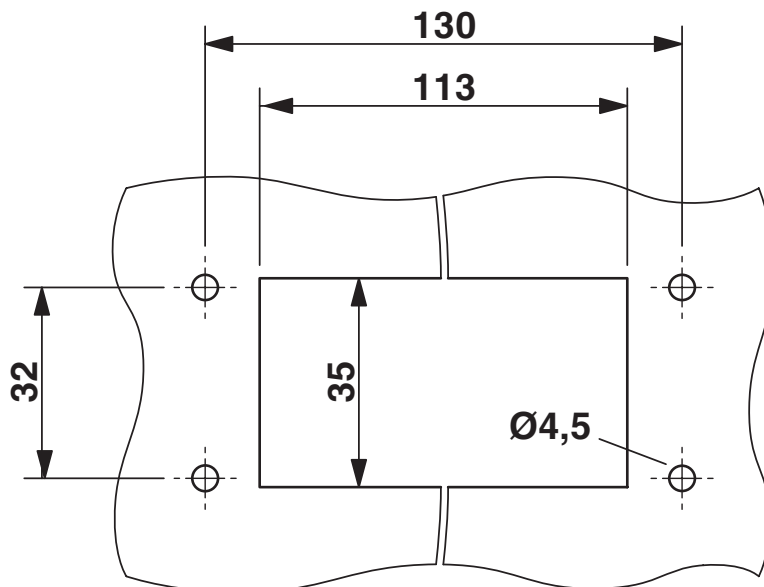

Mounting cutout

Dimensional drawing

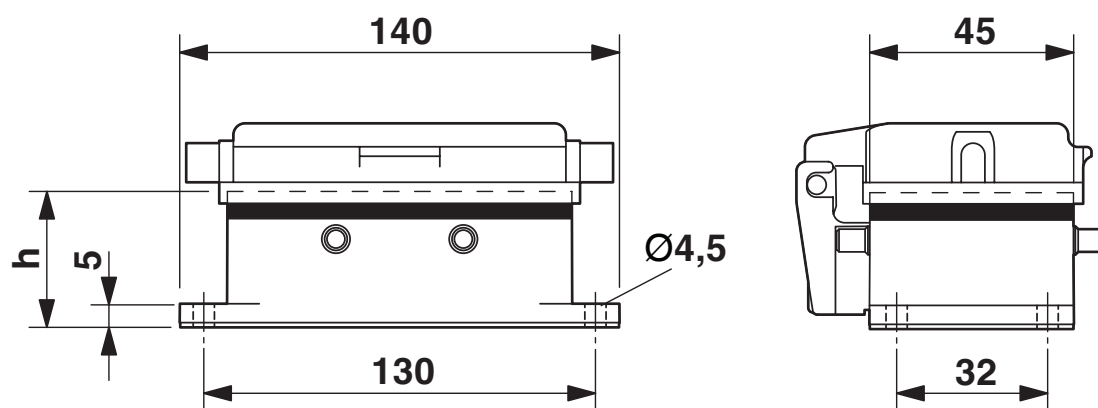

Dimensional drawing

HC-B 24-AFQD - Housing

1771956

<https://www.phoenixcontact.com/us/products/1771956>



Classifications

ECLASS

ECLASS-11.0	27440202
ECLASS-13.0	27440202

ETIM

ETIM 7.0	EC000437
----------	----------

UNSPSC

UNSPSC 21.0	31261501
-------------	----------

HC-B 24-AFQD - Housing

1771956
<https://www.phoenixcontact.com/us/products/1771956>



Environmental product compliance

China RoHS	Environmentally friendly use period: unlimited = EFUP-e
	No hazardous substances above threshold values

HC-B 24-AFQD - Housing

1771956

<https://www.phoenixcontact.com/us/products/1771956>



Accessories

HC-B 10-24-QB - Double locking latch

1637265

<https://www.phoenixcontact.com/us/products/1637265>



Replacement latch for HC-B10 / HC-B16/ HC-B24 housings with double locking latch (plastic design)

HC-B 24-PR-DI - Profile gasket

1663048

<https://www.phoenixcontact.com/us/products/1663048>



Profile gasket for type B24 supporting base element

HC-B 24-AFQD - Housing

1771956

<https://www.phoenixcontact.com/us/products/1771956>



HC-B 24-FL-DI-N - Seal

1411465

<https://www.phoenixcontact.com/us/products/1411465>



Replacement flange seal, for HEAVYCON type B24 panel mounting base, latching, for panel mounting base with snapped-on flat gaskets, not for HC-.... EMV housing, color: black

HC-B 24-FL-DI - Flat gasket

1774665

<https://www.phoenixcontact.com/us/products/1774665>



Replacement flange seal, for HEAVYCON panel mounting base of type: B24, self-adhesive, not for HC-...EMC housings, color: Black

HC-B 24-AFQD - Housing

1771956

<https://www.phoenixcontact.com/us/products/1771956>



HC-B/D-ERSLABO-SD-KU - Bearing block

1408070

<https://www.phoenixcontact.com/us/products/1408070>

Spare bearing block for series B/D housing with plastic protective cover; consisting of bearing block, plate and two screws



Phoenix Contact 2023 © - all rights reserved

<https://www.phoenixcontact.com>

Phoenix Contact USA
586 Fulling Mill Road
Middletown, PA 17057, United States
(+717) 944-1300
info@phoenixcon.com