

HC-B 16-EBUS - Contact insert



1771464

<https://www.phoenixcontact.com/us/products/1771464>

Please be informed that the data shown in this PDF document is generated from our online catalog. Please find the complete data in the user documentation. Our general terms of use for downloads are valid.

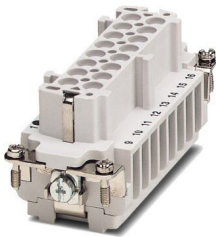

HEAVYCON female insert, B16 series, 16-pos., screw connection

Commercial data

Item number	1771464
Packing unit	1 pc
Minimum order quantity	1 pc
Note	Made to order (non-returnable)
Sales key	BF61
Product key	BF7ABC
Catalog page	Page 345 (PC-2007)
GTIN	4017918036195
Weight per piece (including packing)	115.4 g
Weight per piece (excluding packing)	105.9 g
Customs tariff number	85366990
Country of origin	DE

HC-B 16-EBUS - Contact insert



1771464

<https://www.phoenixcontact.com/us/products/1771464>

Technical data

Notes

General	For housing HC-B16
---------	--------------------

Mounting

Assembly instructions	For housings of type B16/B32. Connectors may only be actuated when there is no load/voltage.
-----------------------	--

Product properties

Type	B16
Product type	Contact insert with a fixed no. of positions
Number of positions	16
Connection profile	16+PE
No. of power contacts	16
Series	HC-B

Insulation characteristics

Overvoltage category	III
Degree of pollution	3

Dimensions

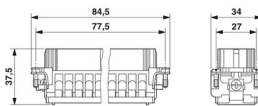
Dimensional drawing	
Width	34 mm
Height	37.5 mm
Length	84.5 mm

Connection data

Connection technology

Connection technology	Screw connection
Connection in acc. with standard	IEC / EN

Conductor connection

Conductor cross section	0.5 mm ² ... 2.5 mm ² (applies to stranded conductors with ferrules)
	0.5 mm ² ... 4 mm ² (PE screw)
Connection cross section AWG	20 ... 14
	20 ... 12 (PE screw)
Tightening torque	0.5 Nm
Stripping length of the individual wire	7 mm

Electrical properties

HC-B 16-EBUS - Contact insert



1771464

<https://www.phoenixcontact.com/us/products/1771464>

Rated voltage (III/3)	500 V
Rated surge voltage	6 kV
Rated current	16 A

Mechanical properties

Mechanical data

Insertion/withdrawal cycles	≥ 500
-----------------------------	-------

Material specifications

Flammability rating according to UL 94	V0
Contact material	Copper alloy
Contact surface material	Ag
Contact carrier material	PA

Environmental and real-life conditions

Ambient conditions

Ambient temperature (operation)	-40 °C ... 125 °C (including heating up of contacts)
---------------------------------	--

Standards and regulations

Constructional and testing regulations	DIN VDE 0627/86
	DIN VDE 0110/02.79
	DIN VDE 0110-1/04.97
	IEC 60664-1, DIN IEC 60512
	IEC 60352
Tests	DIN VDE 0627/86
	DIN VDE 0110/02.79
	DIN VDE 0110-1/04.97
	IEC 60664-1, DIN IEC 60512
	IEC 60352

HC-B 16-EBUS - Contact insert

1771464

<https://www.phoenixcontact.com/us/products/1771464>



Drawings

Dimensional drawing

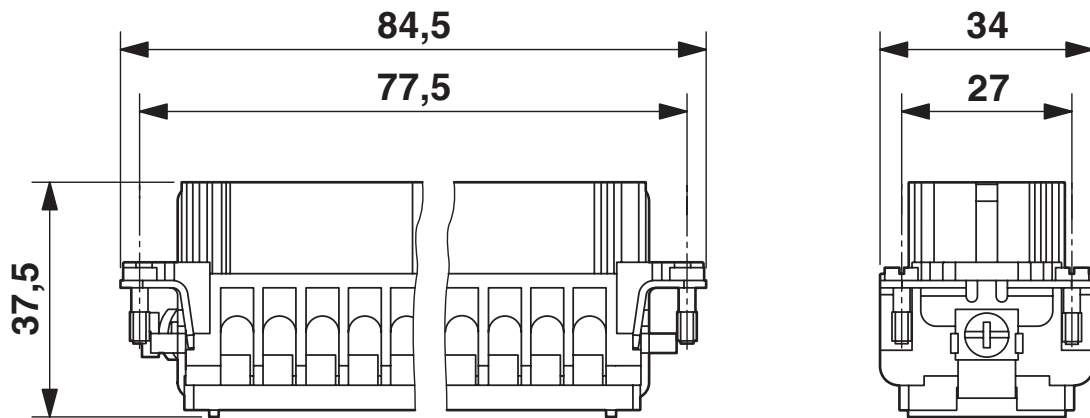

Female insert

HC-B 16-EBUS - Contact insert

1771464

<https://www.phoenixcontact.com/us/products/1771464>



Schematic diagram

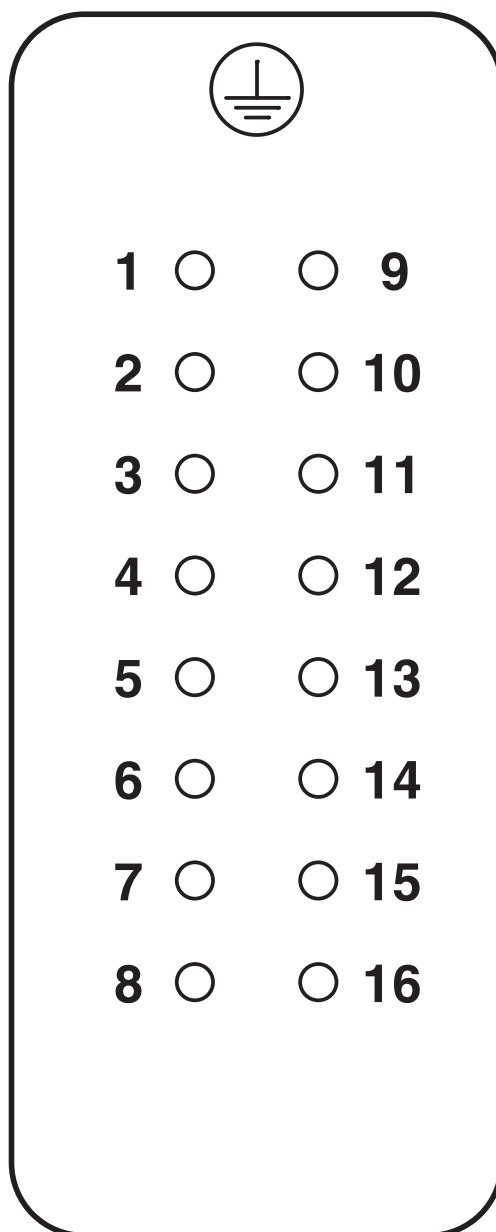

Connector pin assignment, connection side

HC-B 16-EBUS - Contact insert

1771464

<https://www.phoenixcontact.com/us/products/1771464>

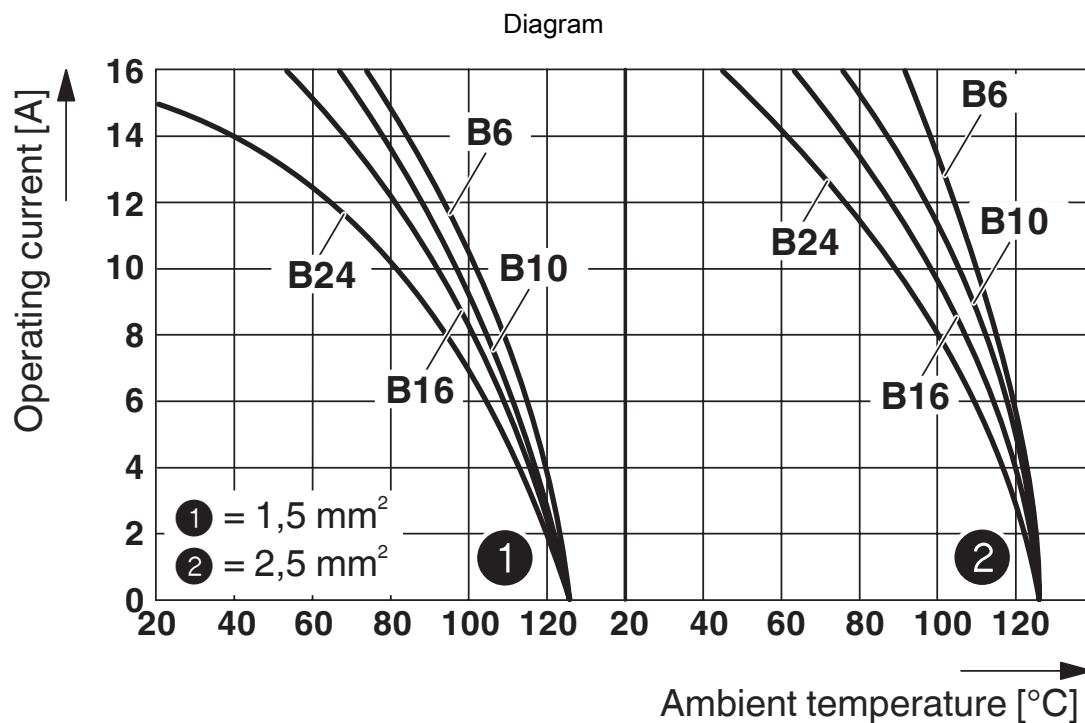

Derating diagram: Series HC-B...S / HC-B...C

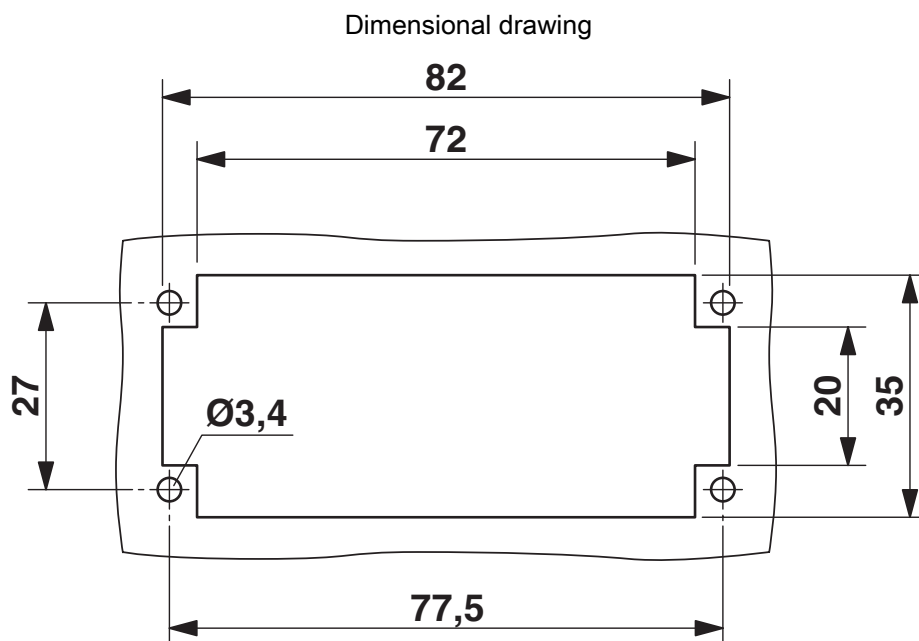

Mounting cutout

HC-B 16-EBUS - Contact insert



1771464

<https://www.phoenixcontact.com/us/products/1771464>

Classifications

ECLASS

ECLASS-11.0	27440205
ECLASS-13.0	27440223

HC-B 16-EBUS - Contact insert



1771464

<https://www.phoenixcontact.com/us/products/1771464>

Environmental product compliance

China RoHS	Environmentally friendly use period: unlimited = EFUP-e
	No hazardous substances above threshold values

HC-B 16-EBUS - Contact insert



1771464

<https://www.phoenixcontact.com/us/products/1771464>

Accessories

HC-B-PES - Screw

1604997

<https://www.phoenixcontact.com/us/products/1604997>

PE screw, for contact inserts HC-B / HC-BB / HC-DD / HC-D40 / HC-D64



HC-CST - Coding element

1676857

<https://www.phoenixcontact.com/us/products/1676857>

Coding peg for coding up to 16 connectors



HC-B 16-EBUS - Contact insert

1771464

<https://www.phoenixcontact.com/us/products/1771464>



HC-CBU - Coding element

1676860

<https://www.phoenixcontact.com/us/products/1676860>



Coding socket for coding up to 16 connectors

HC-CB - Coding bolt

1772722

<https://www.phoenixcontact.com/us/products/1772722>



Coding pin, prevents mismatching of up to six connectors with an identical number of positions

HC-B 16-EBUS - Contact insert

1771464

<https://www.phoenixcontact.com/us/products/1771464>



HC-B-3PE - PE multiplier

1644326

<https://www.phoenixcontact.com/us/products/1644326>

PE multiplier, for 3 PE connections, for HC-B / HC-BB / HC-DD / HC-D40 / HC-D64 contact inserts



HC-B-ZG - Strain relief clamp

1685327

<https://www.phoenixcontact.com/us/products/1685327>

Strain relief clamps contact inserts of series: B-, BB-, D 40, D 64, DD and HV, straight cable exit

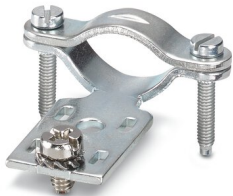

HC-B 16-EBUS - Contact insert

1771464

<https://www.phoenixcontact.com/us/products/1771464>



HC-B-ZS - Strain relief clamp

1685330

<https://www.phoenixcontact.com/us/products/1685330>



Strain relief clamps contact inserts of series: B-, BB-, D 40, D 64, DD and HV, lateral cable exit

HC-SMR-B16 - DIN rail mounting frame

1687972

<https://www.phoenixcontact.com/us/products/1687972>



HEAVYCON DIN rail mounting frame, for contact inserts of type B16

Phoenix Contact 2023 © - all rights reserved
<https://www.phoenixcontact.com>

Phoenix Contact USA
586 Fulling Mill Road
Middletown, PA 17057, United States
(+717) 944-1300
info@phoenixcon.com