

# SACC-BP-F-M12/M15-6-SMD SCO - Housing screw connection



1414023

<https://www.phoenixcontact.com/us/products/1414023>

Please be informed that the data shown in this PDF document is generated from our online catalog. Please find the complete data in the user documentation. Our general terms of use for downloads are valid.



Housing screw connection, Socket, M12-SPEEDCON, Rear mounting, M15 x 1, Alternative product in accordance with RoHS II without Exemption 6c (Pb <0.1%) item no.: 1239059

## Your advantages

- Reduced mounting costs thanks to two-piece device connector
- Easy device integration, thanks to mechanical port screw connections with threaded fastening
- Efficient PCB assembly: two-piece connectors for SMT soldering
- SPEEDCON fast locking system reduces cabling times

## Commercial data

|                                      |               |
|--------------------------------------|---------------|
| Item number                          | 1414023       |
| Packing unit                         | 1 pc          |
| Minimum order quantity               | 20 pc         |
| Sales key                            | AB23          |
| Product key                          | ABQBFC        |
| GTIN                                 | 4055626022659 |
| Weight per piece (including packing) | 8.85 g        |
| Weight per piece (excluding packing) | 8.85 g        |
| Customs tariff number                | 79070000      |
| Country of origin                    | DE            |

# SACC-BP-F-M12/M15-6-SMD SCO - Housing screw connection



1414023

<https://www.phoenixcontact.com/us/products/1414023>

## Technical data

### Notes

|         |  |
|---------|--|
| General | The electrical and mechanical data specified assume that the connector pair is correctly locked and mounted. If the connector is unlocked and if there is a danger of contamination, the connector must be sealed using a protective cap > IP54. Influences arising from litz wires, cables or PCB assembly must also be taken into consideration. |
| General | Lock nut is included in the scope of delivery  |

### Product properties

|              |                     |
|--------------|---------------------|
| Product type | Panel mounting base |
| Thread type  | M12                 |

### Material specifications

|                               |                               |
|-------------------------------|-------------------------------|
| Material                      | Brass, nickel-plated          |
| Material                      | Zinc die-cast (nickel-plated) |
| Seal material                 | FKM                           |
|                               | FKM                           |
| Material for screw connection | Zinc die-cast, nickel-plated  |

### Connector

#### Connection 1

|                   |          |
|-------------------|----------|
| Head design       | Socket   |
| Head thread type  | M12      |
| Head locking type | SPEEDCON |

### Mechanical properties

#### Mechanical data

|                             |       |
|-----------------------------|-------|
| Insertion/withdrawal cycles | > 100 |
|-----------------------------|-------|

### Environmental and real-life conditions

#### Ambient conditions

|  |   |
|--|---|
| Degree of protection (when plugged in) | IP67 (correctly plugged in and locked)          |
| Degree of protection                   | IP67 (correctly plugged in and locked)          |
|  | IP67, when in locked state                      |
| Ambient temperature (operation)        | -25 °C ... 85 °C (Plug / socket)                |
|  | -40 °C ... 85 °C (without mechanical actuation) |

### Standards and regulations

M12

# SACC-BP-F-M12/M15-6-SMD SCO - Housing screw connection



1414023

<https://www.phoenixcontact.com/us/products/1414023>

|                          |                 |
|--------------------------|-----------------|
| Standard designation     | M12 connector   |
| Standards/specifications | IEC 61076-2-101 |
| Note                     | In line with    |

## Mounting

|                       |   |
|-----------------------|---|
| Mounting type         | Rear mounting M15 x 1 Spacing between the top edge of the PCB and the back of the front plate: 6 mm |
| Assembly instructions | Spacing between the top edge of the PCB and the back of the front plate: 6 mm                       |

# SACC-BP-F-M12/M15-6-SMD SCO - Housing screw connection



1414023

<https://www.phoenixcontact.com/us/products/1414023>

## Drawings

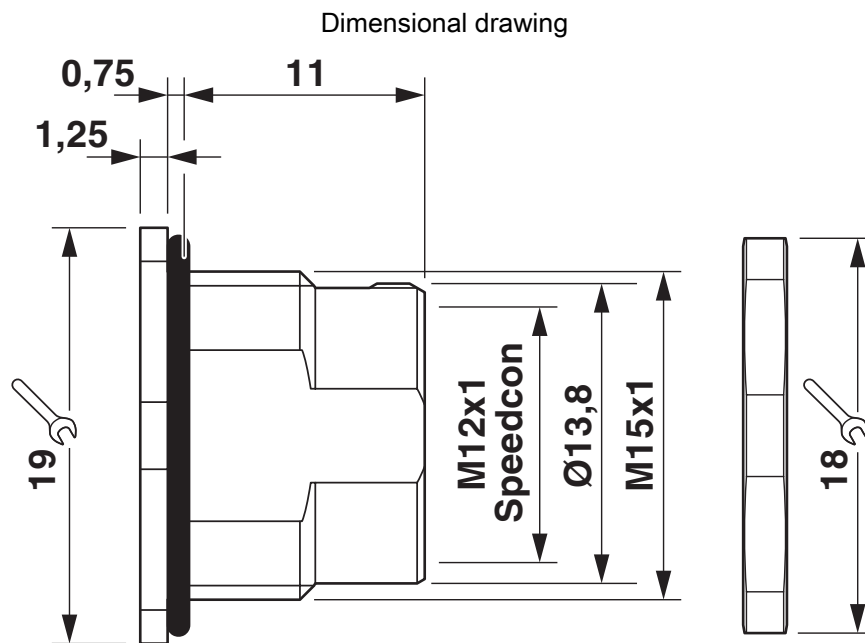

Dimensional drawing

# SACC-BP-F-M12/M15-6-SMD SCO - Housing screw connection



1414023

<https://www.phoenixcontact.com/us/products/1414023>

## Approvals

📄 To download certificates, visit the product detail page: <https://www.phoenixcontact.com/us/products/1414023>



**EAC**

Approval ID: B.01687

# SACC-BP-F-M12/M15-6-SMD SCO - Housing screw connection



1414023

<https://www.phoenixcontact.com/us/products/1414023>

## Classifications

### ECLASS

|             |          |
|-------------|----------|
| ECLASS-11.0 | 27440224 |
| ECLASS-13.0 | 27440224 |
| ECLASS-12.0 | 27440224 |

### UNSPSC

|             |          |
|-------------|----------|
| UNSPSC 21.0 | 31171600 |
|-------------|----------|

# SACC-BP-F-M12/M15-6-SMD SCO - Housing screw connection



1414023

<https://www.phoenixcontact.com/us/products/1414023>

## Environmental product compliance

|            |  |
|------------|--|
| REACH SVHC | Lead 7439-92-1   |
| China RoHS | Environmentally Friendly Use Period = 50 years   |
|            | For information on hazardous substances, refer to the manufacturer's declaration available under "Downloads" |

Phoenix Contact 2023 © - all rights reserved  
<https://www.phoenixcontact.com>

Phoenix Contact USA  
586 Fulling Mill Road  
Middletown, PA 17057, United States  
(+717) 944-1300  
[info@phoenixcon.com](mailto:info@phoenixcon.com)