

- NOTES:
1. MATERIALS: "G" STYLE
    - 1.1 SHELL, FERRULE  
BRASS PER QQ-B-626  
FINISH: GOLD, OVER  
ELECTROLESS NICKEL  
PER MIL-G-45204, TYP 2, CLASS 1
    - 1.2 INSERT  
PEEK, GLASS FILLED PER  
MIL-P-46183
    - 1.3 CONTACTS  
COPPER ALLOY  
FINISH: GOLD PER MIL-G-45204
    - 1.4 GASKETS  
SILICONE RUBBER PER AMS 3304
    - 1.5 ALTERNATE SHELL MATERIALS  
AND FINISHES:  
"M" STYLE: BRASS, WITH  
ELECTROLESS NICKEL FINISH  
PER AMS-C-26074, CLASS 4, GRADE B  
"A" STYLE: BRASS, WITH GOLD PLATE,  
BLACK CHROMATE  
"K" STYLE: STAINLESS STEEL,  
300 SERIES, WITH PASSIVATION

REVISION HISTORY		
REVISION	DATE	COMMENT
0	02 /10 / 17	INITIAL RELEASE
A	07/01/20	DIM CHANGES

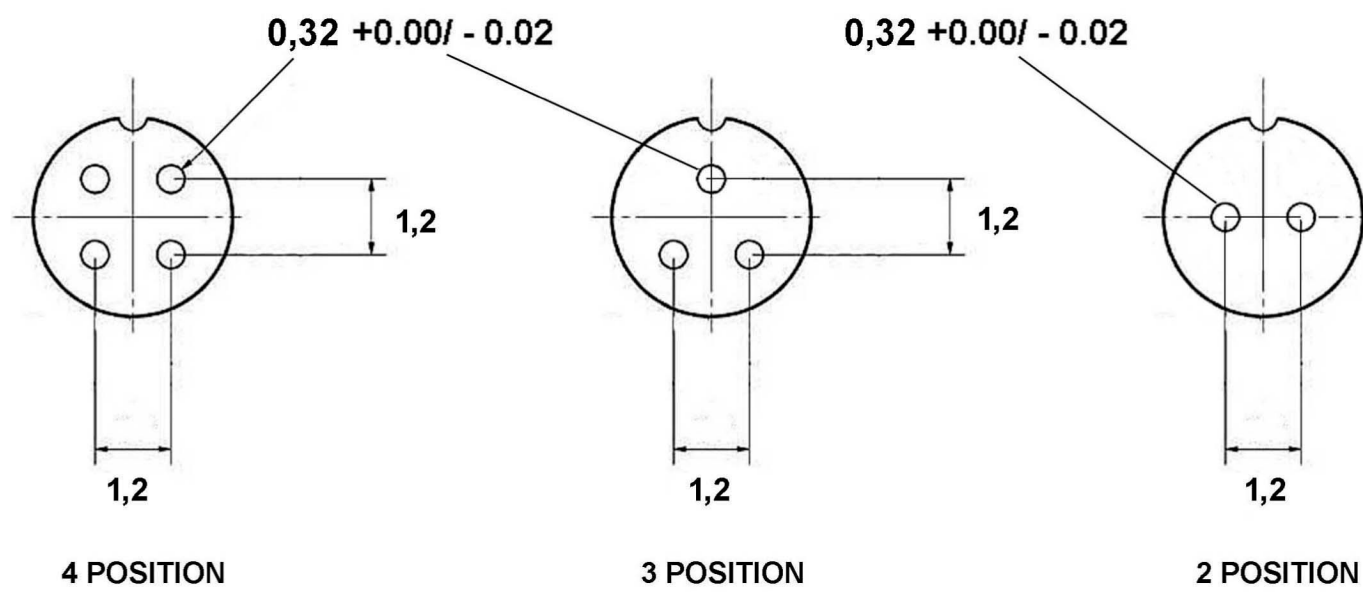
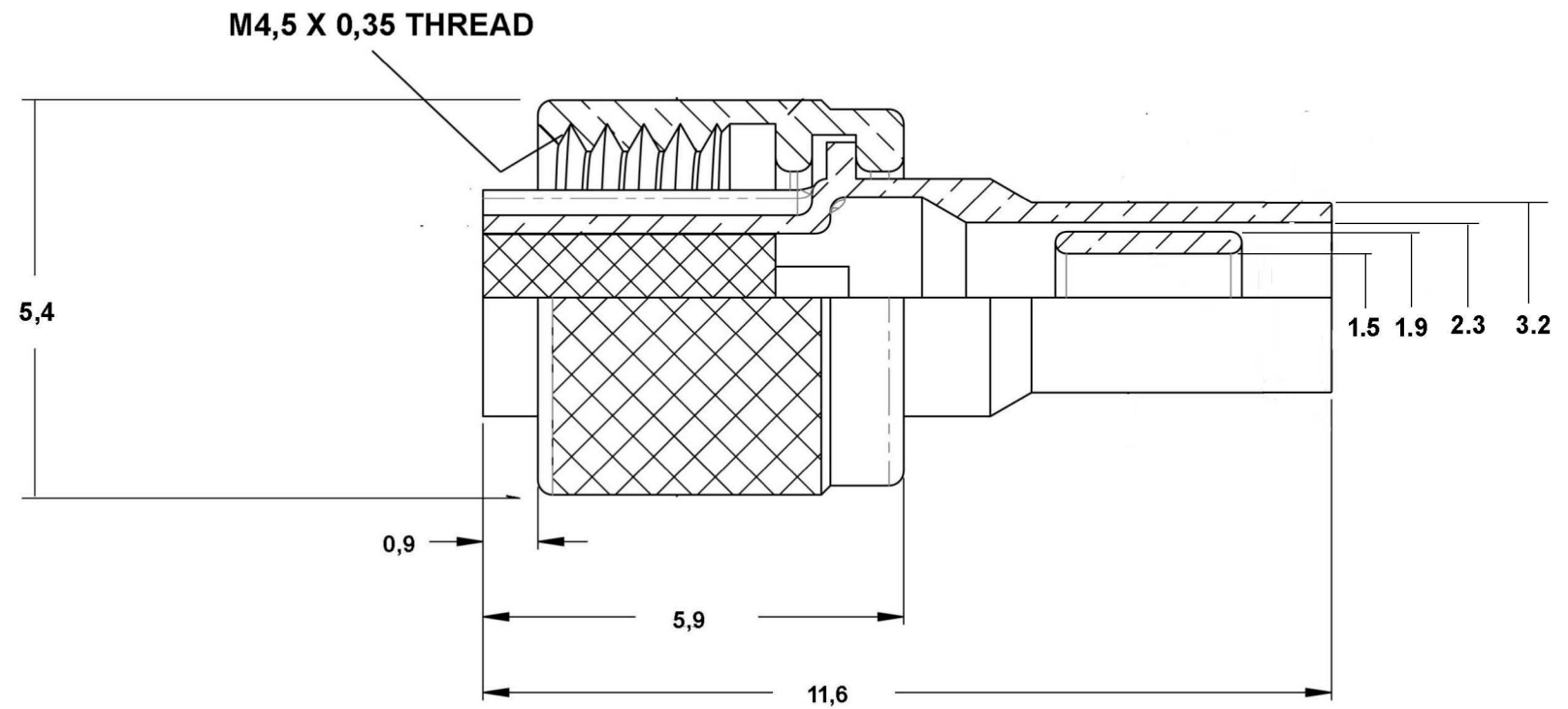

SAMPLE PN: MSWU-G-B-04S

UNLESS OTHERWISE NOTED: DIMENSIONS ARE IN MILLIMETERS DO NOT SCALE THIS DRAWING  .X DECIMALS ARE ±0.5 .XX DECIMALS ARE ±0.25 .XXX DECIMALS ARE ±0.13  ANGLES ARE ±0.5°	DRAWING	SC	MILSPECWEST - MICRO PRODUCTS <b>CAGE CODE: 3HD49</b>	
	CHECKED	TS	DESCRIPTION: <b>ULTRA PLUG CONNECTOR</b>	
	Q.A.	KB	DWG. NO. <b>MSWU - * - B - 0 * S</b>	REVISION: <b>A</b> SHEET 1

THIS DOCUMENT IS SOLE PROPERTY OF MILSPECWEST AND IS ISSUED IN STRICT CONFIDENCE THAT IT WILL NOT BE REPRODUCED IN ANY WAY OR USED TO SOLICIT BUSINESS OF A COMPETITIVE NATURE. DISTRIBUTION OF THIS DOCUMENT IS PROHIBITED UNLESS WRITTEN CONSENT IS OBTAINED FROM MILSPECWEST. THIS DOCUMENT IS SUITABLE FOR ENGINEERING EVALUATION AND MAY BE USED IN TECHNICAL SPECIFICATIONS.