

Mechanical Dimensions: Inches [mm]

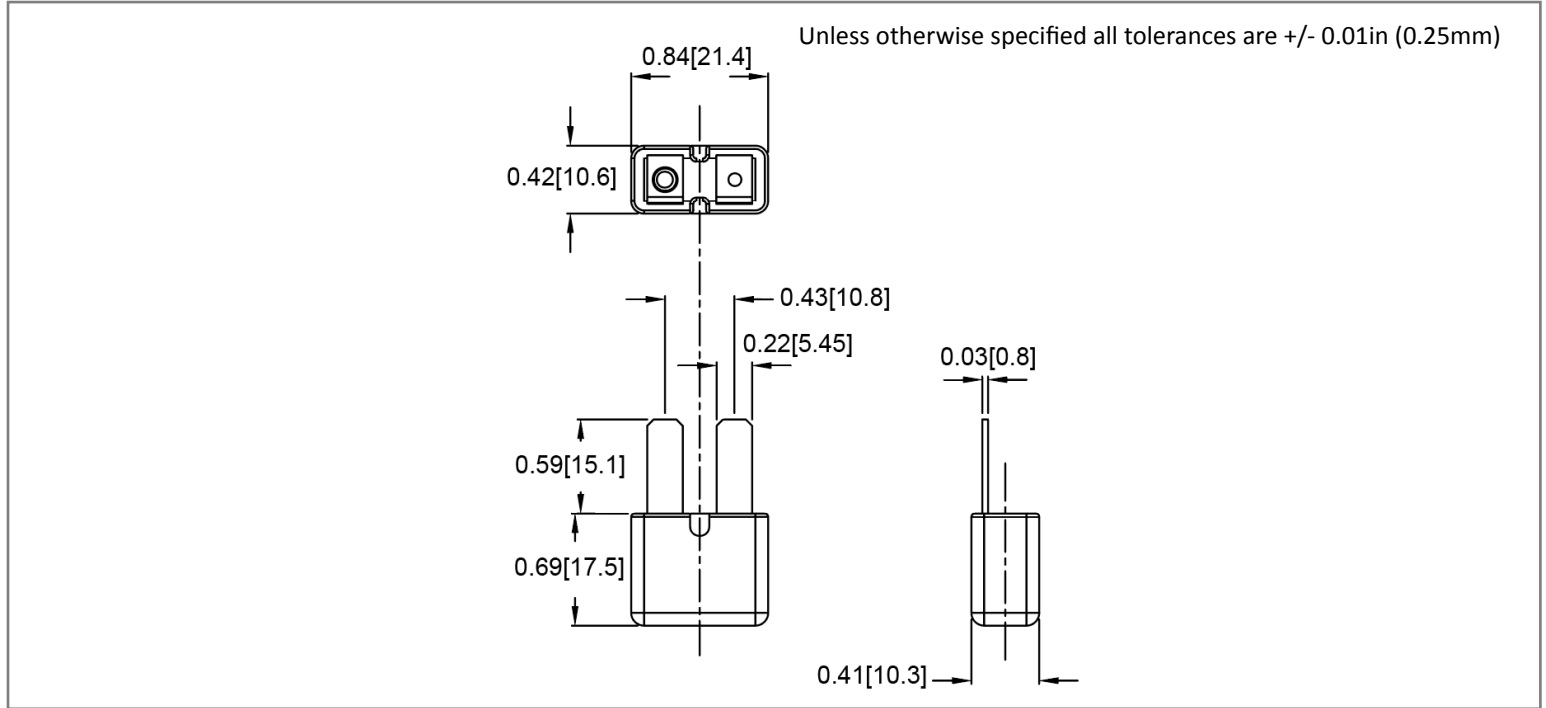

Part Numbers Information

| Optifuse P/N | Amperage |
|--------------|----------|
| MOCB2-PL-10A | 10A |
| MOCB2-PL-15A | 15A |
| MOCB2-PL-20A | 20A |
| MOCB2-PL-25A | 25A |
| MOCB2-PL-30A | 30A |
| MOCB2-PL-40A | 40A |

Electrical Specifications

| | |
|------------------------------|--------------------------|
| Voltage Rating | 12VDC |
| Reset Type | Type II - Modified Reset |
| Operation Temperature | -40°C ~ 85°C |
| Testing | SAE J553 Type II |

Material Specifications

| | |
|---------------------------------|--------------|
| Universal Style Circuit Breaker | |
| Body Material | Plated Steel |

Interrupt Rating

| % Ampere Rated | Ampere Rating | Opening Time |
|-----------------------|----------------------|---------------------|
| 100% | 6~40Amp | 60 mins Min. |
| 135% | 6~40Amp | 60 mins Max. |
| 200% | 6~40Amp | 1 min Max. |

| Rev | Date of issue | Revision Notes | Designed | Approved |
|------------|----------------------|-----------------------|-----------------|-----------------|
| B | 09-15-2023 | updated format | RC | OF |