

## Mechanical Dimensions: Inches [mm]

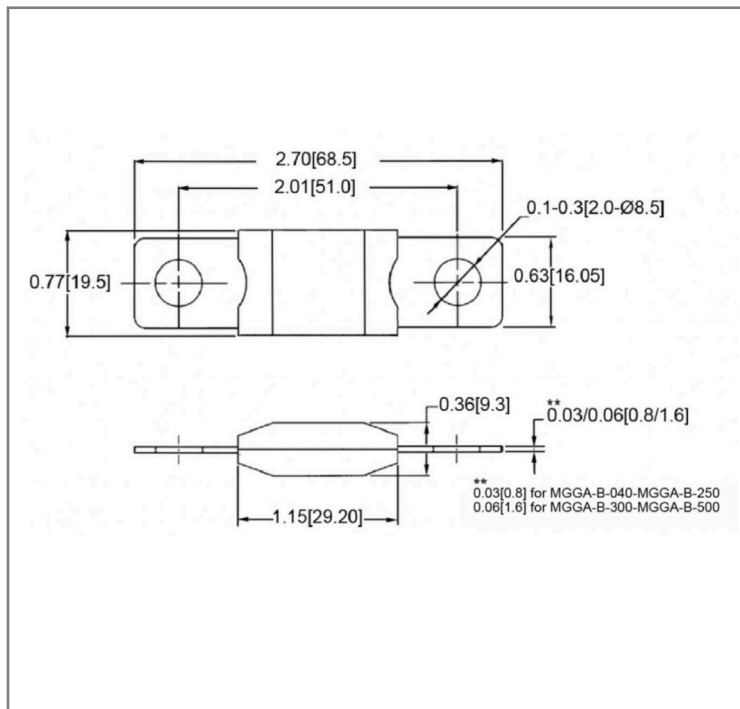

## Retail Pack: Inches [mm]

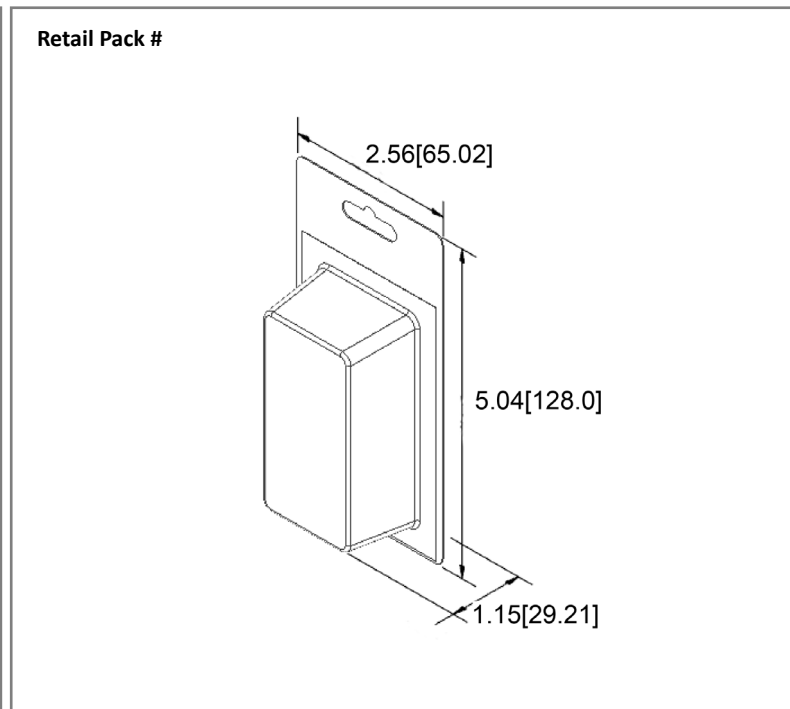

## Part Numbers Information

| Amperage | Bulk Part # | Retail Pack # Blister Card | Pack Size |
|----------|-------------|----------------------------|-----------|
| 40A      | MGGA-40A-B  | -                          | -         |
| 50A      | MGGA-50A-B  | -                          | -         |
| 60A      | MGGA-60A-B  | -                          | -         |
| 70A      | MGGA-70A-B  | -                          | -         |
| 80A      | MGGA-80A-B  | MGGA-80A-BP                | 1         |
| 90A      | MGGA-90A-B  | -                          | -         |
| 100A     | MGGA-100A-B | MGGA-100A-BP               | 1         |
| 125A     | MGGA-125A-B | MGGA-125A-BP               | 1         |
| 150A     | MGGA-150A-B | MGGA-150A-BP               | 1         |
| 175A     | MGGA-175A-B | MGGA-175A-BP               | 1         |
| 200A     | MGGA-200A-B | MGGA-200A-BP               | 1         |
| 225A     | MGGA-225A-B | MGGA-225A-BP               | 1         |
| 250A     | MGGA-250A-B | MGGA-250A-BP               | 1         |
| 300A     | MGGA-300A-B | MGGA-300A-BP               | 1         |
| 400A     | MGGA-400A-B | -                          | -         |

## Electrical Specifications

|                       |               |
|-----------------------|---------------|
| Voltage Rating        | 32VDC         |
| Interrupting Rating   | 2000A@32VDC   |
| Operation Temperature | -20°C ~ 125°C |
| Testing               | ISO 8820-5    |

## Material Specifications

|            |                                  |
|------------|----------------------------------|
| Body       | Nylon 66 UL94V0 with glass fiber |
| Body Color | Black                            |
| Terminals  | Copper with tin plated           |

## Time vs. Percent of Rated Current

| % of Rated Current | Current Rating | Min Hold Time | Max Hold Time |
|--------------------|----------------|---------------|---------------|
| 75%                | 40A~250A       | -             | -             |
|                    | 300A~500A      | 1h            | -             |
| 100%               | 40A~250A       | 1h            | -             |
|                    | 300A~500A      | -             | -             |
| 135%               | 40A~250A       | 120s          | 1800s         |
|                    | 300A~500A      | -             | -             |
| 200%               | 40A~250A       | 1s            | 15s           |
|                    | 300A~500A      | 1s            | 15s           |
| 350%               | 40A~250A       | 300ms         | 5s            |
|                    | 300A~500A      | 500ms         | 5s            |

| Rev | Date of issue | Revision Notes              | Designed | Approved |
|-----|---------------|-----------------------------|----------|----------|
| D   | 09-07-2023    | added specific SAE standard | RC       | OF       |